

Publication 674
April 2011
Part No. 22674.74
Revision: 15.07.15

REVOLUTION

PROPORTIONAL CONTROLS



Operator's Handbook

For use in conjunction with machine specific operation manuals





For Safety and Performance ...

ALWAYS READ THIS BOOK FIRST

McCONEl LIMITED

Temeside Works

Ludlow

Shropshire

England

Telephone: 01584 873131

www.mcconnell.com

INDEX

Identification of Controls	1
Kennzeichnung der Steuerung	1
Identificatie van Controle	1
Identification de Commande	1
Identifikation af Kontrol	1
Identificación del Control	1
Software Version & Menus	2
Software Version und Menüs	2
Softwareversie en Menu's	2
Version du logiciel et des menus	2
Softwareversion og menuer	2
Versión del software y de los menús	2
Power On/Off	3
Leistung Ein/Aus	3
Belasting Aan/Uit	3
Puissance En Marche/Arret	3
Magt On/Off	3
Potencia Comenzar/Apagar	3
Joystick Operation and Default Switch Functions	4
Joystick Betrieb und Rückstellungs-Schalter-Funktionen	4
Joystick Verrichting en Functies de Standaard van de Schakelaar	4
Joystick Opération et Fonctions de Commutateur de Défaut	4
Joystick Drift og Misligholdelse Skifte Funktioner	4
Joystick Operación y Funciones de Interruptor del Defecto	4
Rotor On/Off	5
Rotor Ein/Aus	5
Rotor Aan/Uit	5
Rotor En Marche/Arret	5
Rotor On/Off	5
Rotor Comenzar/Apagar	5
Job Total Reset	6
Auftragstunden Zurückstellen	6
Werksteller Reset	6
Heures Totales Remis a Zero	6
Klipptimer Tot Reset	6
Horas Totales Reiniciar	6
Slew Operation	7
Arm Schwenken Betrieb	7
Arm Zwenken	7
Balayage Opération	7
Slew Drift	7
Giro Operación	7
Slew-Tele Swap Function	7
Schwenk/Tele. Wechsel Funktion	7
Zwenk/Tele. Wissel Functie	7
Inversion Balayage/Telescopique Fonction	7
Sving Væksel Funktion	7
Giro/Telescopico Intercambio Función	7

Auto-Reset	8
Anfahrautomatik	8
Actieve Aanrijbeveiliging	8
Retour Auto	8
Autoreset	8
Reinilizacion Auto	8
Angle Float	8
Kopf Drehenschwimmstellung	8
Kop Draaien Zweefstand	8
Angle Flotaison	8
Flyd Vinkel Slaglehoved	8
Angulo Flotante	8
Lift Float, EDS & EDS Pro	9
Schwimmstellung Arm, EDS & EDS Pro	9
Zweefstand Arm, EDS & EDS Pro	9
Flotaison Levee, EDS & EDS Pro	9
Flyd Arm, EDS & EDS Pro	9
Elevacion Flotante, EDS & EDS Pro	9
Diverters D1 / D2 / D3	10
Funktionwechsel D1 / D2 / D3	10
Functiewissel D1 / D2 / D3	10
Variante D1 / D2 / D3	10
Afledning D1 / D2 / D3	10
Desviador D1 / D2 / D3	10
Menu Screen and Work Screen	11
Menu Fenster und Arbeitsfenster	11
Menu Scherm en Werk Scherm	11
Ecran Menu et Ecran de Travail	11
Menukort Screen og Arbejde Screen	11
Pantalla de Menú y Pantalla del Trabajo	11
Joystick Status Screen	12
Joystick Status Fenster	12
Joystick Status Scherm	12
Joystick Statut Ecran	12
Joystick Status Screen	12
Joystick Pantalla de Estado	12
Language Selection Screen	13
Sprachvorwähler-Schirm	13
Het Scherm van de Selectie van de Taal	13
Écran de Choix de Langue	13
Sprog Udvælgelse Screen	13
Pantalla de la Selección de la Lengua	13
Menu Access and Settings	14
Menü-Zugang und Einstellungen	14
De Toegang en de Montages van Het Menu	14
Accès et Arrangements de Menu	14
Menu Adgang og Indstillinger	14
Acceso y Ajustes del Menú	14

Reach Swap	15
Auslage Wechsel	15
Reikwijdte Wissel	15
Portee Inversion	15
Rækkevidde Sving	15
Alcance Intercambio	15
Setting Reach Stop Positions	16
Einstellung Auslagebegrenzung	16
Opstelling Reikwijdte Begrenzing	16
Installation Arret Portee	16
Oprettelse Rækkevidde Stop	16
Disposición Parada De Alcance	16
Removing Reach Stop Positions	17
Entfernen Auslagebegrenzung	17
Het Verwijderen Reikwijdte Begrenzing	17
Élimination Arret Portee	17
Fjerne Rækkevidde Stop	17
Eliminación Parada De Alcance	17
Joystick Setup	18
Joystick Einstellungen	18
Joystick Instellingen	18
Installation Joystick	18
Joystick Oprettelse	18
Instalacion Joystick	18
Joystick Test/Calibrate	19
Joystick Probe/Kalibrierung	19
Joystick Test/Calibreren	19
Joystick Essai/Calibrez	19
Joystick Eksamination/Kalibrere	19
Joystick Prueba/Calibre	19
Valve Response Setting	20
Ventil-Einstellungen	20
Klep-instellingen	20
Paramètres de soupape	20
Ventil indstillinger	20
Configuración de la válvula	20
Valve 2 Selection & Activation	26
Ventil 2 Selection & Aktivierung	26
Valve 2 Selectie & Activering	26
Valve 2 de sélection et d'activation	26
Ventil 2 Selection & Aktivering	26
Válvula 2 Selección y activación	26
Warning Sound On/Off	27
Warntöne Ein/Aus	27
Waarschuwings Tonen Aan/Uit	27
Sons D'avertissement En Marche/Arret	27
Advarende Lyd On/Off	27
Sonido De Avertencia Comenzar/Apagar	27

Filter Timer Warnings & Reset (Initial Filter)	28
Filter Gebrauchzeiten Warnung (Anfangsfilter)	28
Filter Waarschuwing Reset Gebruiksduur (Aanvankelijke Filter)	28
Filtre Avertissement et Remise a Zero (Filtre initial)	28
Filteret Advarende og Filteret Reset (Foerste Filter)	28
Filtro Advertencia Reiniciar Tiempo Filtrante (Filtro Inicial)	28
Filter Timer Warnings & Reset (Replacement Filters)	29
Filter Gebrauchzeiten Warnung (Wiedereinbau-Filter)	29
Filter Waarschuwing Reset Gebruiksduur (Filter van de Vervanging)	29
Filtre Avertissement et Remise a Zero (Filtre de Rechange)	29
Filteret Advarende og Filteret Reset (Udskiftning filter)	29
Filtro Advertencia Reiniciar Tiempo Filtrante (Filtro del Reemplazo)	29
Disconnected Component Warnings	30
Bestandteile Angeschlossen Warnung	30
Componenten Aangesloten Waarschuwen	30
Avertissement de Composants Deconnecte	30
Afbrudt Komponenter Advarsel	30
Cuidado de los Components Desonecta	30
Speed Warning Screen	31
Über Drehzahl Warnung Fenster	31
Overtoeren Waarschuwen Scherm	31
Surregime Avertissement Ecran	31
Over Max. Hastighed Advarsel Screen	31
Sobre Velocidad Advertencia Pantalla	31
Power Warning Screen	31
Überbelastung Warnung Fenster	31
Overbelasting Waarschuwen Scherm	31
Surpuissance Avertissement Ecran	31
Overbelastning Advarsel Screen	31
Sobre Potencia Advertencia Pantalla	31
Language Translations	32
Sprachübersetzungen	32
De Vertalingen van de Taal	32
Traductions des Langues	32
Oversættelserne	32
Traducciones de lengua	32

REVOLUTION PROPORTIONAL CONTROL SYSTEM

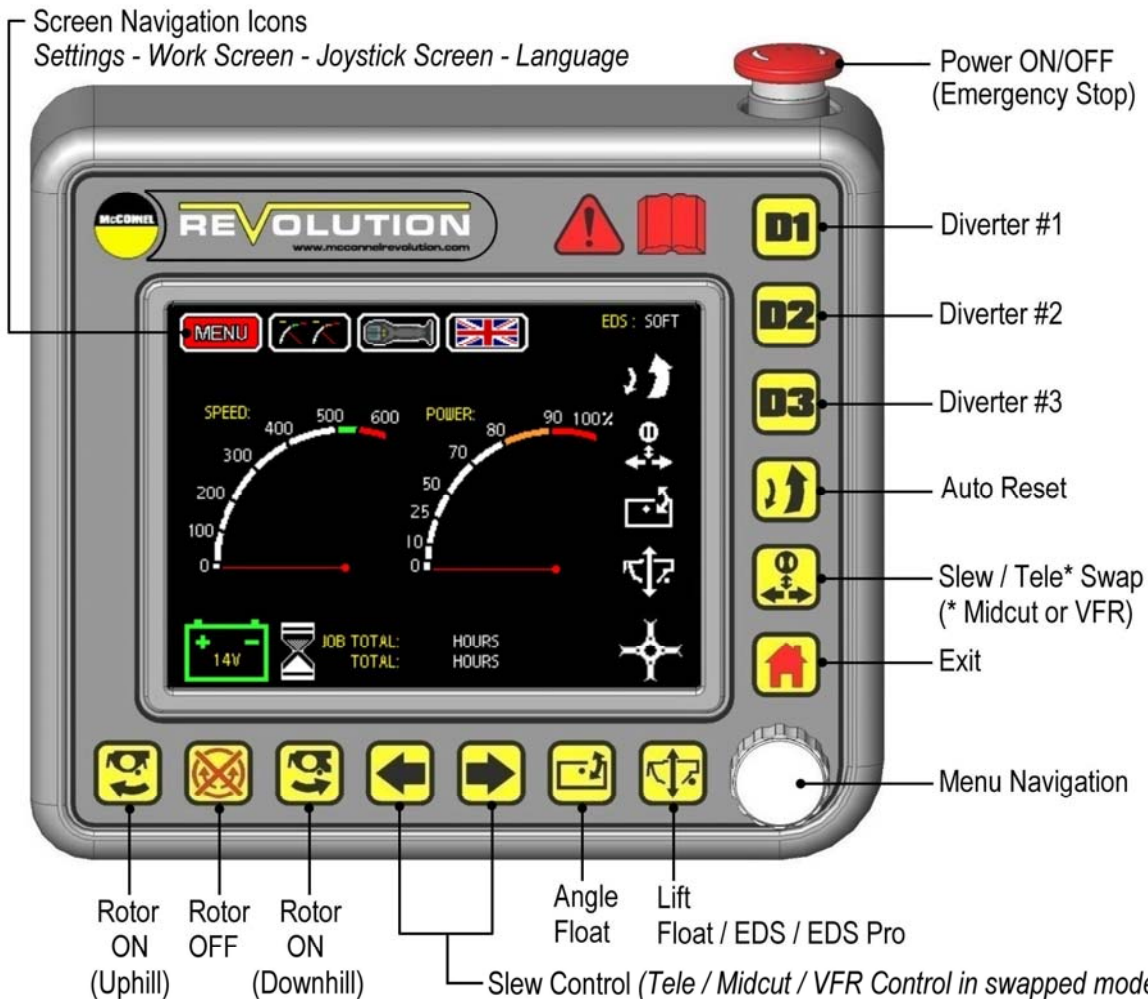
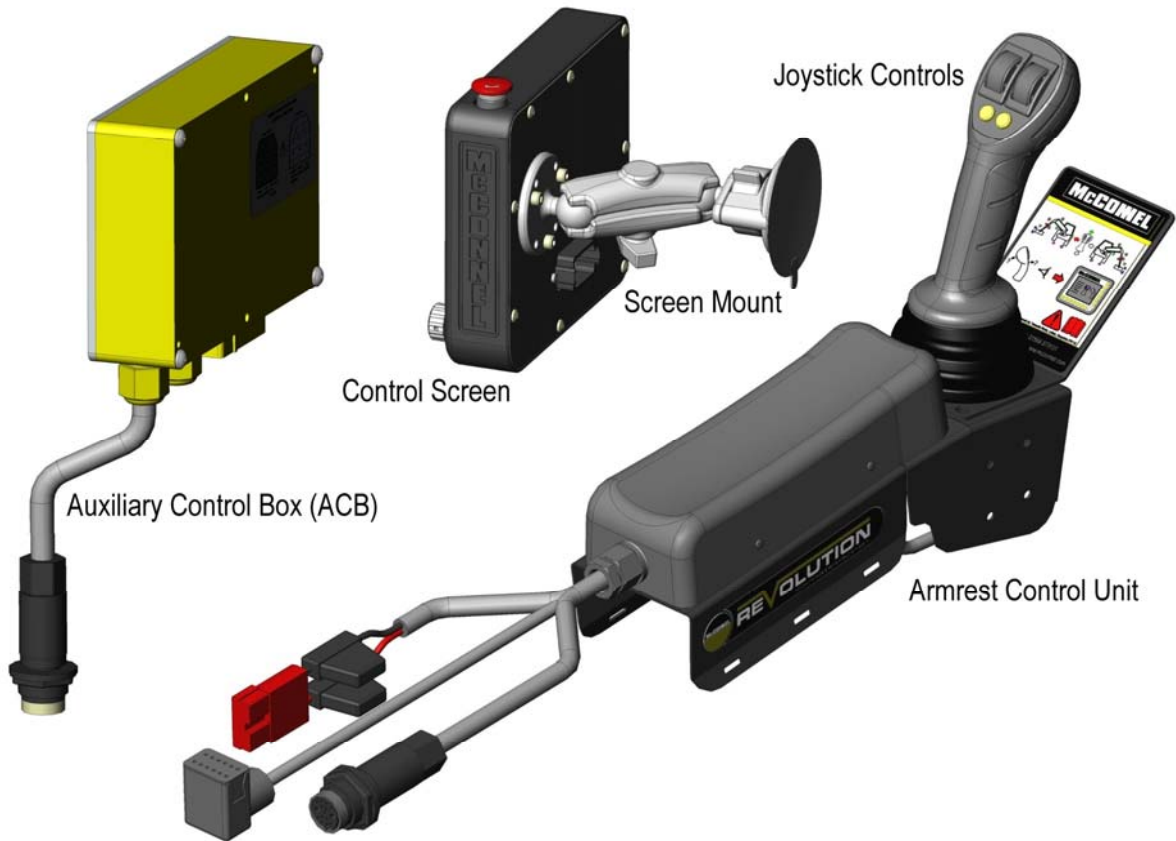

i On Tele/VFR machines, VFR is the default 'Slew Swap' function; the Tele function is configured to the D1 diverter control.

SOFTWARE VERSION & MENUS

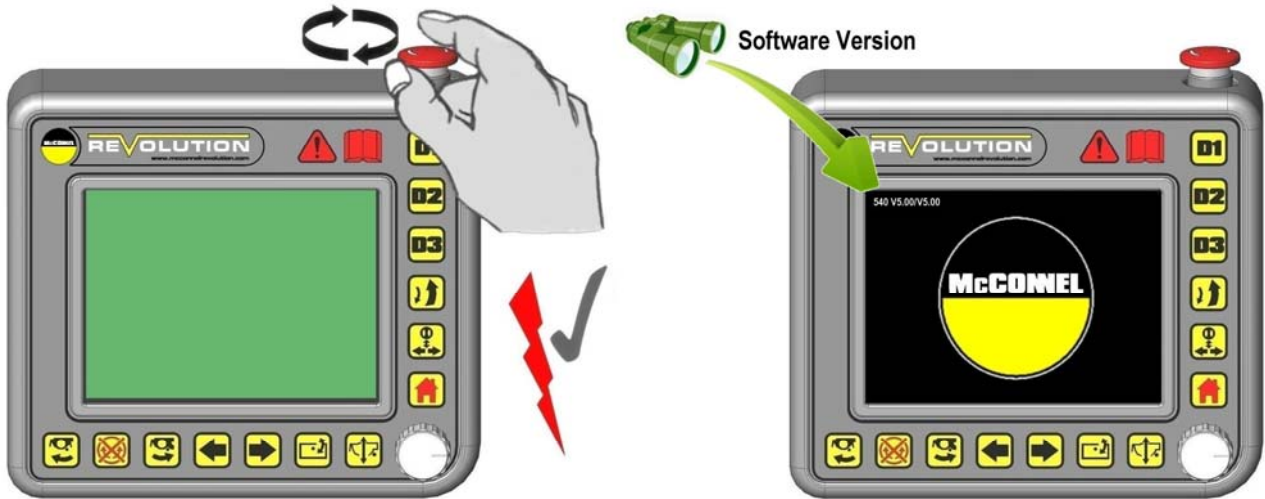

- Operator
- △ MENU : EXIT
 - ▼ ● EDS PID
 - PTO
 - ▶ TEST/CALIBRATE
 - ▶ JOYSTICK SETUP
 - ▶ VALVES
 - SETTINGS
 - ▶ REACH
 - ▶ REACH STOP
 - ▶ SLEW STOP
 - D1 ASSIGN
 - to
 - D5 ASSIGN
 - ▶ WARNING SOUND
 - FILTER TIMERS
 - FILTER LIST
 - ▶ ABOUT
 - PASSWORD



- Dealer / Factory
- △ MENU : EXIT
 - ▼ ▶ EDS PID
 - ▶ PTO
 - ▶ TEST/CALIBRATE
 - ▶ JOYSTICK SETUP
 - ▶ VALVES
 - ▶ SETTINGS
 - ▶ REACH
 - ▶ REACH STOP
 - ▶ SLEW STOP
 - ▶ D1 ASSIGN
 - to
 - ▶ D5 ASSIGN
 - ▶ WARNING SOUND
 - ▶ FILTER TIMERS
 - ▶ FILTER LIST
 - ▶ ABOUT
 - ▶ PASSWORD



- Operator
- △ MENU : EXIT
 - ▼ ● EDS PID
 - PTO
 - ▶ TEST/CALIBRATE
 - ▶ JOYSTICK SETUP
 - ▶ VALVES
 - ▶ VALVES 2
 - SETTINGS
 - ▶ REACH
 - ▶ REACH STOP
 - ▶ SLEW STOP
 - D1 ASSIGN
 - to
 - D5 ASSIGN
 - ▶ WARNING SOUND
 - FILTER TIMERS
 - FILTER LIST
 - ▶ ABOUT
 - PASSWORD



- Dealer / Factory
- △ MENU : EXIT
 - ▼ ▶ EDS PID
 - ▶ PTO
 - ▶ TEST/CALIBRATE
 - ▶ JOYSTICK SETUP
 - ▶ VALVES
 - ▶ VALVES 2
 - ▶ SETTINGS
 - ▶ REACH
 - ▶ REACH STOP
 - ▶ SLEW STOP
 - ▶ D1 ASSIGN
 - to
 - ▶ D5 ASSIGN
 - ▶ WARNING SOUND
 - ▶ FILTER TIMERS
 - ▶ FILTER LIST
 - ▶ ABOUT
 - ▶ PASSWORD

POWER ON /OFF

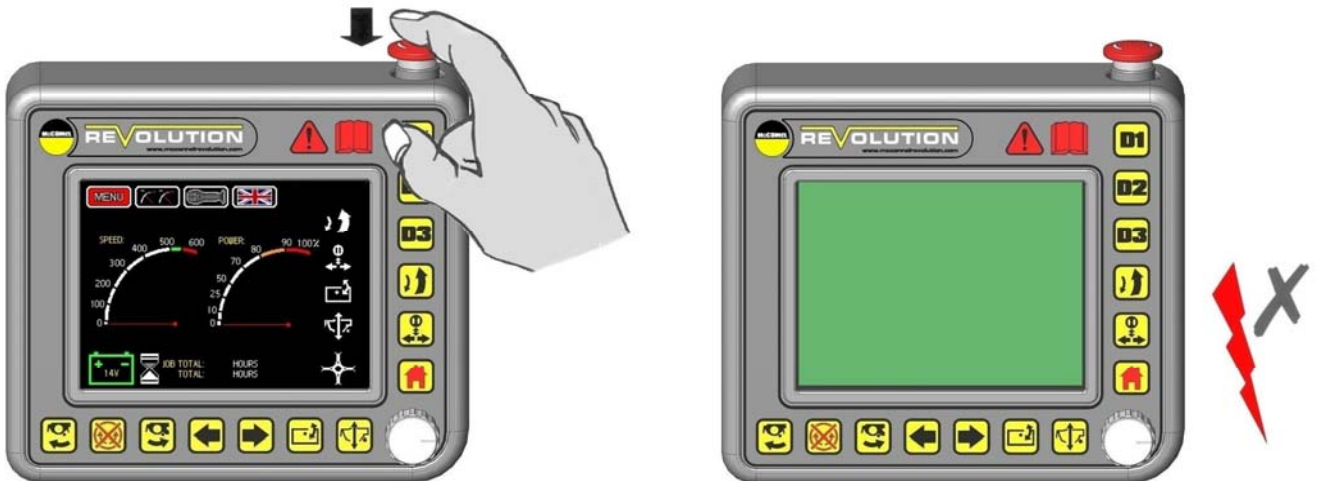

JOYSTICK LEVER OPERATIONS & DEFAULT SWITCH FUNCTIONS

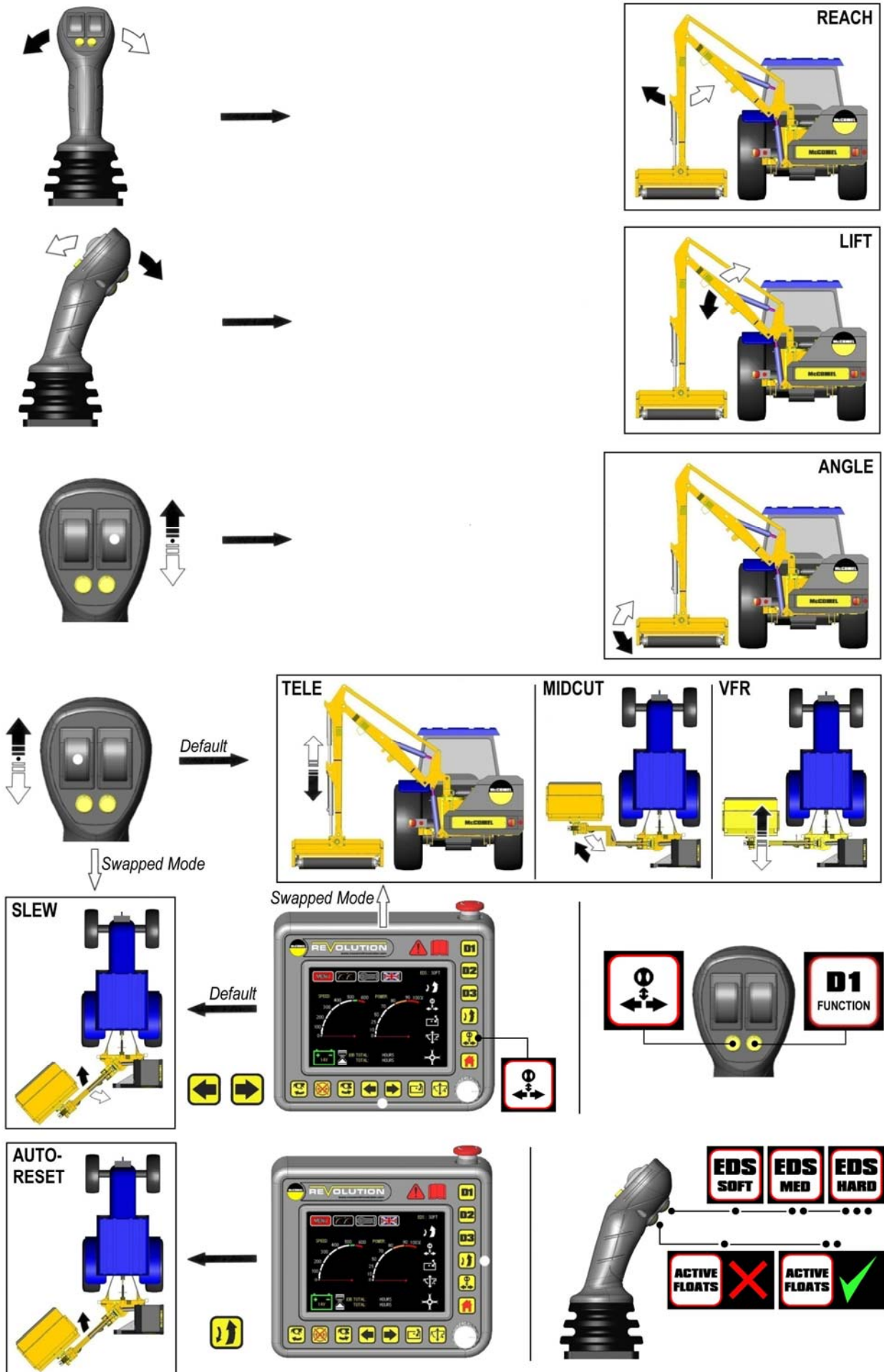

ROTOR ON & OFF

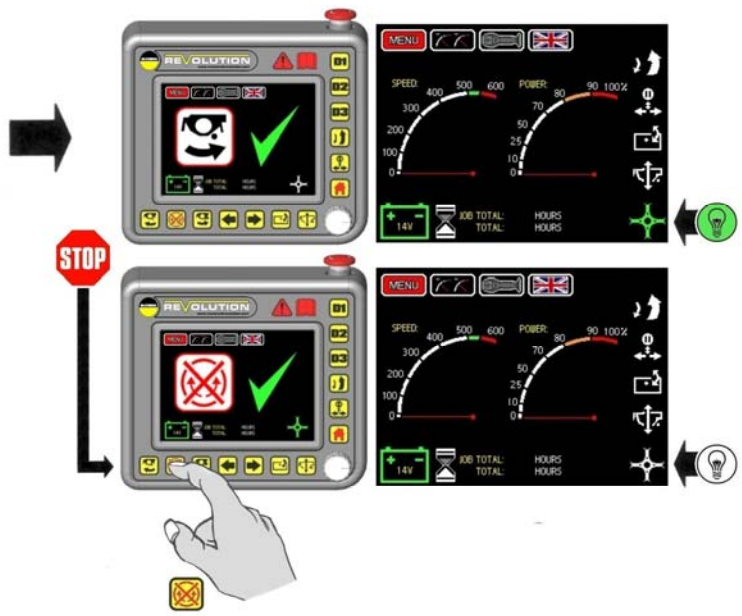
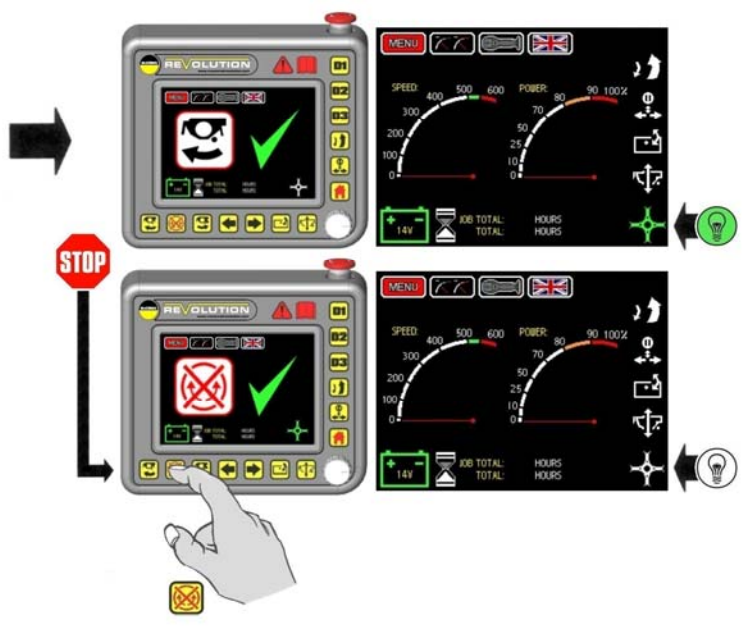

JOB TOTAL RESET

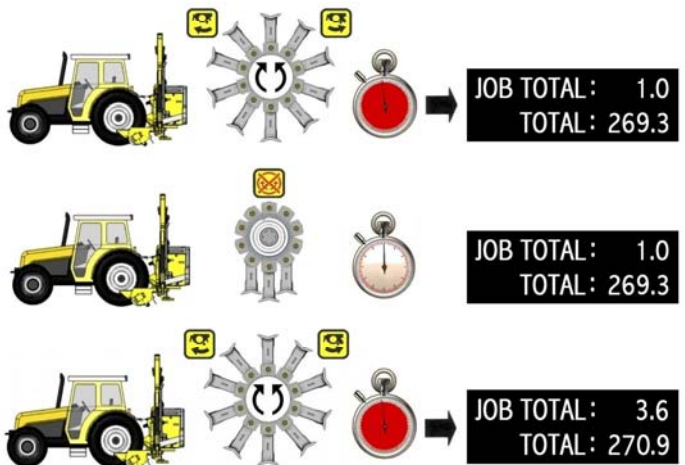
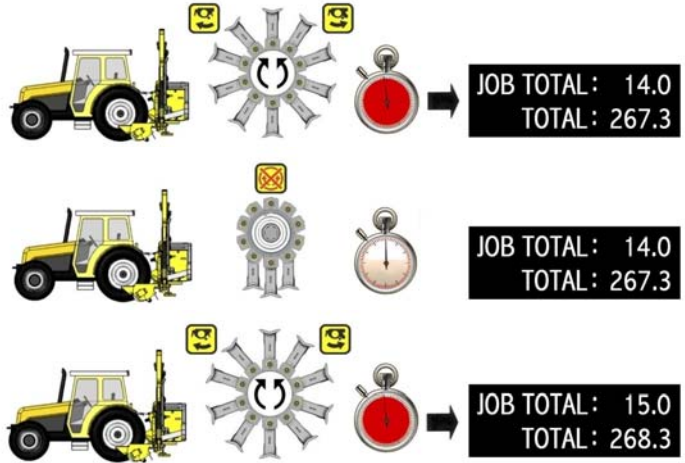

SLEW OPERATION & SLEW-TELE SWAP FUNCTION

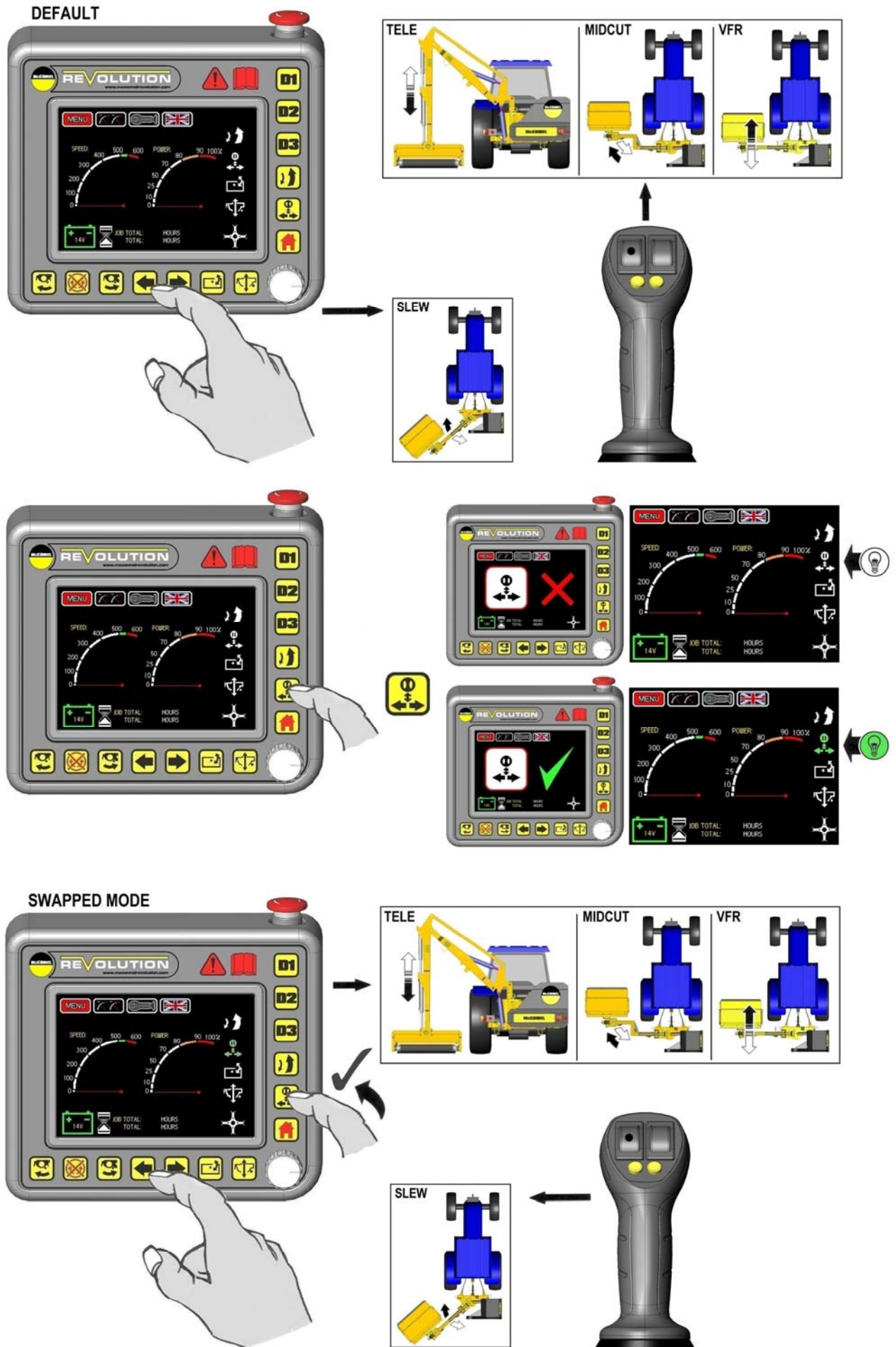

AUTO-RESET

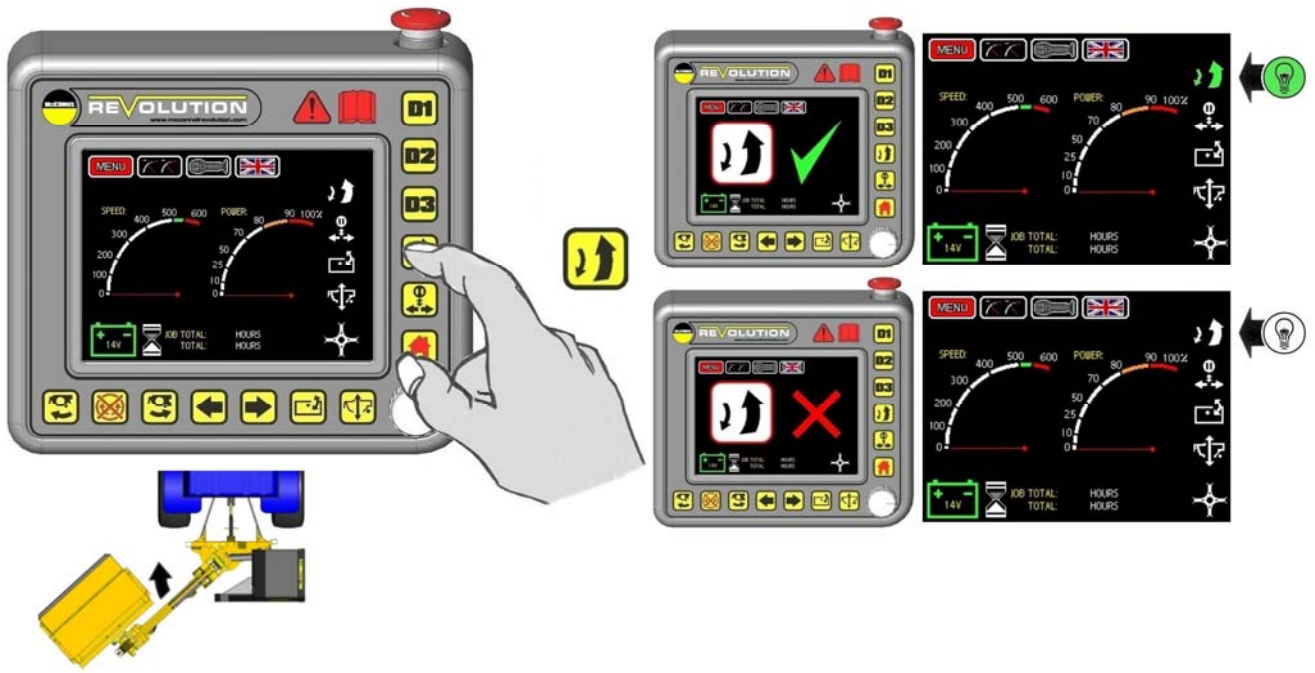

ANGLE FLOAT

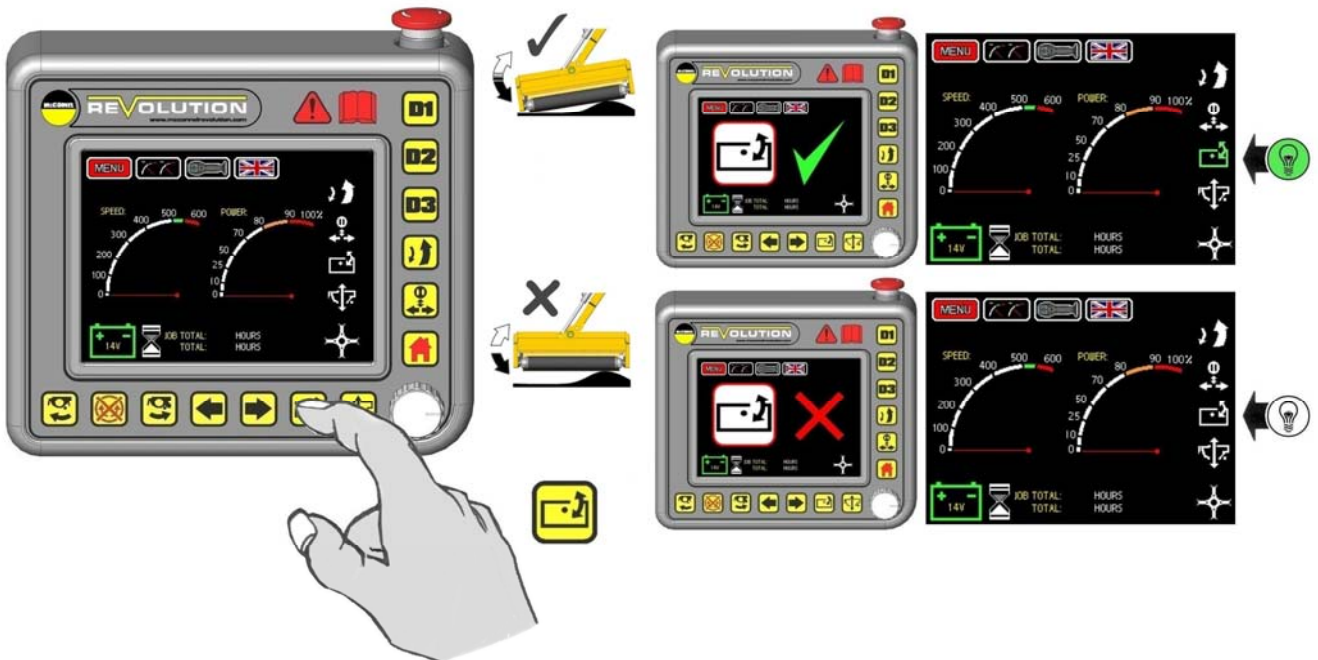

LIFT FLOAT / EDS / EDS PRO

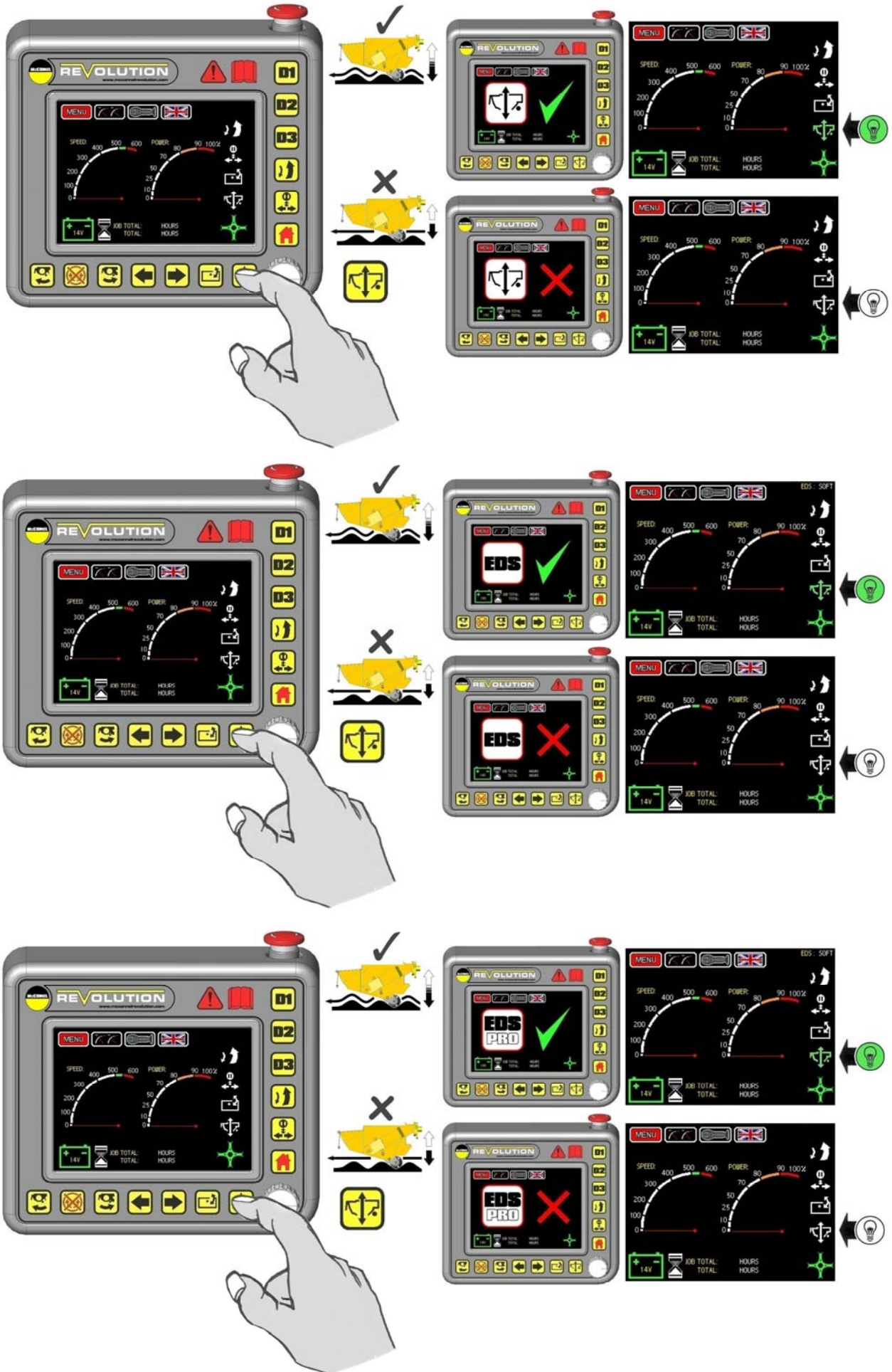

DIVERTERS D1 / D2 / D3

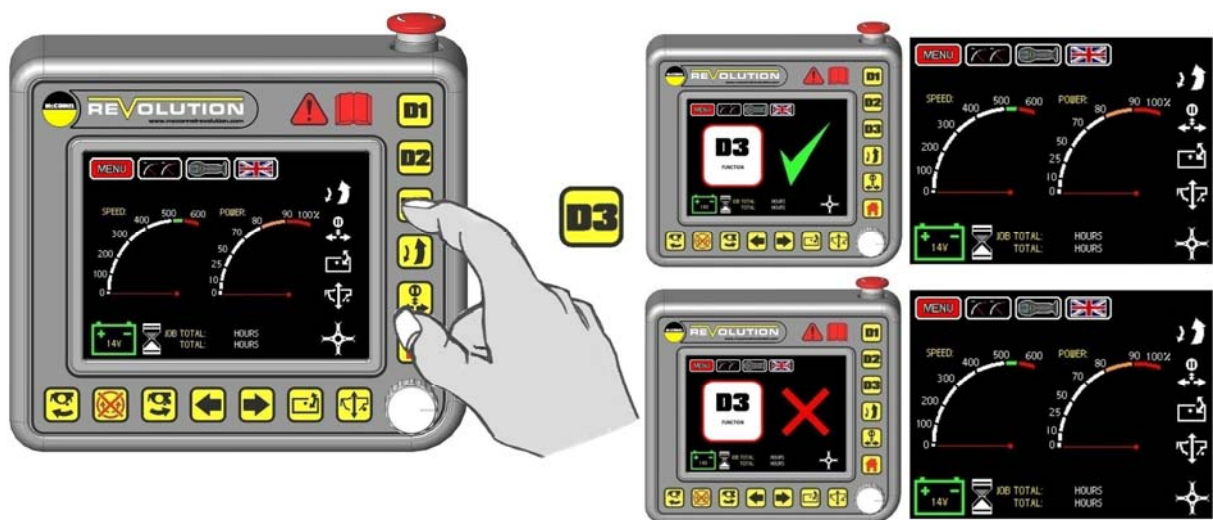
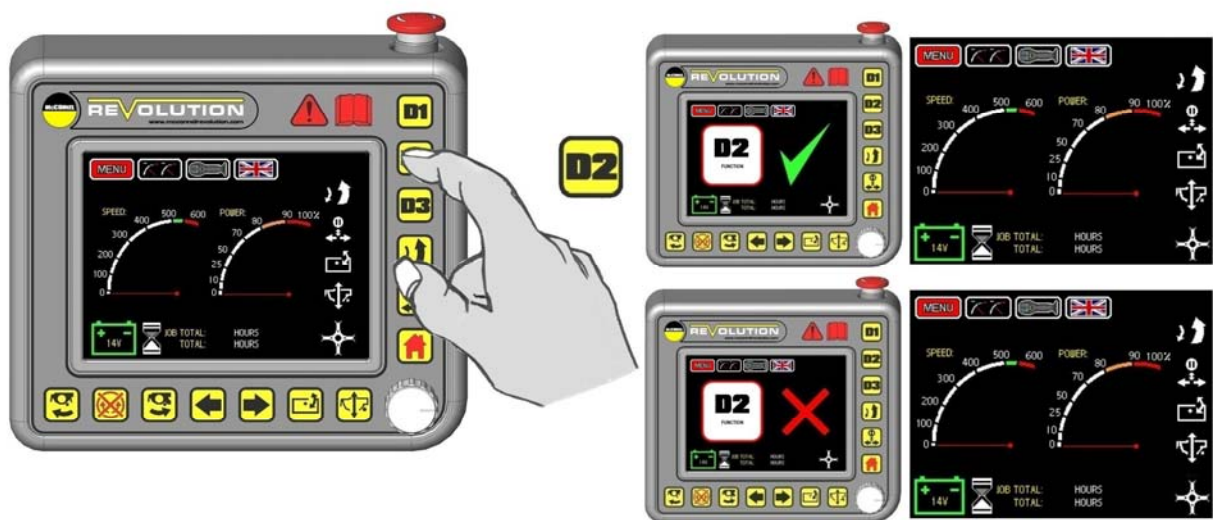
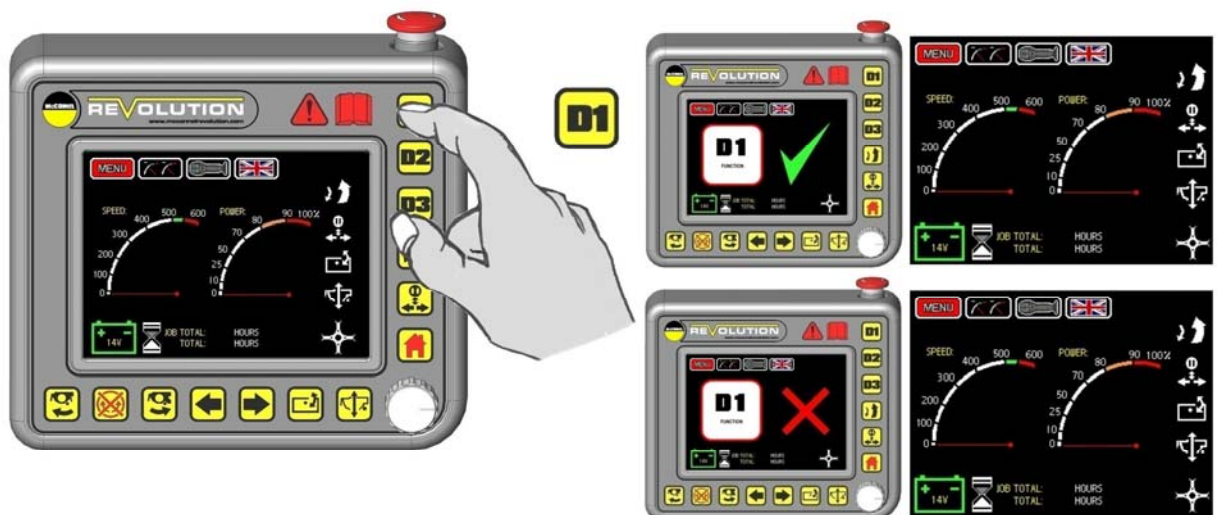

SCREEN NAVIGATION – Menu Screen & Work Screen

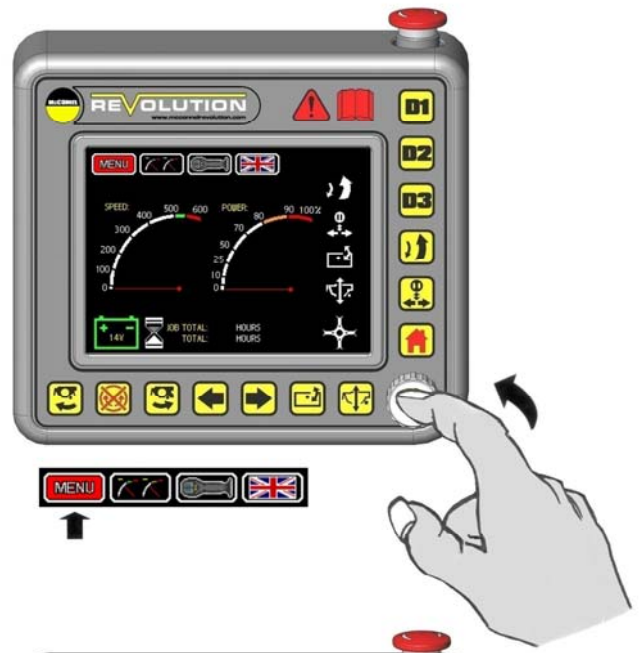
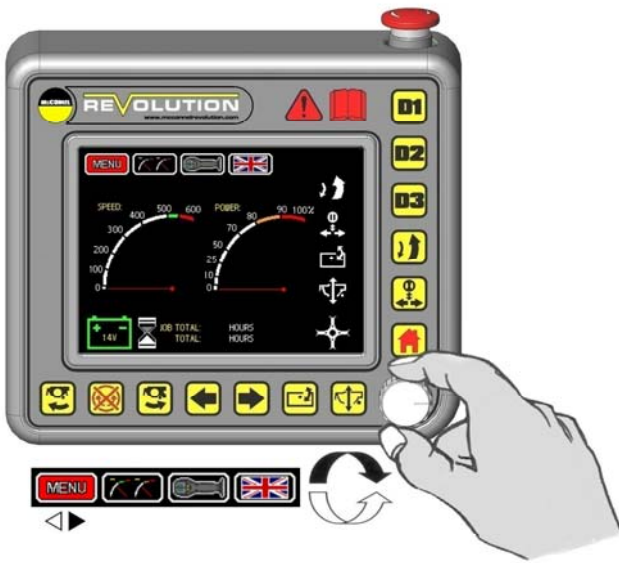

SCREEN NAVIGATION – Joystick Status Screen

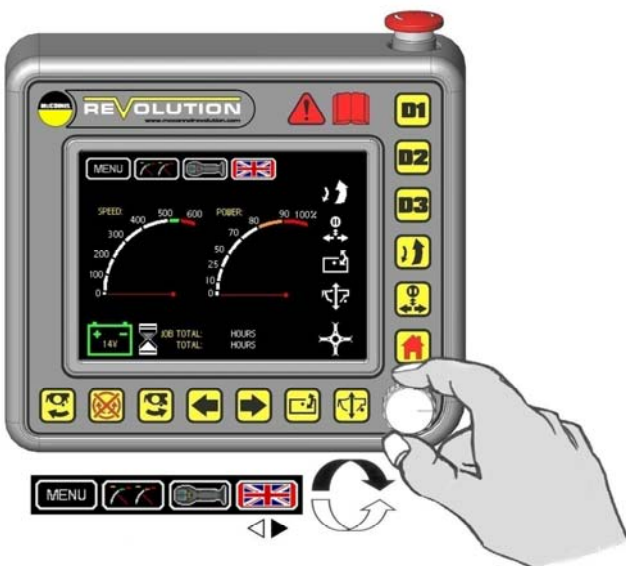
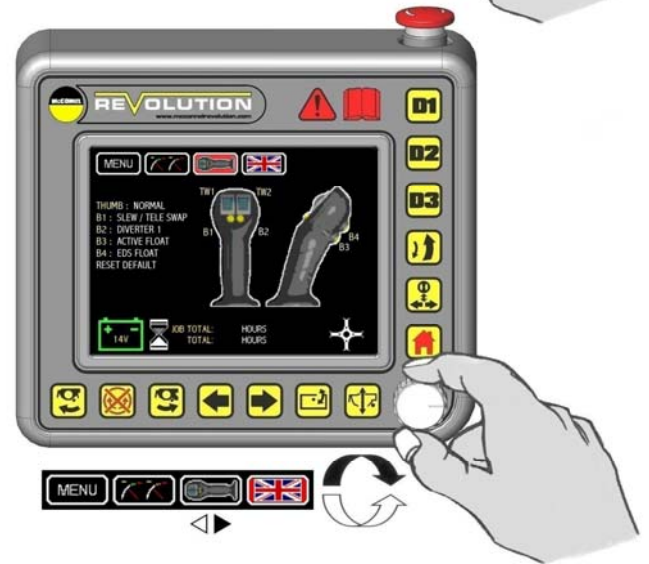

SCREEN NAVIGATION – Language Selection Screen



-  ENGLISH
-  DUTCH
-  GERMAN
-  POLISH
-  FRENCH
-  SPANISH
-  DANISH



MENU ACCESS & SETTINGS

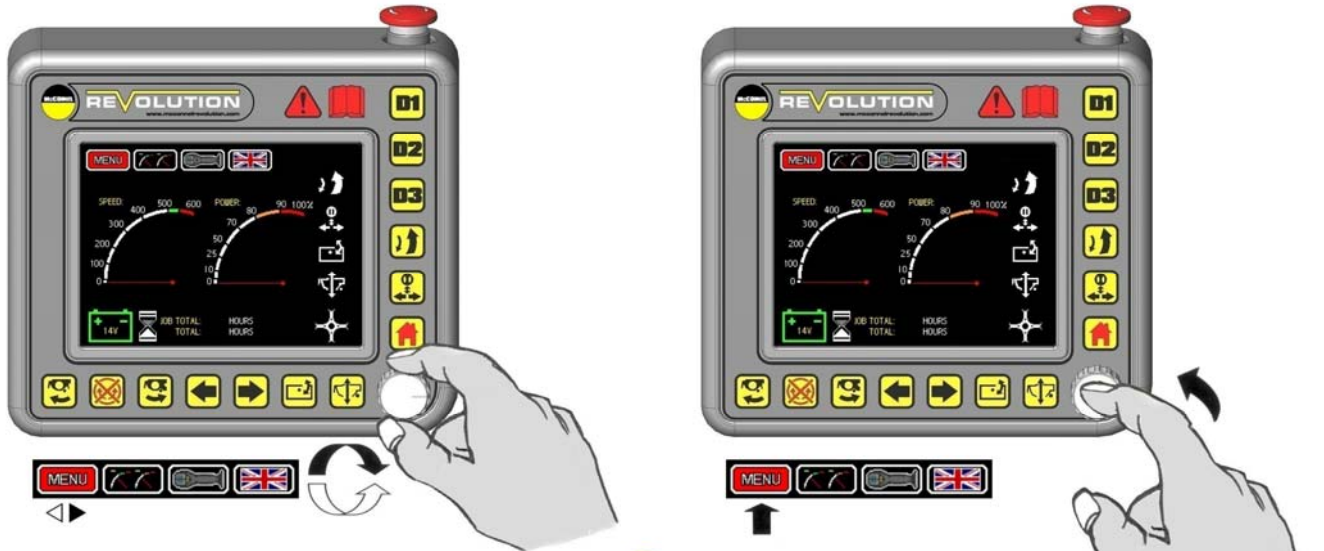

REACH SWAP

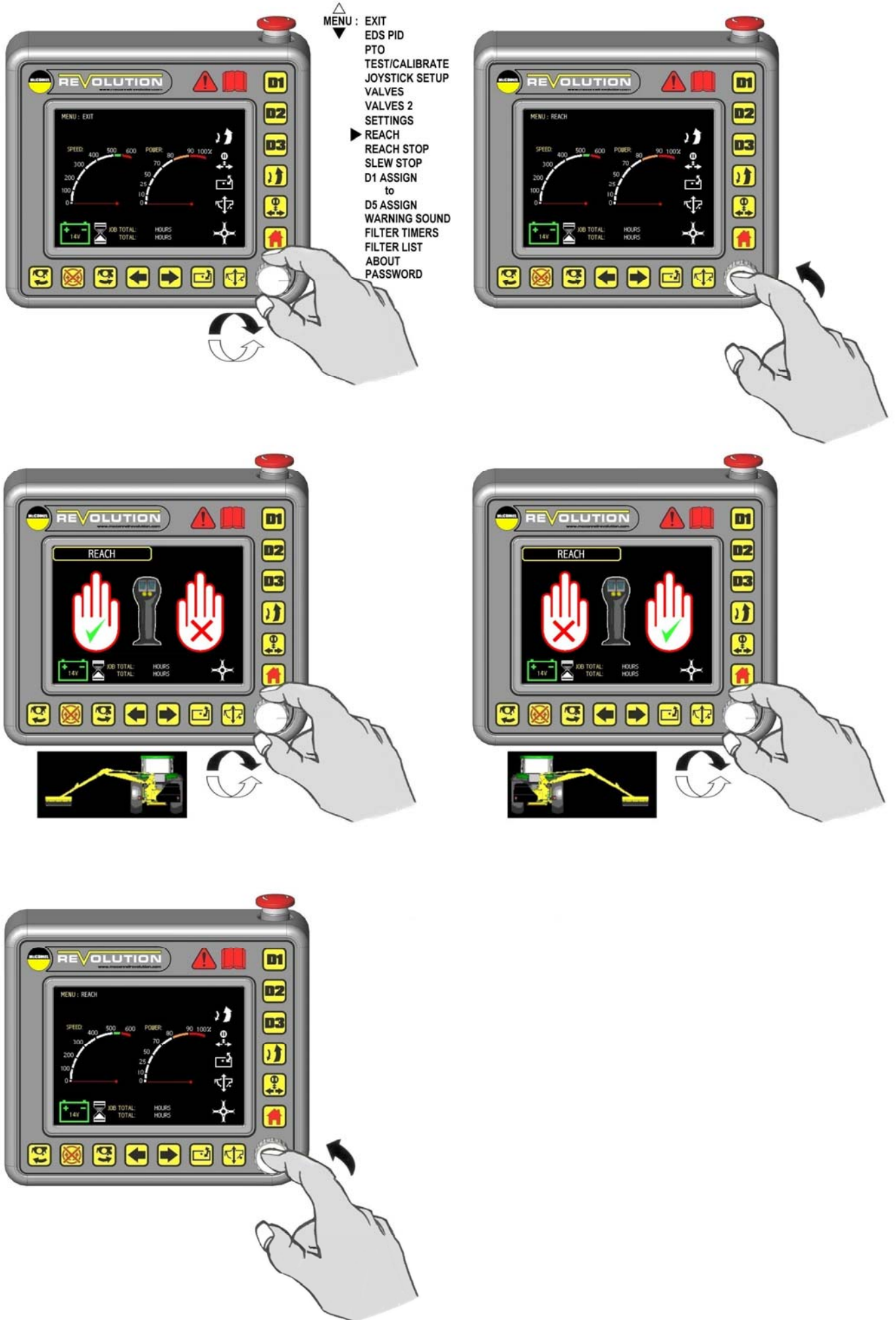

REACH STOPS – Setting Reach Stop Positions





MENU : EXIT
 EDS PID
 PTO
 TEST/CALIBRATE
 JOYSTICK SETUP
 VALVES
 VALVES 2
 SETTINGS
 REACH
 ► REACH STOP
 SLEW STOP
 D1 ASSIGN
 to
 D5 ASSIGN
 WARNING SOUND
 FILTER TIMERS
 FILTER LIST
 ABOUT
 PASSWORD





SET REACH STOP 1
SET REACH STOP 2
 REMOVE STOPS





SET REACH STOP 1
SET REACH STOP 2
 REMOVE STOPS



REACH STOPS – Remove Stop Positions

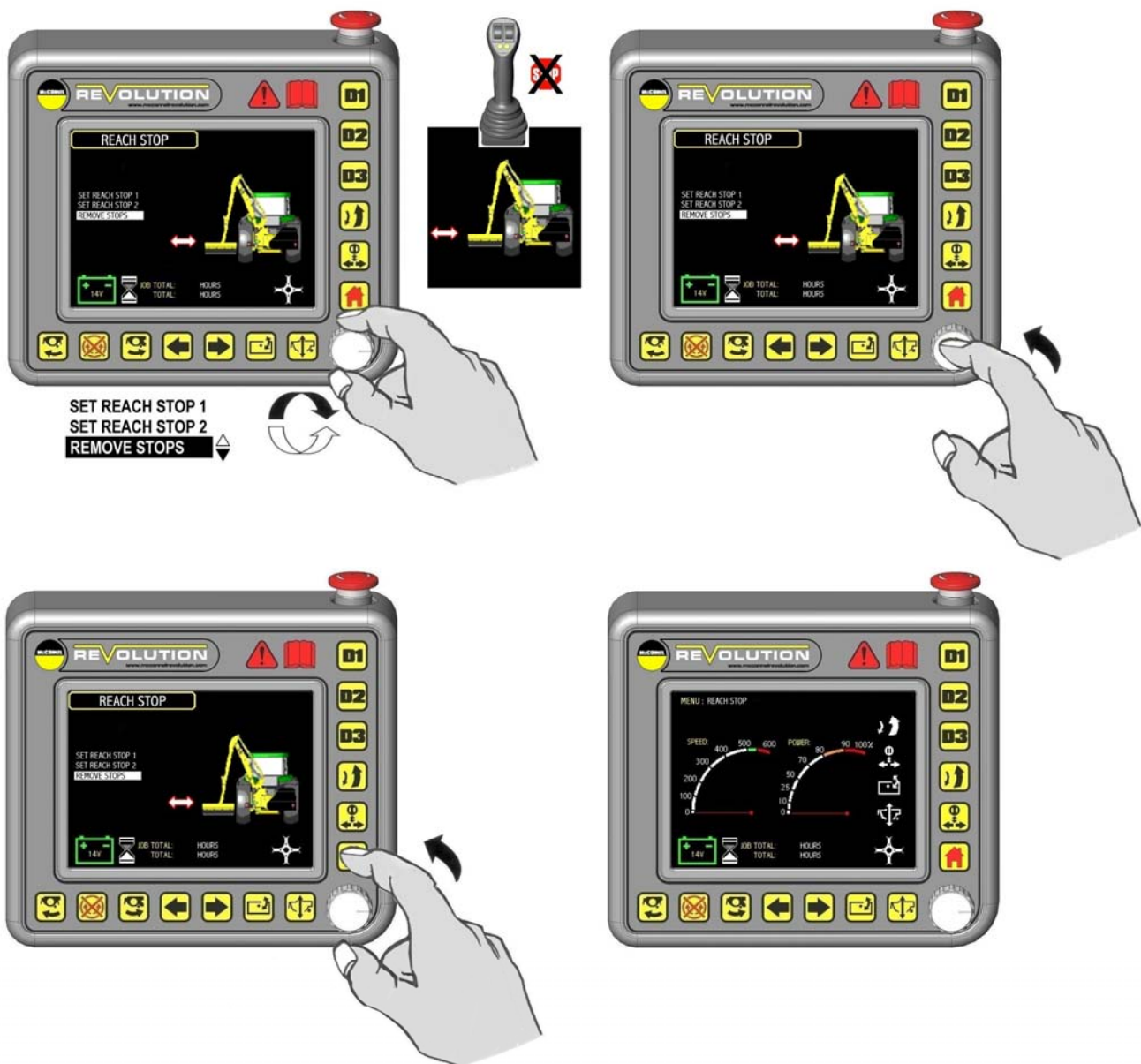

JOYSTICK SETUP – Selection & Activation of Joystick Functions



THUMB : **NORMAL**
 B1 : SLEW / TELE SWAP
 B2 : DIVERTER 1
 B3 : ACTIVE FLOAT
 B4 : EDS FLOAT
 RESET DEFAULT



THUMB : NORMAL
 B1 : SLEW / TELE SWAP
 B2 : DIVERTER 1
 B3 : **ACTIVE FLOAT**
 B4 : EDS FLOAT
 RESET DEFAULT



THUMB : NORMAL
 B1 : SLEW / TELE SWAP
 B2 : DIVERTER 1
 B3 : ACTIVE FLOAT
 B4 : EDS FLOAT
 RESET DEFAULT

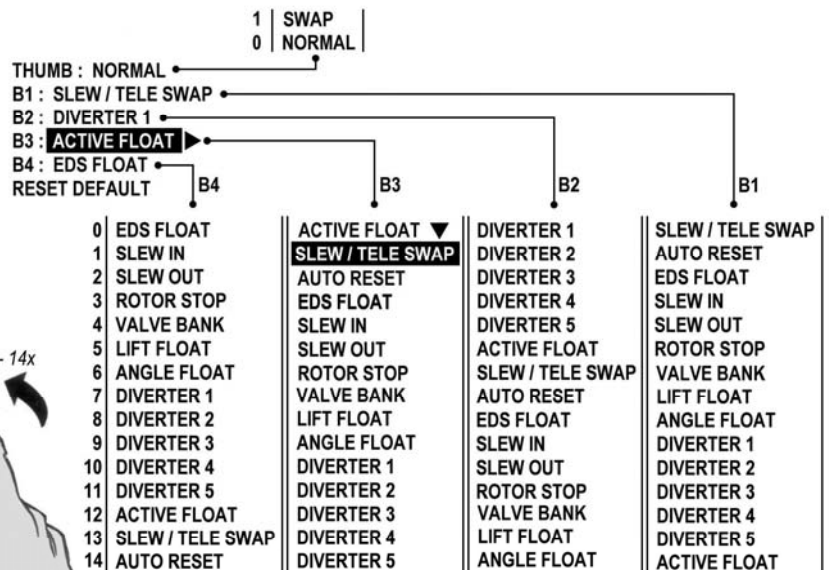

JOYSTICK TEST / CALIBRATE



- △ MENU : EXIT
- ▽ EDS PID
- ▽ PTO
- ▶ TEST/CALIBRATE
- JOYSTICK SETUP
- VALVES
- VALVES 2
- SETTINGS
- REACH
- REACH STOP
- SLEW STOP
- D1 ASSIGN to D5 ASSIGN
- WARNING SOUND
- FILTER TIMERS
- FILTER LIST
- ABOUT
- PASSWORD

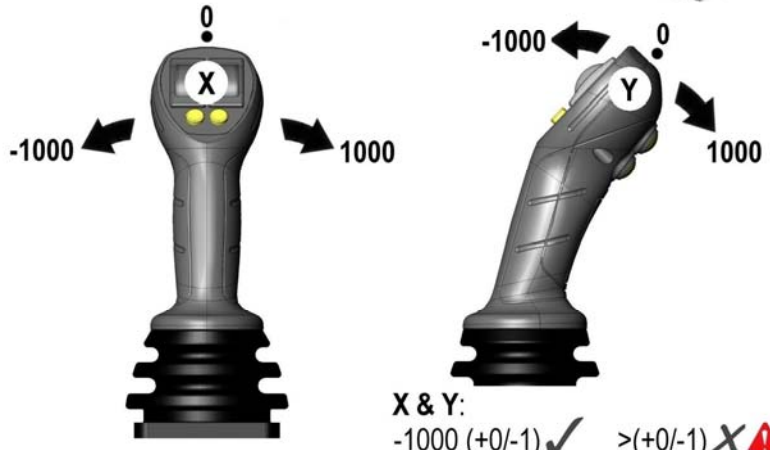

- X & Y:
- 1000 (+0/-1) ✓ >(+0/-1) X ⚠
 - 0 (+0/-0) ✓ >(+0/-0) X ⚠
 - 1000 (+0/-1) ✓ >(+0/-1) X ⚠

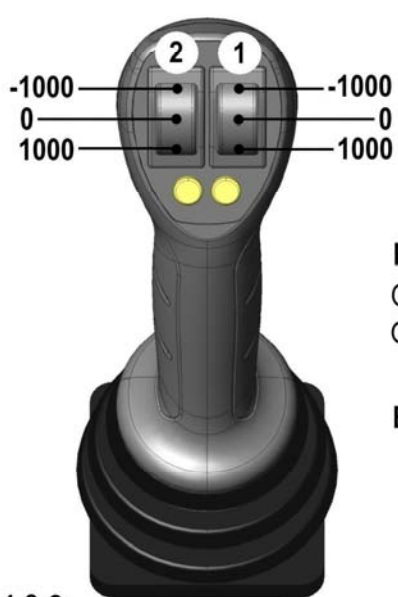

JOYSTICK X:	0	PTO SPEED:	540
JOYSTICK Y:	0	RVC PRESSURE:	200
THUMBWHEEL 1:	0	LIFT PRESSURE:	40
THUMBWHEEL 2:	0	REACH POSITION:	55
BUTTON 1:	222 OFF	CUTTER TOTAL:	25.4
BUTTON 2:	225 OFF	OVER SPEED:	0.0
BUTTON 3:	250 OFF	OVER POWER:	20.0
BUTTON 4:	254 OFF	ARMREST POWER:	245.5
		ACB POWER:	245.5
		FILTER TIME:	245.5
		FILTER OVER:	0.0

B1 / B2 / B3 / B4

ON / OFF ✓

ON / OFF X ⚠



- 1 & 2:
- 1000 (+0/-1) ✓ >(+0/-1) X ⚠
 - 0 (+0/-0) ✓ >(+0/-0) X ⚠
 - 1000 (+0/-1) ✓ >(+0/-1) X ⚠

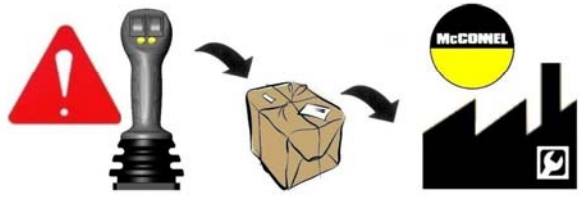

VALVES RESPONSE SETTINGS

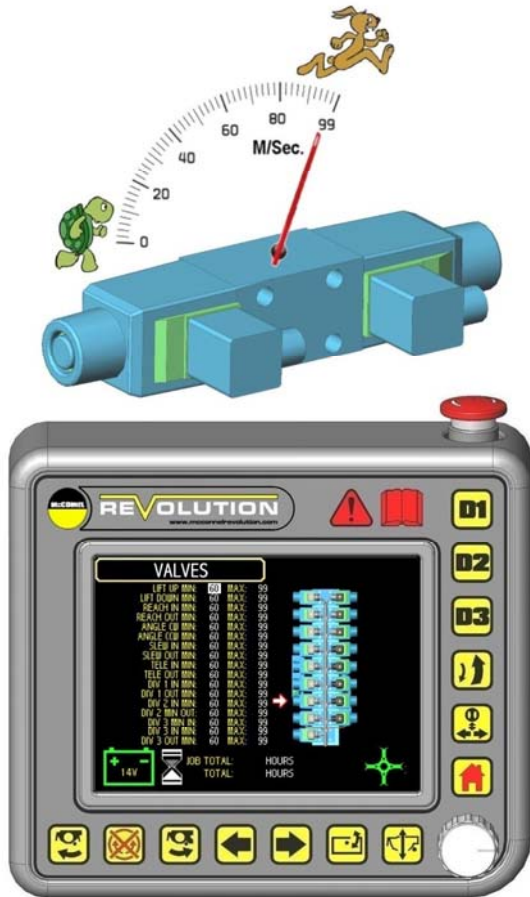

< DEFAULT SETTINGS >

LIFT UP MIN:	50	MAX:	99
LIFT DOWN MIN:	50	MAX:	99
REACH IN MIN:	60	MAX:	99
REACH OUT MIN:	60	MAX:	99
ANGLE CW MIN:	60	MAX:	99
ANGLE CCW MIN:	60	MAX:	99
SLEW IN MIN:	60	MAX:	99
SLEW OUT MIN:	60	MAX:	99
TELE IN MIN:	60	MAX:	99
TELE OUT MIN:	60	MAX:	99
DIV 1 IN MIN:	60	MAX:	99
DIV 1 OUT MIN:	60	MAX:	99
DIV 2 IN MIN:	60	MAX:	99
DIV 2 OUT MIN:	60	MAX:	99
DIV 3 IN MIN:	60	MAX:	99
DIV 3 OUT MIN:	60	MAX:	99
SLEW 2 IN MIN:	60	MAX:	99
SLEW 2 OUT MIN:	60	MAX:	99

VALVES 2 RESPONSE SETTINGS (Applicable to software v5.08 onwards)

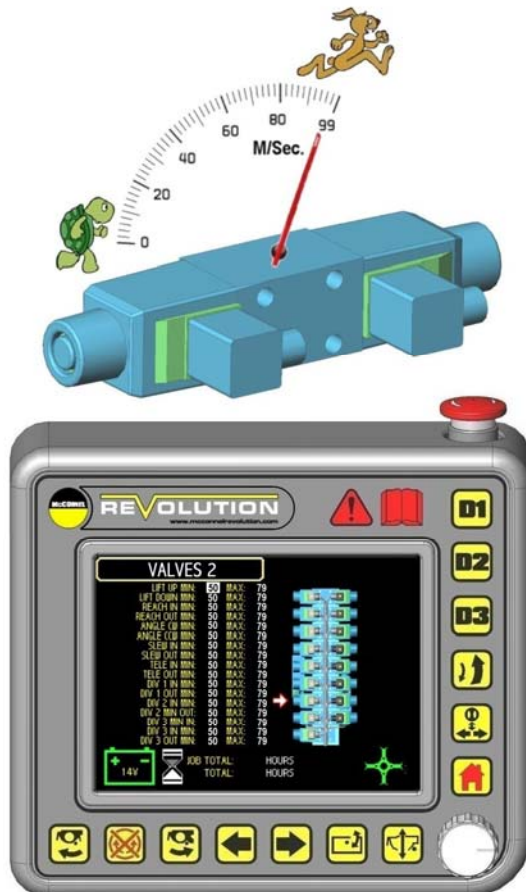

< DEFAULT SETTINGS >

LIFT UP MIN:	50	MAX:	79
LIFT DOWN MIN:	50	MAX:	79
REACH IN MIN:	50	MAX:	79
REACH OUT MIN:	50	MAX:	79
ANGLE CW MIN:	50	MAX:	79
ANGLE CCW MIN:	50	MAX:	79
SLEW IN MIN:	50	MAX:	79
SLEW OUT MIN:	50	MAX:	79
TELE IN MIN:	50	MAX:	79
TELE OUT MIN:	50	MAX:	79
DIV 1 IN MIN:	50	MAX:	79
DIV 1 OUT MIN:	50	MAX:	79
DIV 2 IN MIN:	50	MAX:	79
DIV 2 OUT MIN:	50	MAX:	79
DIV 3 IN MIN:	50	MAX:	79
DIV 3 OUT MIN:	50	MAX:	79
SLEW 2 IN MIN:	50	MAX:	79
SLEW 2 OUT MIN:	50	MAX:	79

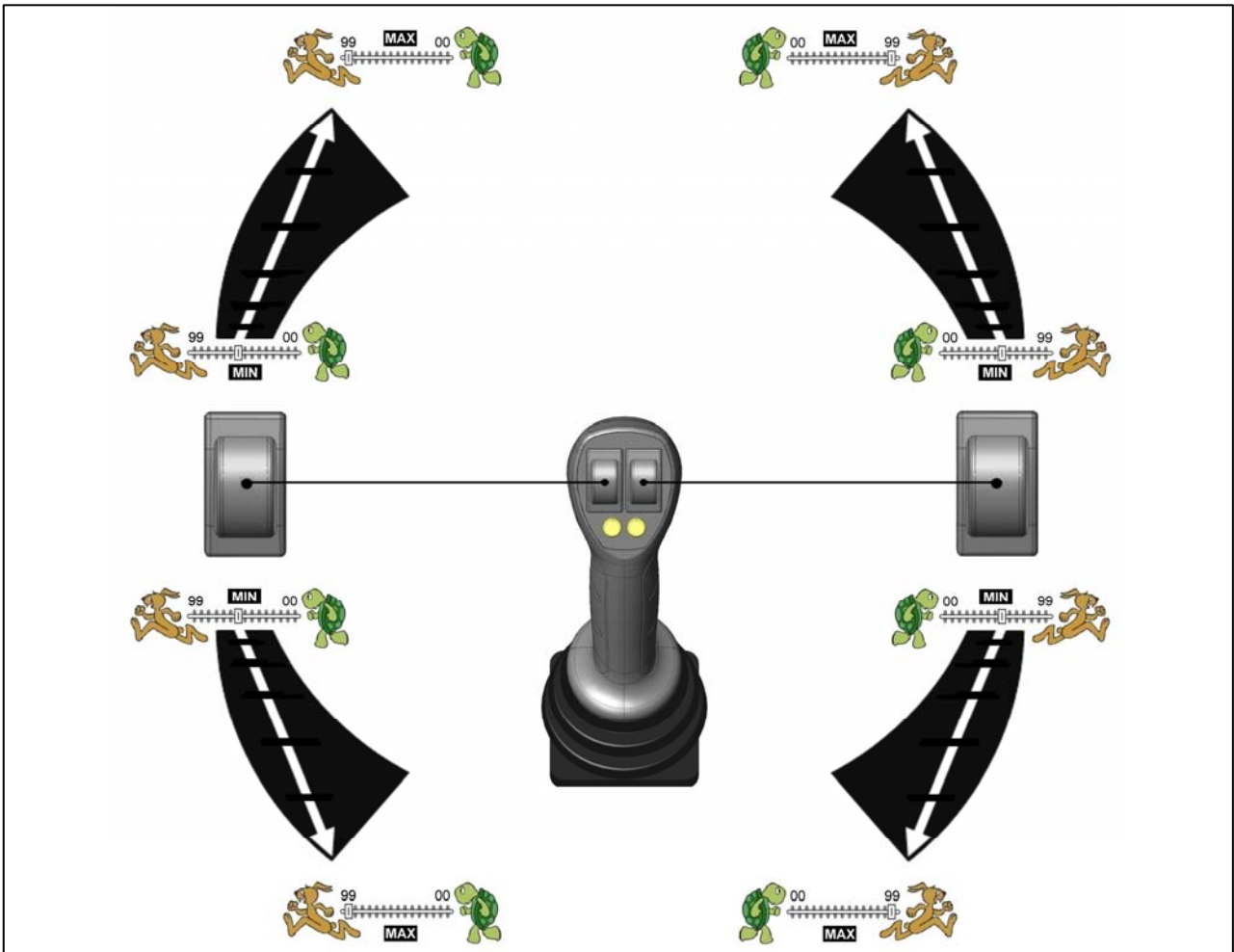
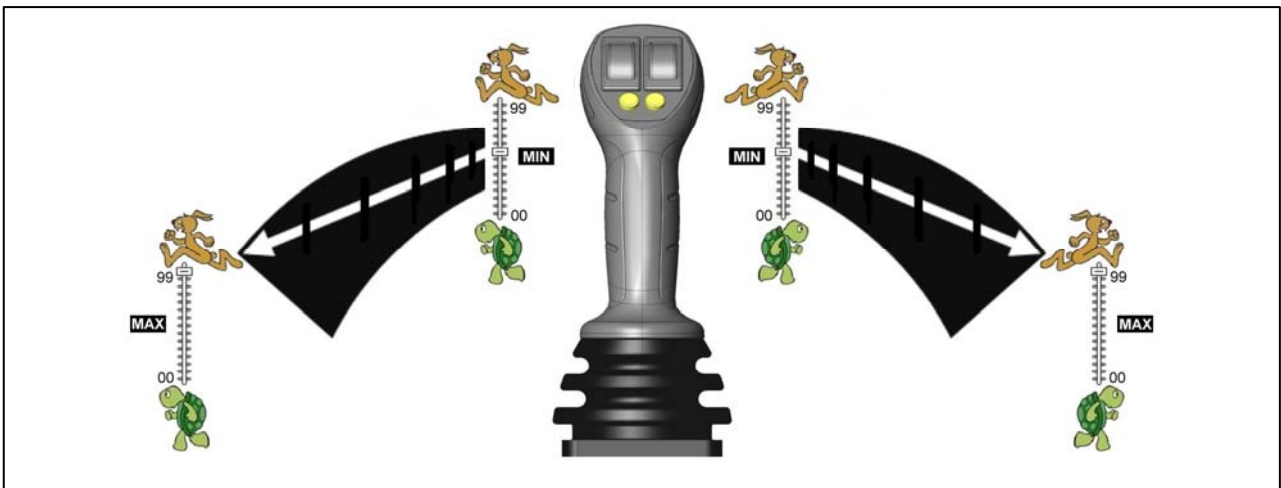
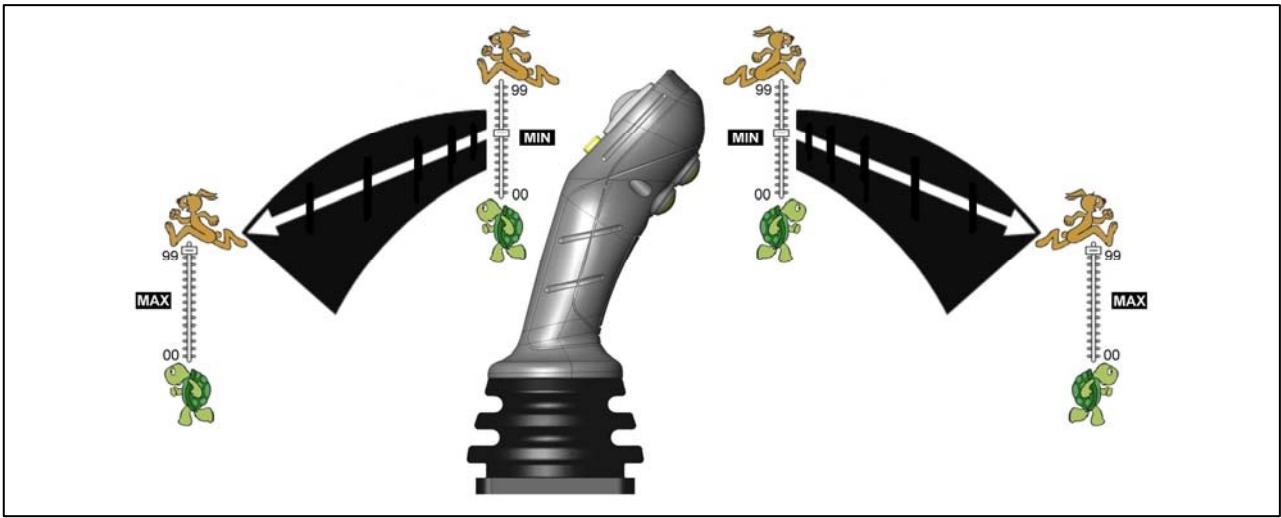

VALVE RESPONSE ADJUSTMENT

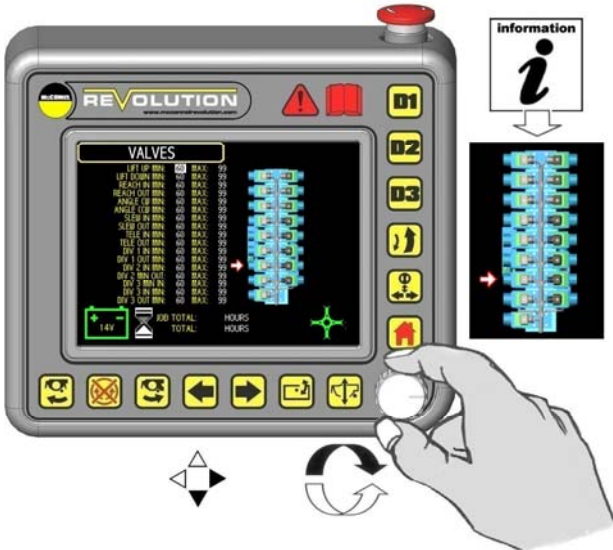
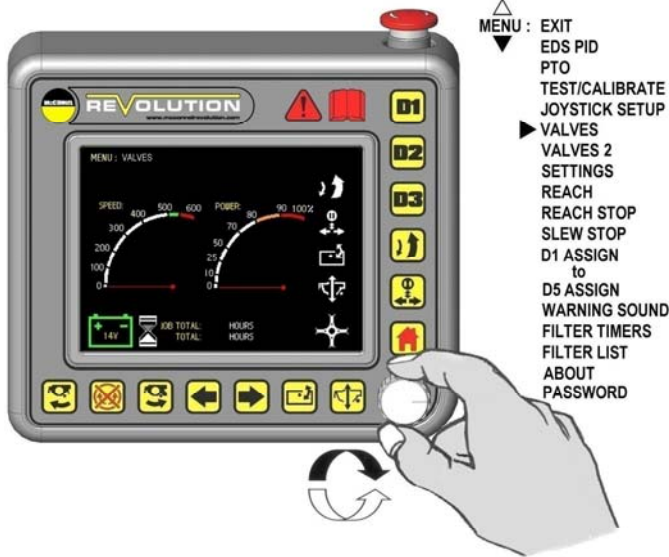

< DEFAULT SETTINGS >

LIFT UP MIN:	50	MAX:	99
LIFT DOWN MIN:	50	MAX:	99
REACH IN MIN:	60	MAX:	99
REACH OUT MIN:	60	MAX:	99
ANGLE CW MIN:	60	MAX:	99
ANGLE CCW MIN:	60	MAX:	99
SLEW IN MIN:	60	MAX:	99
SLEW OUT MIN:	60	MAX:	99
TELE IN MIN:	60	MAX:	99
TELE OUT MIN:	60	MAX:	99
DIV 1 IN MIN:	60	MAX:	99
DIV 1 OUT MIN:	60	MAX:	99
DIV 2 IN MIN:	60	MAX:	99
DIV 2 OUT MIN:	60	MAX:	99
DIV 3 IN MIN:	60	MAX:	99
DIV 3 OUT MIN:	60	MAX:	99
SLEW 2 IN MIN:	60	MAX:	99
SLEW 2 OUT MIN:	60	MAX:	99

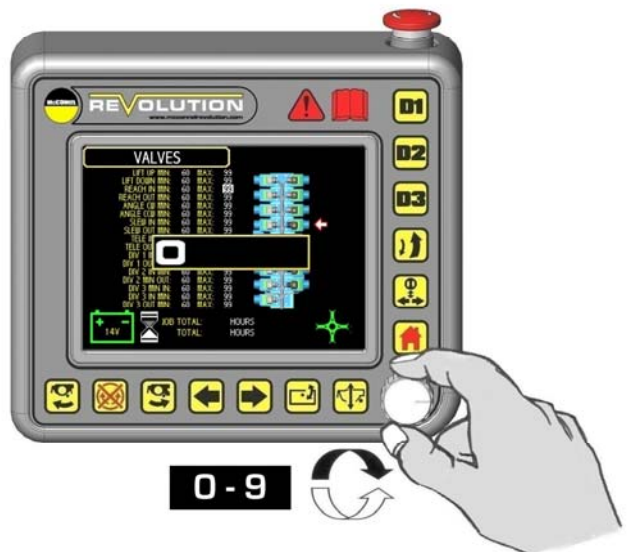
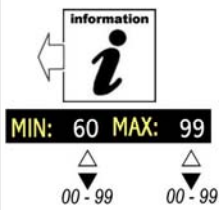

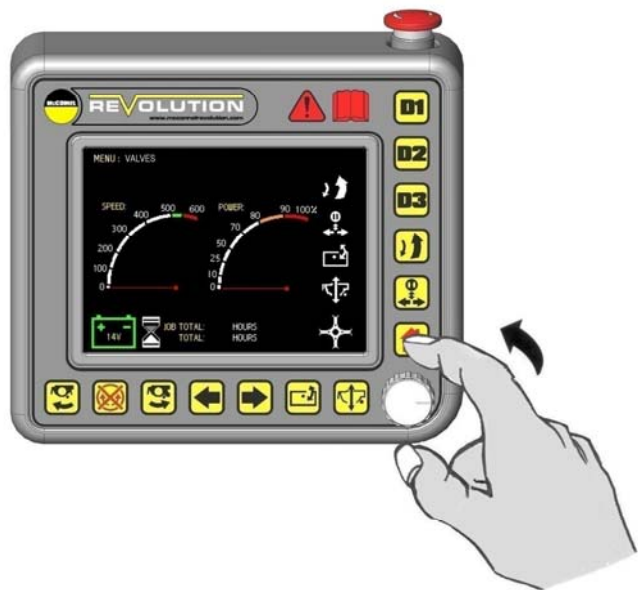
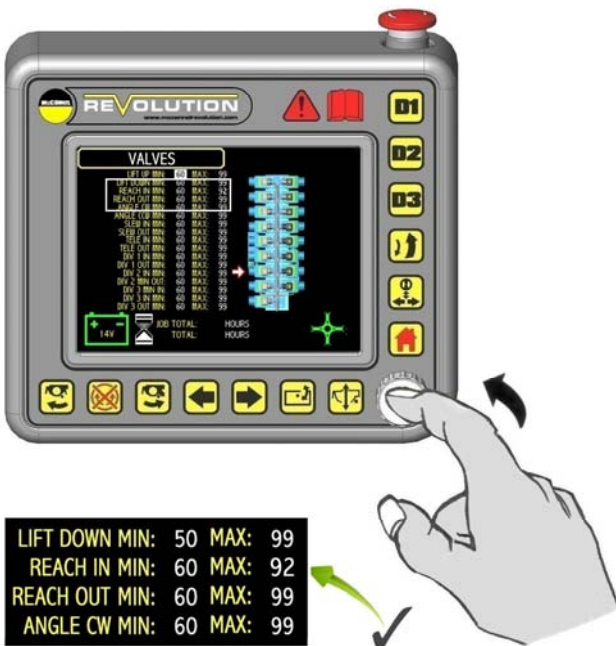
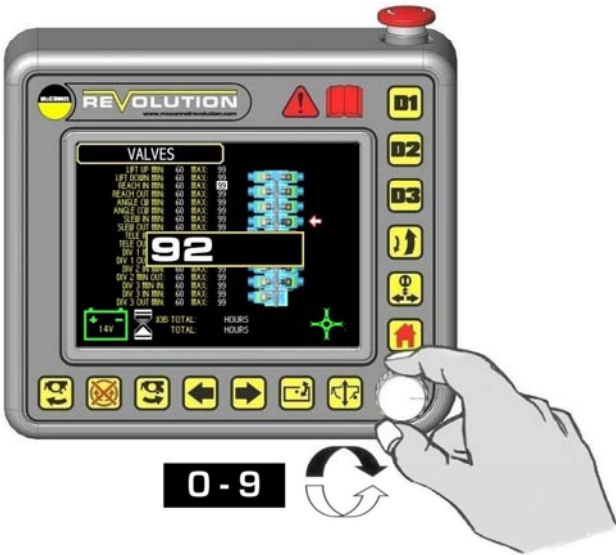
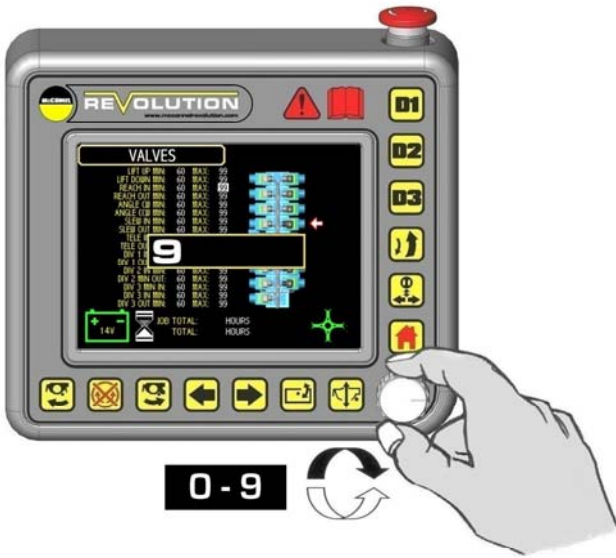

VALVE 2 RESPONSE ADJUSTMENT (Software Version v5.08 onwards only)

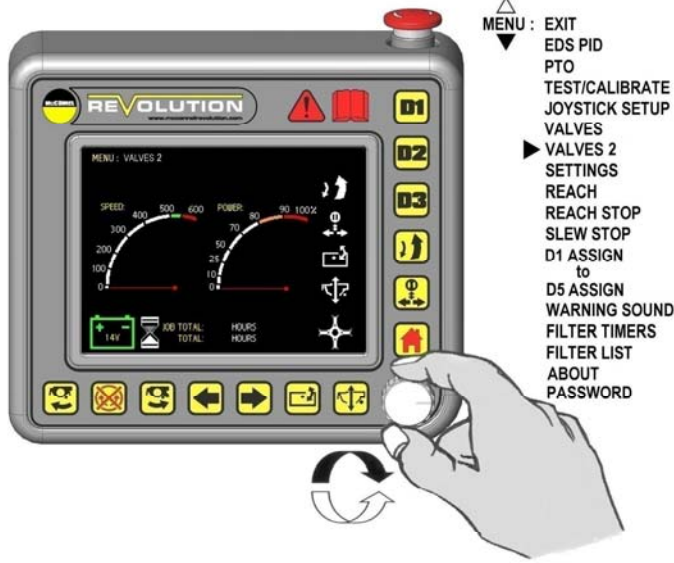

- ▲ MENU: EXIT
- ▼ EDS PID
- PTO
- TEST/CALIBRATE
- JOYSTICK SETUP
- VALVES
- ▶ VALVES 2
- SETTINGS
- REACH
- REACH STOP
- SLEW STOP
- D1 ASSIGN to
- D5 ASSIGN
- WARNING SOUND
- FILTER TIMERS
- FILTER LIST
- ABOUT
- PASSWORD

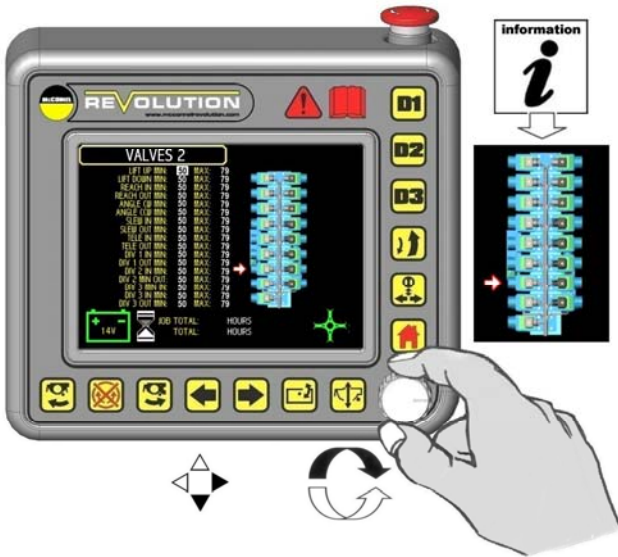

< DEFAULT SETTINGS >

LIFT UP MIN:	50	MAX:	79
LIFT DOWN MIN:	50	MAX:	79
REACH IN MIN:	50	MAX:	79
REACH OUT MIN:	50	MAX:	79
ANGLE CW MIN:	50	MAX:	79
ANGLE CCW MIN:	50	MAX:	79
SLEW IN MIN:	50	MAX:	79
SLEW OUT MIN:	50	MAX:	79
TELE IN MIN:	50	MAX:	79
TELE OUT MIN:	50	MAX:	79
DIV 1 IN MIN:	50	MAX:	79
DIV 1 OUT MIN:	50	MAX:	79
DIV 2 IN MIN:	50	MAX:	79
DIV 2 OUT MIN:	50	MAX:	79
DIV 3 IN MIN:	50	MAX:	79
DIV 3 OUT MIN:	50	MAX:	79
SLEW 2 IN MIN:	50	MAX:	79
SLEW 2 OUT MIN:	50	MAX:	79

information

MIN: 50 MAX: 79

00-99 00-99

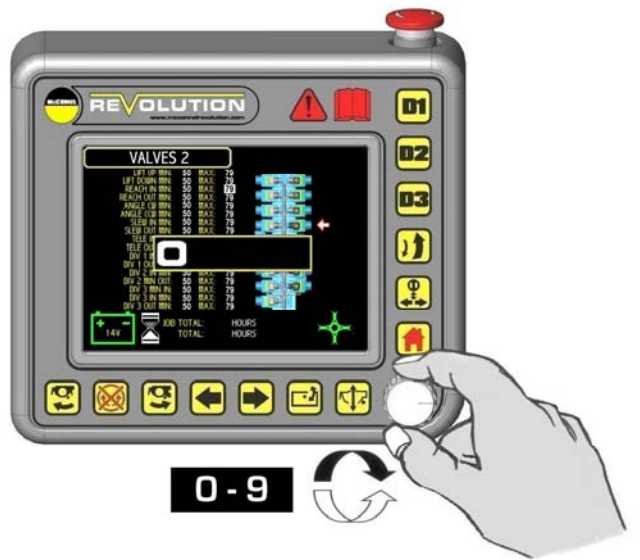

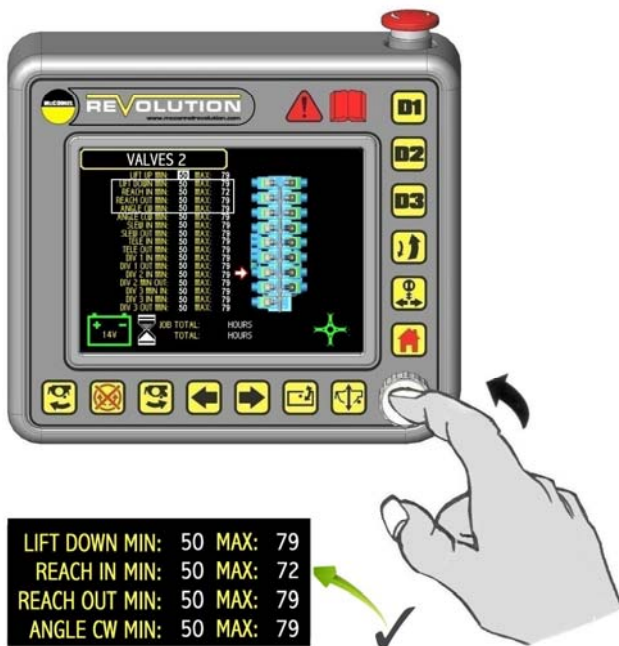
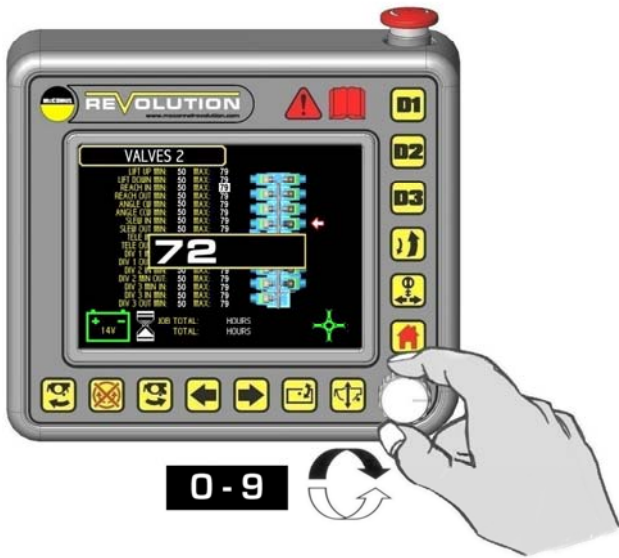
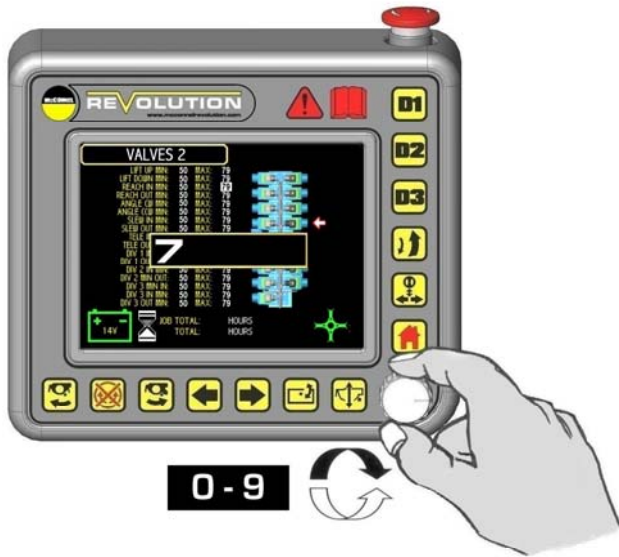

VALVE BANK FEATURE SELECTION

1 | SWAP |
0 | NORMAL |

THUMB : NORMAL
B1 : SLEW / TELE SWAP
B2 : DIVERTER 1
B3 : **VALVE BANK**
B4 : EDS FLOAT
RESET DEFAULT

0 EDS FLOAT	ACTIVE FLOAT ▼	DIVERTER 1	SLEW / TELE SWAP
1 SLEW IN	SLEW / TELE SWAP	DIVERTER 2	AUTO RESET
2 SLEW OUT	AUTO RESET	DIVERTER 3	EDS FLOAT
3 ROTOR STOP	EDS FLOAT	DIVERTER 4	SLEW IN
4 VALVE BANK	SLEW IN	DIVERTER 5	SLEW OUT
5 LIFT FLOAT	SLEW OUT	ACTIVE FLOAT	ROTOR STOP
6 ANGLE FLOAT	ROTOR STOP	SLEW / TELE SWAP	VALVE BANK
7 DIVERTER 1	VALVE BANK	AUTO RESET	LIFT FLOAT
8 DIVERTER 2	LIFT FLOAT	EDS FLOAT	ANGLE FLOAT
9 DIVERTER 3	ANGLE FLOAT	SLEW IN	DIVERTER 1
10 DIVERTER 4	DIVERTER 1	SLEW OUT	DIVERTER 2
11 DIVERTER 5	DIVERTER 2	ROTOR STOP	DIVERTER 3
12 ACTIVE FLOAT	DIVERTER 3	VALVE BANK	DIVERTER 4
13 SLEW / TELE SWAP	DIVERTER 4	LIFT FLOAT	DIVERTER 5
14 AUTO RESET	DIVERTER 5	ANGLE FLOAT	ACTIVE FLOAT

Option Option Selected Option Option

VALVE 2 ACTIVATION / DE-ACTIVATION

B1 B2 B4
B3 ✓

ON / OFF
OFF / ON

WARNING SOUND ON/OFF

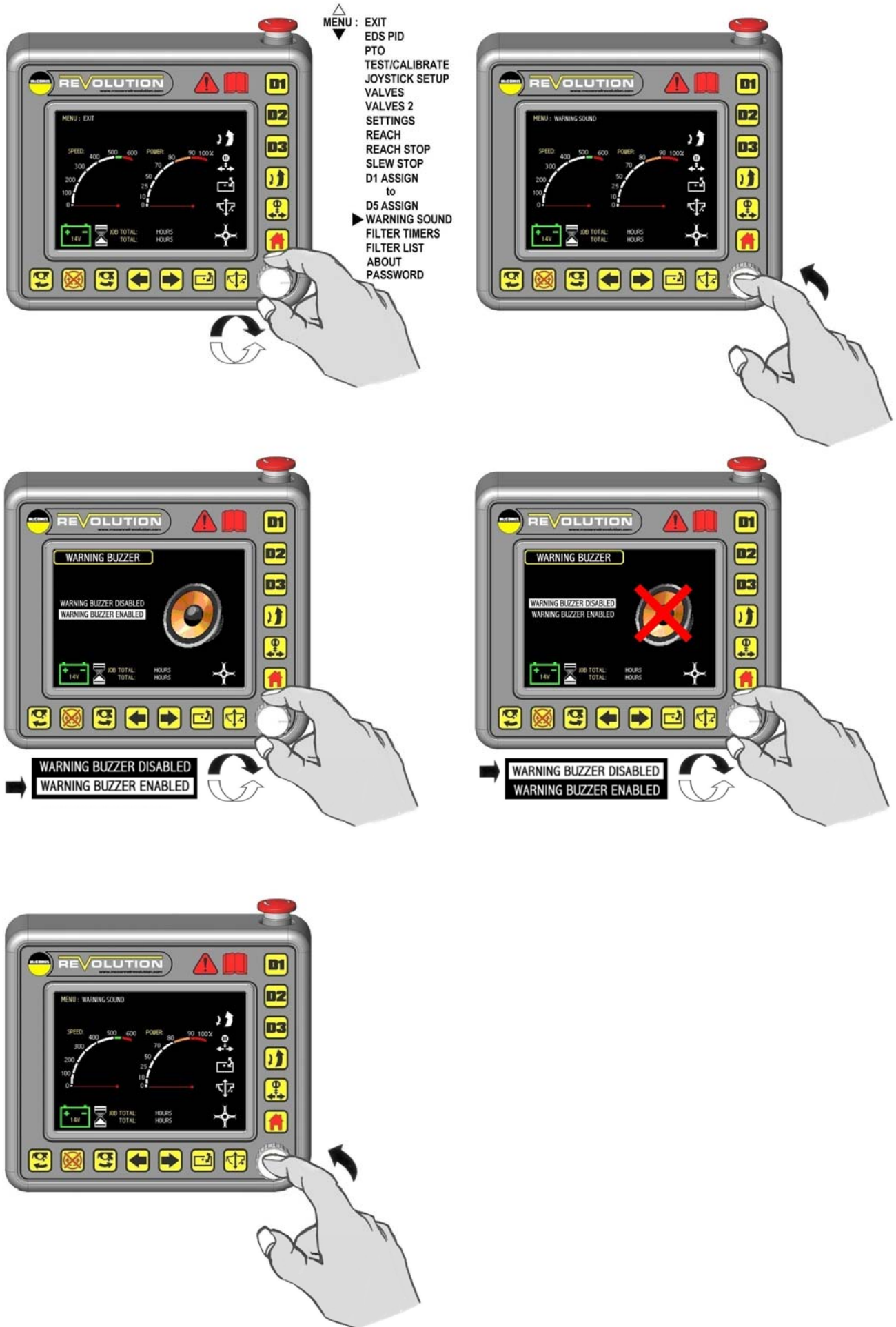

FILTER TIMER WARNINGS & RESET – Initial Filter (12 Hours)

MENU : FILTER TIMER

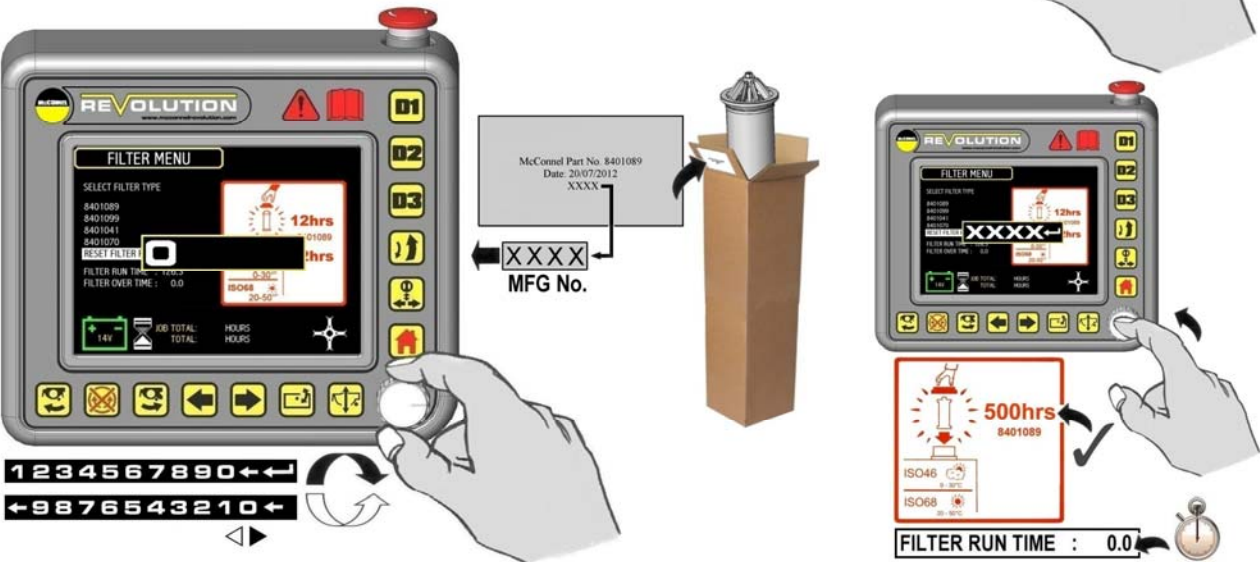
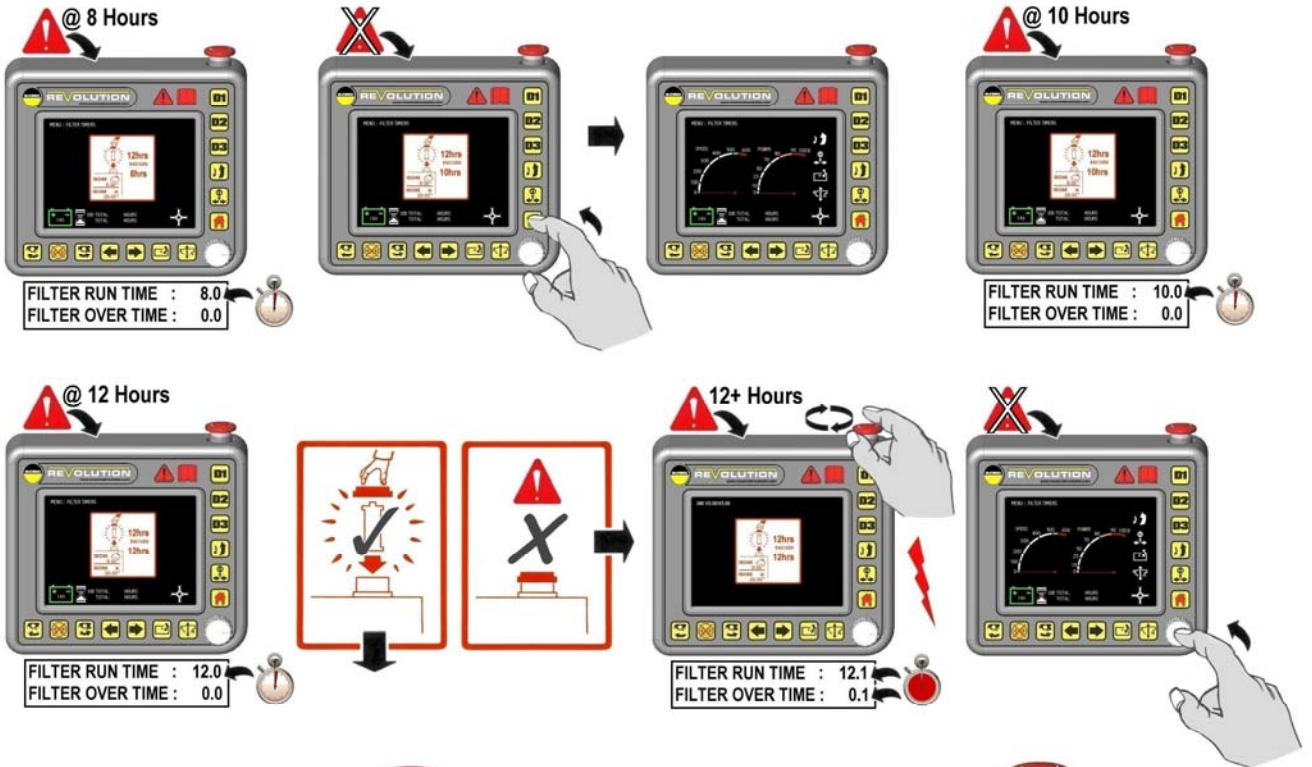

FILTER TIMER WARNINGS & RESET – Replacement Filters (500 Hours)

MENU : FILTER TIMER

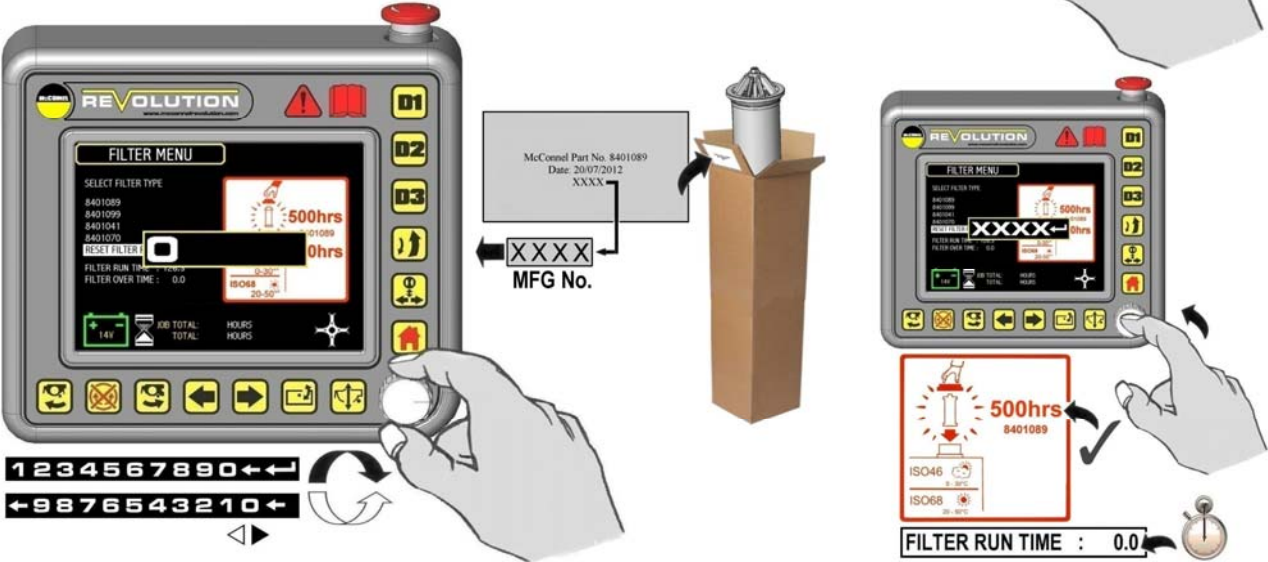
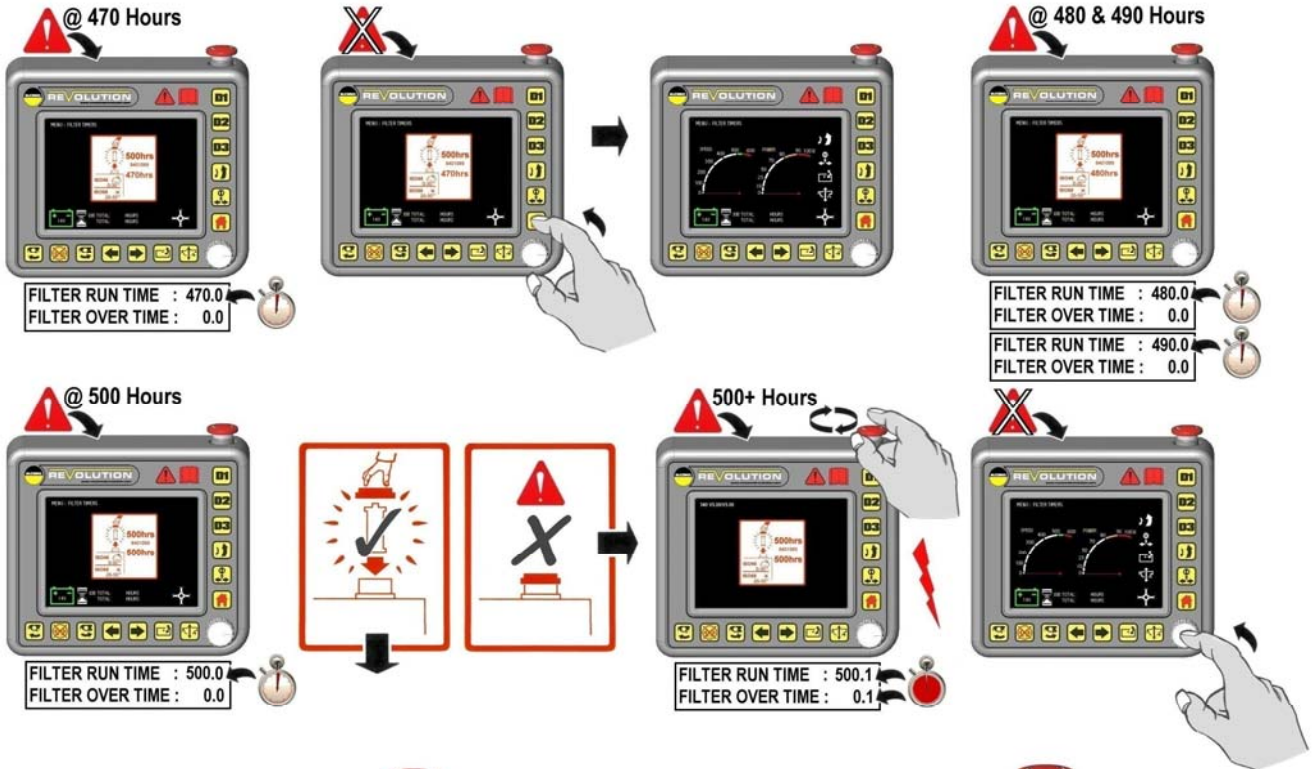

DISCONNECTED COMPONENT WARNINGS

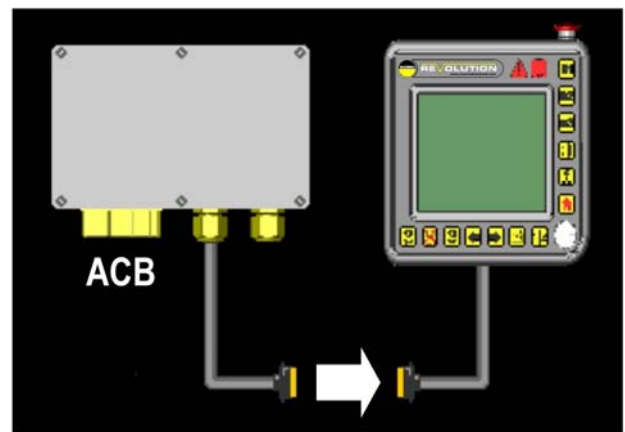
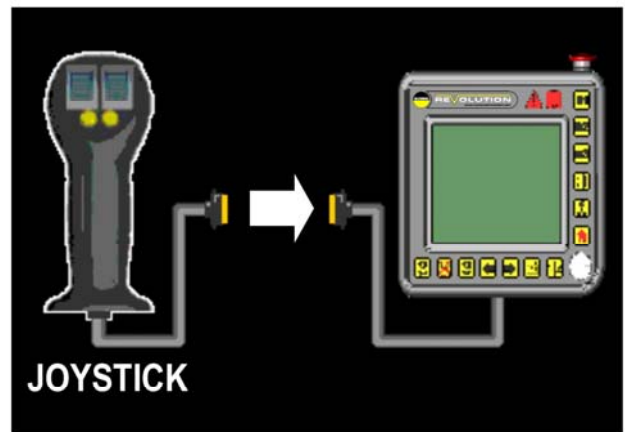

WORK SCREEN - SPEED & POWER WARNINGS



ENGLISH ◀▶ GERMAN

<p>ENGLISH</p> <p>WORK SCREEN</p> <p>1 SPEED 2 POWER 3 JOB TOTAL 4 TOTAL 5 OVER SPEED 6 OVER POWER</p> <p>JOYSTICK SCREEN</p> <p>1 SLEW 2 ANGLE 3 TELE 4 ACTIVE FLOAT 5 EDS FLOAT 6 SLEW/TELE SWAP 7 ACTIVE FLOAT 8 DIVERTER 1 9 DIVERTER 2 10 DIVERTER 3 11 AUTO RESET 12 LIFT FLOAT 13 HEAD FLOAT</p> <p>MENU TXT</p> <p>1 EXIT 2 PASSWORD 3 FILTER TIMERS 4 WARNING SOUNDS 5 D3 ASSIGN 6 D2 ASSIGN 7 D1 ASSIGN 8 SLEW STOP 9 REACH STOP 10 REACH 11 SETTINGS 12 VALVES 13 JOYSTICK SETUP 14 TEST / CALIBRATE 15 PTO 16 EDS (SETTINGS) PID</p> <p>FILTER MENU</p> <p>1 SELECT FILTER TYPE 2 RESET FILTER RUN TIME 3 FILTER RUN TIME 4 FILTER OVER TIME</p> <p>WARNING BUZZER</p> <p>1 WARNING BUZZER DISABLED 2 WARNING BUZZER ENABLED</p> <p>D3 ASSIGN</p> <p>1 HEAD ORBITOR 2 MIDCUT 3 VFR 4 HEAD ROTATOR 5 HYDRAULIC HOOD 6 HYDRAULIC ROLLER 7 TELE 8 HEAD ROTATOR 9 HYDRAULIC CHUTE 10 DEBRIS BLOWER 11 POWER BOOST</p> <p>SLEW STOP</p> <p>1 SET SLEW STOP 1 2 SET SLEW STOP 2 3 REMOVE STOPS</p> <p>REACH STOPS</p> <p>1 REACH STOP 1 2 SET REACH STOP 2 3 REMOVE STOPS</p> <p>SETTINGS</p> <p>1 POWER METER 2 PTO FITTED 3 XDUCER TYPE 4 MAX POWER 5 ROTOR REVERSE</p>	<p>DEUTSCH</p> <p>ARBEITSFENSTER</p> <p>1 DREHZAHL 2 LEISTUNG 3 AUFTRAGSTUNDEN 4 BETRIEBSSTUNDEN TOT 5 ÜBER DREHZAHL 6 ÜBERBELASTUNG</p> <p>JOYSTICK FENSTER</p> <p>1 ARM SCHWENKEN 2 KOPF DREHEN 3 TELESKOPIEREN 4 SCHWIMMSTELLUNG SCHALTER 5 EDS SCHWIMMSTELLUNG 6 SCHWENK/TELE. WECHSEL 7 SCHWIMMSTELLUNG SCHALTER 8 FUNKTIONWECHSEL 1 9 FUNKTIONWECHSEL 2 10 FUNKTIONWECHSEL 3 11 ANFAHRAUTOMATIK 12 SCHWIMMSTELLUNG ARM 13 SCHWIMMSTELLUNG KOPF</p> <p>MENU TEXT</p> <p>1 BEENDEN 2 KENNWORT 3 FILTER GEBRAUCHZEITEN 4 WARNTÖNE 5 D3 FUNKTION WAHL 6 D2 FUNKTION WAHL 7 D1 FUNKTION WAHL 8 ZWENKBEGRENZUNG 9 AUSLAGEBEGRENZUNG 10 AUSLAGE 11 EINSTELLUNGEN 12 VENTILE 13 JOYSTICK EINSTELLUNGEN 14 PROBE/KALIBRIERUNG 15 ZAPFWELLE 16 EDS EINSTELLUNGEN</p> <p>FILTER MENU</p> <p>1 TYP WAHLEN 2 RESET GEBRAUCHZEIT 3 GEBRAUCHZEIT 4 ÜBERSCHREITUNG</p> <p>WARNTON</p> <p>1 AUSSCHALTEN 2 EINSCHALTEN</p> <p>D3 AUSWAHL</p> <p>1 KOPF NEIGUNG 2 VORN VERSETZTEN ARM 3 EINSTELBARE VORN VERSETZTEN ARM 4 KOPF DREHTISCH 5 FRONTHAUBE VERSTELLUNG 6 STÜTZWALZE VERSTELLUNG 7 TELESKOPIEREN 8 KOPF DREHTISCH 9 AUSWURF VERSTELLUNG 10 GEBLÄSE 11 STEUER GESCHWINDIGKEIT</p> <p>SCHWENKBEGRENZUNG</p> <p>1 EINST.BEGRENZUNG 1 2 EINST.BEGRENZUNG 2 3 BEGRENZUNGS FREIGABE</p> <p>AUSLAGEBEGRENZUNG</p> <p>1 EINST.BEGRENZUNG 1 2 EINST.BEGRENZUNG 2 3 BEGRENZUNGS FREIGABE</p> <p>EINSTELLUNGEN</p> <p>1 LEISTUNGS ANZEIGE 2 DREHZAHL ANGABE 3 SENSOR TYP 4 MAX.LEISTUNG 5 DREHZINN UMKEHREN</p>	<p>ENGLISH</p> <p>SETTINGS</p> <p>6 EDS PRO 7 REACH CALIB 8 SET REACH IN 9 SET REACH OUT 10 D1 / PROP 11 D2 / PROP 12 D3 / PROP 13 SLEW 2 14 RESET TO DEFAULT</p> <p>VALVES</p> <p>1 LIFT UP 2 LIFT DOWN 3 REACH IN 4 REACH OUT 5 ANLGE CW 6 ANGLE Ccw 7 TELE IN 8 TELE OUT 9 SLEW IN 10 SLEW OUT 11 DIV 1 IN 12 DIV 1 OUT 13 DIV 2 IN 14 DIV 2 OUT 15 SLEW 2 IN 16 SLEW 2 OUT</p> <p>JOYSTICK SETUP</p> <p>1 NORMAL 2 SWAP 3 THUMBWHEELS 4 ACTIVE FLOAT 5 SLEW / TELE SWAP 6 AUTO RESET 7 EDS FLOAT 8 LIFT FLOAT 9 HEAD FLOAT 10 DIVERTER 1 11 DIVERTER 2 12 DIVERTER 3</p> <p>TEST / CALIBRATE</p> <p>1 JOYSTICK 2 THUMBWHEEL 3 BUTTON 4 PTO SPEED 5 RCV PRESSURE 6 LIFT PRESSURE 7 REACH POSITION 8 CUTTER TOTAL 9 OVER SPEED 10 OVER POWER 11 ARM REST POWER 12 ACB POWER 13 FILTER TIME 14 FILTER OVER</p> <p>EDS (SETTINGS) PID</p> <p>1 ENABLE 2 DISABLE 3 FLOAT PRESSURE 4 SOFT 5 MED 6 HARD 7 REACH POSITION 8 OIL PRESSURE</p> <p>MISC</p> <p>1 ACB DISCONNECT 2 JS DISCONNECT 3 JS FAULT 4 ON 5 OFF 6 UPDATING ARM REST 7 UPDATING ACB 8 FAULT 9 PASSWORD 10 THUMB</p>	<p>DEUTSCH</p> <p>EINSTELLUNGEN</p> <p>6 ARM SCHWIMMSTELLUNG PRO 7 AUSLAGE KALIBRIEREN 8 EINST.AUSLAGE NAHE 9 EINST.AUSLAGE FERN 10 D1 / PROP 11 D2 / PROP 12 D3 / PROP 13 ZWENKUNG 2 14 FABRIKSEINSTELLUNG</p> <p>VENTILE</p> <p>1 HEBEN 2 ZENKEN 3 AUSLAGE EIN 4 AUSLAGE AUS 5 WINKEL RE 6 WINKEL LI 7 TELE EIN 8 TELE AUS 9 SCHWENK RE 10 SCHWENK LI 11 DIV 1 EIN 12 DIV 1 AUS 13 DIV 2 EIN 14 DIV 2 AUS 15 SCHWENK 2 RE 16 SCHWENK 2 LI</p> <p>JOYSTICK EINSTELLUNGEN</p> <p>1 NORMALE BEDIENUNG 2 INVERSIONS BEDIENUNG 3 DAUMENRAD 4 SCHWIMMSTELLUNG SCHALTER 5 SCHWENK/TELE WECHSEL 6 ANFAHRAUTOMATIK 7 EDS SCHWIMMSTELLUNG 8 SCHWIMMSTELLUNG ARM 9 SCHWIMMSTELLUNG KOPF 10 FUNKTIONWECHSEL 1 11 FUNKTIONWECHSEL 2 12 FUNKTIONWECHSEL 3</p> <p>TEST/KALIBRIERUNG</p> <p>1 JOYSTICK 2 DAUMENRAD 3 DRÜCKTASTE 4 ZAPFWELLE DREHZAHL 5 LEISTUNGS SENSOR 6 HEBEN SENSOR 7 AUSLAGE SENSOR 8 BETRIEBSSTUNDEN TOT. 9 ÜBER DREHZAHL. 10 ÜBERBELASTUNG 11 ARMLEHNE SPEISUNG 12 ACB SPEISUNG 13 FILTER STUNDEN 14 FILTER MEHR GEBRAUCH</p> <p>EDS EINSTELLUNG</p> <p>1 EINSCHALTEN 2 AUSSCHALTEN 3 SCHWIMMSTELLUNG DRÜCK 4 LEICHT 5 MITTEL 6 SCHWER 7 AUSLAGE POSITION 8 ÖL DRÜCK</p> <p>SONSTIGE</p> <p>1 ACB NICHT ANGESCHLOSSEN 2 JS NICHT ANGESCHLOSSEN 3 JS FEHLER 4 EIN 5 AUS 6 AKTUALISIEREN ARMLEHNE 7 AKTUALISIEREN ACB 8 STORUNG 9 KENNWORT 10 DAUMEN</p>
---	---	--	---

ENGLISH ◀▶ DUTCH

<p>ENGLISH</p> <p>WORK SCREEN</p> <p>1 SPEED 2 POWER 3 JOB TOTAL 4 TOTAL 5 OVER SPEED 6 OVER POWER</p> <p>JOYSTICK SCREEN</p> <p>1 SLEW 2 ANGLE 3 TELE 4 ACTIVE FLOAT 5 EDS FLOAT 6 SLEW/TELE SWAP 7 ACTIVE FLOAT 8 DIVERTER 1 9 DIVERTER 2 10 DIVERTER 3 11 AUTO RESET 12 LIFT FLOAT 13 HEAD FLOAT</p> <p>MENU TXT</p> <p>1 EXIT 2 PASSWORD 3 FILTER TIMERS 4 WARNING SOUNDS 5 D3 ASSIGN 6 D2 ASSIGN 7 D1 ASSIGN 8 SLEW STOP 9 REACH STOP 10 REACH 11 SETTINGS 12 VALVES 13 JOYSTICK SETUP 14 TEST / CALIBRATE 15 PTO 16 EDS (SETTINGS) PID</p> <p>FILTER MENU</p> <p>1 SELECT FILTER TYPE 2 RESET FILTER RUN TIME 3 FILTER RUN TIME 4 FILTER OVER TIME</p> <p>WARNING BUZZER</p> <p>1 WARNING BUZZER DISABLED 2 WARNING BUZZER ENABLED</p> <p>D3 ASSIGN</p> <p>1 HEAD ORBITOR 2 MIDCUT 3 VFR 4 HEAD ROTATOR 5 HYDRAULIC HOOD 6 HYDRAULIC ROLLER 7 TELE 8 HEAD ROTATOR 9 HYDRAULIC CHUTE 10 DEBRIS BLOWER 11 POWER BOOST</p> <p>SLEW STOP</p> <p>1 SET SLEW STOP 1 2 SET SLEW STOP 2 3 REMOVE STOPS</p> <p>REACH STOPS</p> <p>1 SET REACH STOP 1 2 SET REACH STOP 2 3 REMOVE STOPS</p> <p>SETTINGS</p> <p>1 POWER METER 2 PTO FITTED 3 XDUCER TYPE 4 MAX POWER 5 ROTOR REVERSE</p>	<p>NEDERLANDS</p> <p>WERK SCHERM</p> <p>1 TOERENTAL 2 BELASTING 3 WERKTELLER 4 BEDRIJFSUREN TOT 5 OVERTOEREN 6 OVERBELASTING</p> <p>JOYSTICK SCHERM</p> <p>1 ARM ZWENKEN 2 KOP DRAAIEN 3 TELESCOPEREN 4 ZWEEFSTAND SCHAKELAAR 5 ZWEEFSTAND EDS 6 ZWENK/TELE. WISSEL 7 ZWEEFSTAND SCHAKELAAR 8 FUNCTIEWISSEL 1 9 FUNCTIEWISSEL 2 10 FUNCTIEWISSEL 3 11 ACTIEVE AANRUBBEVEILIGING 12 ZWEEFSTAND ARM 13 ZWEEFSTAND KOP</p> <p>MENU TEKST</p> <p>1 EXIT 2 PASSWORD 3 FILTER TIMERS 4 WAARSCHUWINGS TONEN 5 D3 FUNCTIE 6 D2 FUNCTIE 7 D1 FUNCTIE 8 ZWENK BEGRENZING 9 REIKWIJDTE BEGRENZING 10 REIKWIJDTE 11 INSTELLINGEN 12 VENTIELEN 13 JOYSTICK INSTELLINGEN 14 TEST/CALIBREREN 15 AFTAKAS 16 EDS INSTELLINGEN</p> <p>FILTER MENU</p> <p>1 TYPE KIEZEN 2 RESET GEBRUIKSDUUR 3 GEBRUIKSDUUR 4 OVERSCHRIJDING</p> <p>ZOEMER</p> <p>1 UITSCHAKELEN 2 INSCHAKELEN</p> <p>D3 SELECTIE</p> <p>1 KOP NEIGING 2 NAAR VOOR VERZETTE ARM 3 VARIABELE VERZETTE ARM 4 DRAAITAFEL KOP 5 FRONTKAP VERSTELLING 6 LOOPROL VERSTELLING 7 TELESCOOP 8 DRAAITAFEL KOP 9 UITWORP VERSTELLING 10 BLADBLAZER 11 BESTURINGS SNELHEID</p> <p>ZWENK BEGRENZING</p> <p>1 INST.BEGRENZING 1 2 INST.BEGRENZING 2 3 BEGRENZINGEN VERWIJDEREN</p> <p>REIKWIJDTE BEGRENZING</p> <p>1 INST.BEGRENZING 1 2 INST.BEGRENZING 2 3 BEGRENZINGEN VERWIJDEREN</p> <p>INSTELLINGEN</p> <p>1 VERMOGEN INDICATOR 2 TOERENTAL WEERGAVE 3 SENSOR TYPE 4 MAX.VERMOGEN 5 DRAAIRICHTING OMKEREN</p>	<p>ENGLISH</p> <p>SETTINGS</p> <p>6 EDS PRO 7 REACH CALIB 8 SET REACH IN 9 SET REACH OUT 10 D1 / PROP 11 D2 / PROP 12 D3 / PROP 13 SLEW 2 14 RESET TO DEFAULT</p> <p>VALVES</p> <p>1 LIFT UP 2 LIFT DOWN 3 REACH IN 4 REACH OUT 5 ANLGE CW 6 ANGLE CCW 7 TELE IN 8 TELE OUT 9 SLEW IN 10 SLEW OUT 11 DIV 1 IN 12 DIV 1 OUT 13 DIV 2 IN 14 DIV 2 OUT 15 SLEW 2 IN 16 SLEW 2 OUT</p> <p>JOYSTICK SETUP</p> <p>1 NORMAL 2 SWAP 3 THUMBWHEELS 4 ACTIVE FLOAT 5 SLEW / TELE SWAP 6 AUTO RESET 7 EDS FLOAT 8 LIFT FLOAT 9 HEAD FLOAT 10 DIVERTER 1 11 DIVERTER 2 12 DIVERTER 3</p> <p>TEST / CALIBRATE</p> <p>1 JOYSTICK 2 THUMBWHEEL 3 BUTTON 4 PTO SPEED 5 RCV PRESSURE 6 LIFT PRESSURE 7 REACH POSITION 8 CUTTER TOTAL 9 OVER SPEED 10 OVER POWER 11 ARM REST POWER 12 ACB POWER 13 FILTER TIME 14 FILTER OVER</p> <p>EDS (SETTINGS) PID</p> <p>1 ENABLE 2 DISABLE 3 FLOAT PRESSURE 4 SOFT 5 MED 6 HARD 7 REACH POSITION 8 OIL PRESSURE</p> <p>MISC</p> <p>1 ACB DISCONNECT 2 JS DISCONNECT 3 JS FAULT 4 ON 5 OFF 6 UPDATING ARM REST 7 UPDATING ACB 8 FAULT 9 PASSWORD 10 THUMB</p>	<p>NEDERLANDS</p> <p>INSTELLINGEN</p> <p>6 ZWEEFSTAND ARM PRO 7 REIKWIJDTE CALIBREREN 8 INST. REIKWIJDTE IN 9 INST. REIKWIJDTE UIT 10 D1 / PROP 11 D2 / PROP 12 D3 / PROP 13 ZWENKEN 2 14 FABRIEKINSTELLINGEN</p> <p>VENTIELEN</p> <p>1 HEFFEN 2 ZAKKEN 3 REIKWIJDTE IN 4 REIKWIJDTE UIT 5 DRAAIEN RE 6 DRAAIEN LI 7 TELE IN 8 TELE UIT 9 ZWENKEN RE 10 ZWENKEN LI 11 DIV 1 AAN 12 DIV 1 UIT 13 DIV 2 AAN 14 DIV 2 UIT 15 ZWENKEN 2 RE 16 ZWENKEN 2 LI</p> <p>JOYSTICK INSTELLINGEN</p> <p>1 NORMAAL BEDIENING 2 INVERSIE BEDIENING 3 ROL KNOP 4 ZWEEFSTAND SCHAKELAAR 5 ZWENK/TELE WISSEL 6 ACTIEVE AANRUBBEVEILIGING 7 ZWEEFSTAND EDS 8 ZWEEFSTAND ARM 9 ZWEEFSTAND KOP 10 FUNKTIEWISSEL 1 11 FUNKTIEWISSEL 2 12 FUNKTIEWISSEL 3</p> <p>TEST/KALIBREREN</p> <p>1 JOYSTICK 2 ROL KNOP 3 DRUK KNOP 4 AFTAKAS TOEREN 5 POWER SENSOR 6 HEF SENSOR 7 REIKWIJDTE SENSOR 8 BEDRIJFUREN TOT. 9 OVERTOEREN 10 OVERBELASTING 11 BEDIENINGS VOEDING 12 ACB VOEDING 13 FILTER UREN 14 FILTER MEER GEBRUIK</p> <p>EDS INSTELLINGEN</p> <p>1 INSCHAKELEN 2 UITSCHAKELEN 3 ZWEEFSTAND DRUK 4 ZACHT 5 MEDIUM 6 HARD 7 REIKWIJDTE POSITIE 8 OLIE DRUK</p> <p>DIVERSE</p> <p>1 ACB NIET AANGESLOTEN 2 JS NIET AANGESLOTEN 3 JS FOUT 4 AAN 5 UIT 6 UPDATEN ARM 7 UPDATEN ACB 8 STORING 9 PASSWORD 10 DUIM</p>
---	--	--	---

ENGLISH ◀▶ FRENCH

<p>ENGLISH</p> <p>WORK SCREEN</p> <p>1 SPEED 2 POWER 3 JOB TOTAL 4 TOTAL 5 OVER SPEED 6 OVER POWER</p> <p>JOYSTICK SCREEN</p> <p>1 SLEW 2 ANGLE 3 TELE 4 ACTIVE FLOAT 5 EDS FLOAT 6 SLEW/TELE SWAP 7 ACTIVE FLOAT 8 DIVERTER 1 9 DIVERTER 2 10 DIVERTER 3 11 AUTO RESET 12 LIFT FLOAT 13 HEAD FLOAT</p> <p>MENU TXT</p> <p>1 EXIT 2 PASSWORD 3 FILTER TIMERS 4 WARNING SOUNDS 5 D3 ASSIGN 6 D2 ASSIGN 7 D1 ASSIGN 8 SLEW STOP 9 REACH STOP 10 REACH 11 SETTINGS 12 VALVES 13 JOYSTICK SETUP 14 TEST / CALIBRATE 15 PTO 16 EDS (SETTINGS) PID</p> <p>FILTER MENU</p> <p>1 SELECT FILTER TYPE 2 RESET FILTER RUN TIME 3 FILTER RUN TIME 4 FILTER OVER TIME</p> <p>WARNING BUZZER</p> <p>1 WARNING BUZZER DISABLED 2 WARNING BUZZER ENABLED</p> <p>D3 ASSIGN</p> <p>1 HEAD ORBITOR 2 MIDCUT 3 VFR 4 HEAD ROTATOR 5 HYDRAULIC HOOD 6 HYDRAULIC ROLLER 7 TELE 8 HEAD ROTATOR 9 HYDRAULIC CHUTE 10 DEBRIS BLOWER 11 POWER BOOST</p> <p>SLEW STOP</p> <p>1 SET SLEW STOP 1 2 SET SLEW STOP 2 3 REMOVE STOPS</p> <p>REACH STOPS</p> <p>1 SET REACH STOP 1 2 SET REACH STOP 2 3 REMOVE STOPS</p> <p>SETTINGS</p> <p>1 POWER METER 2 PTO FITTED 3 XDUCER TYPE 4 MAX POWER 5 ROTOR REVERSE</p>	<p>FRENCH</p> <p>WORK SCREEN</p> <p>1 VITESSE 2 PUISSANCE 3 HEURES TOTALES 4 TOTALE 5 SURREGIME 6 SURPUISSANCE</p> <p>JOYSTICK SCREEN</p> <p>1 BALAYAGE 2 ANGLE 3 TELESCOPIQUE 4 FLOTAISON ACTIVE 5 FLOTAISON EDS 6 INVERSION BALAYAGE/TELESCOPIQUE 7 FLOTAISON ACTIVE 8 VARIANTE 1 9 VARIANTE 2 10 VARIANTE 3 11 RETOUR AUTO 12 FLOTAISON LEVEE 13 FLOTAISON TETE</p> <p>MENU TXT</p> <p>1 SORTIE 2 MOT DE PASSE 3 PARAMETRES DE FILTRATION 4 SONS D'AVERTISSEMENT 5 ASSIGNER D1 6 ASSIGNER D2 7 ASSIGNER D3 8 ARRET BALAYAGE 9 ARRET PORTEE 10 PORTEE 11 REGLAGES 12 VALVES 13 INSTALLATION JOYSTICK 14 TEST 15 PRISE DE FORCE 16 EDS PID</p> <p>FILTER MENU</p> <p>1 SELECTIONNER TYPE FILTRE 2 REMISE A ZERO DU TEMPS DE FILTRATION 3 TEMPS DE FILTRATION 4 DEPASSEMENT DU TEMPS DE FILTRATION</p> <p>WARNING BUZZER</p> <p>1 SONNERIE D'AVERTISSEMENT ACTIVE 2 SONNERIE D'AVERTISSEMENT DESACTIVE</p> <p>D3 ASSIGN</p> <p>1 TETE ORBITEUR 2 MIDCUT OU BRAS AVANCE 3 VFR 4 TETE ROTATIVE 5 CAPOT HYDRAULIQUE 6 ROULEAU HYDRAULIQUE 7 TELESCOPIQUE 8 TETE ROTATIVE 9 CANAL HYDRAULIQUE 10 SOUFFLEUR DEBRIS 11 AUGMENTER PUISSANCE</p> <p>SLEW STOP</p> <p>1 ARRET BALAYAGE 1 ACTIVE 2 ARRET BALAYAGE 2 ACTIVE 3 ENLEVER ARRET BALAYAGE</p> <p>REACH STOPS</p> <p>1 REGLAGE ARRET PORTEE 1 2 REGLAGE ARRET PORTEE 2 3 ENLEVER ARRET PORTEE</p> <p>SETTINGS</p> <p>1 TAUX DE CHARGE 2 REGIME PDF 3 TYPE DE REDUCTEUR 4 PUISSANCE MAX 5 INVERSION ROTOR</p>	<p>ENGLISH</p> <p>SETTINGS</p> <p>6 EDS PRO 7 REACH CALIB 8 SET REACH IN 9 SET REACH OUT 10 D1 / PROP 11 D2 / PROP 12 D3 / PROP 13 SLEW 2 14 RESET TO DEFAULT</p> <p>VALVES</p> <p>1 LIFT UP 2 LIFT DOWN 3 REACH IN 4 REACH OUT 5 ANLGE CW 6 ANGLE CCW 7 TELE IN 8 TELE OUT 9 SLEW IN 10 SLEW OUT 11 DIV 1 IN 12 DIV 1 OUT 13 DIV 2 IN 14 DIV 2 OUT 15 SLEW 2 IN 16 SLEW 2 OUT</p> <p>JOYSTICK SETUP</p> <p>1 NORMAL 2 SWAP 3 THUMBWHEELS 4 ACTIVE FLOAT 5 SLEW / TELE SWAP 6 AUTO RESET 7 EDS FLOAT 8 LIFT FLOAT 9 HEAD FLOAT 10 DIVERTER 1 11 DIVERTER 2 12 DIVERTER 3</p> <p>TEST / CALIBRATE</p> <p>1 JOYSTICK 2 THUMBWHEEL 3 BUTTON 4 PTO SPEED 5 RCV PRESSURE 6 LIFT PRESSURE 7 REACH POSITION 8 CUTTER TOTAL 9 OVER SPEED 10 OVER POWER 11 ARM REST POWER 12 ACB POWER 13 FILTER TIME 14 FILTER OVER</p> <p>EDS (SETTINGS) PID</p> <p>1 ENABLE 2 DISABLE 3 FLOAT PRESSURE 4 SOFT 5 MED 6 HARD 7 REACH POSITION 8 OIL PRESSURE</p> <p>MISC</p> <p>1 ACB DISCONNECT 2 JS DISCONNECT 3 JS FAULT 4 ON 5 OFF 6 UPDATING ARM REST 7 UPDATING ACB 8 FAULT 9 PASSWORD 10 THUMB</p>	<p>FRENCH</p> <p>SETTINGS</p> <p>6 EDS PRO 7 CALBRAGE DE LA PORTEE 8 REGLAGE RAPROCHEMT 9 REGLAGE ECARTEMENT 10 D1 PROPORTIONELLE 11 D2 PROPORTIONELLE 12 D3 PROPORTIONELLE 13 BALAYAGE 2 14 RETOUR AUX REGLAGE USINE</p> <p>VALVES</p> <p>1 LEVEE 2 DESCENTE 3 RAPROCHEMENT 4 ECARTEMENT 5 ANLGE SENS H 6 ANGLE ANTI H 7 RENTRE TELES 8 SORTIE TELES 9 RENTRE BALAY 10 SORTIE BALAY 11 RENTRE DIV 1 12 SORTIE DIV 1 13 RENTRE DIV 2 14 SORTIE DIV 2 15 RENTRE BALAY 2 16 SORTIE BALAY 2</p> <p>JOYSTICK SETUP</p> <p>1 CONTROL NORMAL 2 CONTROL INVERSION 3 MOLETTE 4 FLOTAISON ACTIVE 5 INVERSION BALAYAGE/TELESCOPIQUE 6 RETOUR AUTO 7 FLOTAISON EDS 8 FLOTAISON LEVEE 9 FLOTAISON TETE 10 VARIANTE 1 11 VARIANTE 2 12 VARIANTE 3</p> <p>TEST / CALIBRATE</p> <p>1 JOYSTICK 2 MOLETTE 3 BOUTON 4 VITESSE PRISE DE FORCE 5 PRESION RCV 6 PRESION LEVEE 7 POSITION PORTEE 8 HEURES TOTALES 9 SURREGIME 10 SURPUISSANCE 11 ALIM ACCOUDOIR 12 ALIM CARTE ELEC 13 TEMPS DE FILTRATION 14 DEPASSEMENT DU TEMPS DE FILTRATION</p> <p>EDS (SETTINGS) PID</p> <p>1 ACTIVER 2 DESACTIVER 3 PRESSION FLOTAISON 4 SOUPLE 5 NORMAL 6 DUR 7 POSITION PORTEE 8 PRESION D'HUILE</p> <p>MISC</p> <p>1 ACB DECONNECTE 2 JS DECONNECTE 3 ERREUR JS 4 EN MARCHÉ 5 ARRET 6 MISE A JOUR ACCOUDOIR 7 MISE A JOUR CARTE ELEC 8 ERREUR 9 MOT DE PASSE 10 POUCE</p>
---	---	--	---

ENGLISH ◀▶ DANISH

<p>ENGLISH WORK SCREEN</p> <p>1 SPEED 2 POWER 3 JOB TOTAL 4 TOTAL 5 OVER SPEED 6 OVER POWER</p> <p>JOYSTICK SCREEN</p> <p>1 SLEW 2 ANGLE 3 TELE 4 ACTIVE FLOAT 5 EDS FLOAT 6 SLEW/TELE SWAP 7 ACTIVE FLOAT 8 DIVERTER 1 9 DIVERTER 2 10 DIVERTER 3 11 AUTO RESET 12 LIFT FLOAT 13 HEAD FLOAT</p> <p>MENU TXT</p> <p>1 EXIT 2 PASSWORD 3 FILTER TIMERS 4 WARNING SOUNDS 5 D3 ASSIGN 6 D2 ASSIGN 7 D1 ASSIGN 8 SLEW STOP 9 REACH STOP 10 REACH 11 SETTINGS 12 VALVES 13 JOYSTICK SETUP 14 TEST / CALIBRATE 15 PTO 16 EDS (SETTINGS) PID</p> <p>FILTER MENU</p> <p>1 SELECT FILTER TYPE 2 RESET FILTER RUN TIME 3 FILTER RUN TIME 4 FILTER OVER TIME</p> <p>WARNING BUZZER</p> <p>1 WARNING BUZZER DISABLED 2 WARNING BUZZER ENABLED</p> <p>D3 ASSIGN</p> <p>1 HEAD ORBITOR 2 MIDCUT 3 VFR 4 HEAD ROTATOR 5 HYDRAULIC HOOD 6 HYDRAULIC ROLLER 7 TELE 8 HEAD ROTATOR 9 HYDRAULIC CHUTE 10 DEBRIS BLOWER 11 POWER BOOST</p> <p>SLEW STOP</p> <p>1 SET SLEW STOP 1 2 SET SLEW STOP 2 3 REMOVE STOPS</p> <p>REACH STOPS</p> <p>1 SET REACH STOP 1 2 SET REACH STOP 2 3 REMOVE STOPS</p> <p>SETTINGS</p> <p>1 POWER METER 2 PTO FITTED 3 XDUCER TYPE 4 MAX POWER 5 ROTOR REVERSE</p>	<p>DANISH WORK SCREEN</p> <p>1 2 3 KLIPPETIMER TOT. 4 5 OVER MAX. HASTIGHED 6 OVERBELASTNING</p> <p>JOYSTICK SCREEN</p> <p>1 2 3 4 5 6 SVING VÆKSEL 7 8 9 10 11 AUTORESET 12 FLYD ARM 13 FLYD SLAGLEHOVED</p> <p>MENU TXT</p> <p>1 EXIT 2 3 4 5 6 7 8 9 10 RÆKKEVIDDE 11 12 VENTILER 13 14 15 PTO. AKSEL 16 EDS PID</p> <p>FILTER MENU</p> <p>1 2 3 4</p> <p>WARNING BUZZER</p> <p>1 2</p> <p>D3 ASSIGN</p> <p>1 2 3 4 5 6 7 8 9 10 11</p> <p>SLEW STOP</p> <p>1 2 3</p> <p>REACH STOPS</p> <p>1 2 3</p> <p>SETTINGS</p> <p>1 KRAFT MÅLER 2 PTO. MONT. 3 XDUCER TYP 4 MAX. KRAFTFORBRUG 5 ROTOR REV.</p>	<p>ENGLISH SETTINGS</p> <p>6 EDS PRO 7 REACH CALIB 8 SET REACH IN 9 SET REACH OUT 10 D1 / PROP 11 D2 / PROP 12 D3 / PROP 13 SLEW 2 14 RESET TO DEFAULT</p> <p>VALVES</p> <p>1 LIFT UP 2 LIFT DOWN 3 REACH IN 4 REACH OUT 5 ANLGE CW 6 ANGLE CCW 7 TELE IN 8 TELE OUT 9 SLEW IN 10 SLEW OUT 11 DIV 1 IN 12 DIV 1 OUT 13 DIV 2 IN 14 DIV 2 OUT 15 SLEW 2 IN 16 SLEW 2 OUT</p> <p>JOYSTICK SETUP</p> <p>1 NORMAL 2 SWAP 3 THUMBWHEELS 4 ACTIVE FLOAT 5 SLEW / TELE SWAP 6 AUTO RESET 7 EDS FLOAT 8 LIFT FLOAT 9 HEAD FLOAT 10 DIVERTER 1 11 DIVERTER 2 12 DIVERTER 3</p> <p>TEST / CALIBRATE</p> <p>1 JOYSTICK 2 THUMBWHEEL 3 BUTTON 4 PTO SPEED 5 RCV PRESSURE 6 LIFT PRESSURE 7 REACH POSITION 8 CUTTER TOTAL 9 OVER SPEED 10 OVER POWER 11 ARM REST POWER 12 ACB POWER 13 FILTER TIME 14 FILTER OVER</p> <p>EDS (SETTINGS) PID</p> <p>1 ENABLE 2 DISABLE 3 FLOAT PRESSURE 4 SOFT 5 MED 6 HARD 7 REACH POSITION 8 OIL PRESSURE</p> <p>MISC</p> <p>1 ACB DISCONNECT 2 JS DISCONNECT 3 JS FAULT 4 ON 5 OFF 6 UPDATING ARM REST 7 UPDATING ACB 8 FAULT 9 PASSWORD 10 THUMB</p>	<p>DANISH SETTINGS</p> <p>6 7 8 INDST. RÆKKEVIDDE IND 9 INDST. RÆKKEVIDDE UD 10 11 12 13 14 RESET VED FEJL</p> <p>VALVES</p> <p>1 LØFT OP 2 LØFT NED 3 RÆKKEVIDDE IND 4 RÆKKEVIDDE UD 5 SLAGLE VINKL. H 6 SLAGLE VINKL. V. 7 TELESKOB IND 8 TELESKOB UD 9 SVING IND 10 SVING UD 11 12 13 14</p> <p>JOYSTICK SETUP</p> <p>1 FABRIKS INST. 2 OMSKIFT KONTROLFUNK. 3 RULLEKONTAKTER 4 5 SVING VÆKSEL 6 AUTORESET 7 8 FLYD ARM 9 FLYD SLAGLEHOVED 10 11 12</p> <p>TEST / CALIBRATE</p> <p>1 JOYSTICK 2 3 4 5 6 7 8 KLIPPETIMER TOT. 9 OVER MAX. HASTIGHED 10 OVERBELASTNING 11 ARM KRAFT 12 ACB KRAFT 13 14</p> <p>EDS (SETTINGS) PID</p> <p>1 2 3 4 BLØD 5 MEDIUM 6 HARD 7 8</p> <p>MISC</p> <p>1 ACB AFBRUDT 2 JS AFBRUDT 3 JS FEJL 4 5 6 7 8 9 10 11 12 13 14 OPDATERER ARMLÆN OPDATERER ACB FEJL KODEORD TOMMELTOT</p>
--	--	---	---

ENGLISH ◀▶ SPANISH

<p>ENGLISH</p> <p>WORK SCREEN</p> <p>1 SPEED 2 POWER 3 JOB TOTAL 4 TOTAL 5 OVER SPEED 6 OVER POWER</p> <p>JOYSTICK SCREEN</p> <p>1 SLEW 2 ANGLE 3 TELE 4 ACTIVE FLOAT 5 EDS FLOAT 6 SLEW/TELE SWAP 7 ACTIVE FLOAT 8 DIVERTER 1 9 DIVERTER 2 10 DIVERTER 3 11 AUTO RESET 12 LIFT FLOAT 13 HEAD FLOAT</p> <p>MENU TXT</p> <p>1 EXIT 2 PASSWORD 3 FILTER TIMERS 4 WARNING SOUNDS 5 D3 ASSIGN 6 D2 ASSIGN 7 D1 ASSIGN 8 SLEW STOP 9 REACH STOP 10 REACH 11 SETTINGS 12 VALVES 13 JOYSTICK SETUP 14 TEST / CALIBRATE 15 PTO 16 EDS (SETTINGS) PID</p> <p>FILTER MENU</p> <p>1 SELECT FILTER TYPE 2 RESET FILTER RUN TIME 3 FILTER RUN TIME 4 FILTER OVER TIME</p> <p>WARNING BUZZER</p> <p>1 WARNING BUZZER DISABLED 2 WARNING BUZZER ENABLED</p> <p>D3 ASSIGN</p> <p>1 HEAD ORBITOR 2 MIDCUT 3 VFR 4 HEAD ROTATOR 5 HYDRAULIC HOOD 6 HYDRAULIC ROLLER 7 TELE 8 HEAD ROTATOR 9 HYDRAULIC CHUTE 10 DEBRIS BLOWER 11 POWER BOOST</p> <p>SLEW STOP</p> <p>1 SET SLEW STOP 1 2 SET SLEW STOP 2 3 REMOVE STOPS</p> <p>REACH STOPS</p> <p>1 SET REACH STOP 1 2 SET REACH STOP 2 3 REMOVE STOPS</p> <p>SETTINGS</p> <p>1 POWER METER 2 PTO FITTED 3 XDUCER TYPE 4 MAX POWER 5 ROTOR REVERSE</p>	<p>SPANISH</p> <p>WORK SCREEN</p> <p>1 VELOCIDAD 2 POTENCIA 3 HORAS TOTALES 4 TOTAL 5 SOBRE VELOCIDAD 6 SOBRE POTENCIA</p> <p>JOYSTICK SCREEN</p> <p>1 GIRO 2 ANGULO 3 TELESCOPICO 4 FLOTANTE ACTIVA 5 FLOTANTE EDS 6 GIRO/TELESCOPICO 7 FLOTANTE ACTIVA 8 DESVIADOR 1 9 DESVIADOR 2 10 DESVIADOR 3 11 REINILIZACION AUTO 12 ELEVACION FLOTANTE 13 CABEZAL FLOTANTE</p> <p>MENU TXT</p> <p>1 SALIDA 2 CLAVE DE ACCESO 3 TEMPORIZADOR DEL FILTRO 4 SONIDO DE AVERTENCIA 5 ASIGNAR D1 6 ASIGNAR D2 7 ASIGNAR D3 8 PARADA DE GIRO 9 PARADA DE ALCANCE 10 ALCANCE 11 CONFIGURACIONES 12 VALVULAS 13 INSTALACION JOYSTICK 14 PRUEBA 15 POTENCIA DE ARRANQUE 16 EDS PID</p> <p>FILTER MENU</p> <p>1 ELEGIR TIPO DE FILTRO 2 REINICIAR TIEMPO FILTRANTE 3 TIEMPO FILTRANTE 4 FUERA DEL TIEMPO FILTRANTE</p> <p>WARNING BUZZER</p> <p>1 ALARMA DE ADVERTENCIA ACTIVADA 2 ALARMA DE ADVERTENCIA DESACTIVADA</p> <p>D3 ASSIGN</p> <p>1 CABEZA ORBITADOR 2 MIDCUT O BRAZO AVANZADO 3 VFR 4 CABEZA ROTATIVA 5 CAPO HIDRAULICO 6 RODILLO HIDRAULICO 7 TELESCOPICO 8 CABEZA ROTATIVA 9 CANAL HIDRAULICO 10 SOPLADOR DESECHOS 11 AUMENTAR POTENCIA</p> <p>SLEW STOP</p> <p>1 PARADA DE GIRO 1 2 PARADA DE GIRO 2 3 QUITAR PARADAS</p> <p>REACH STOPS</p> <p>1 REGLAJE PARADA DE ALCANCE 2 REGLAJE PARADA DE ALCANCE 3 QUITAR LAS PARADAS</p> <p>SETTINGS</p> <p>1 MEDIDOR DE POTENCIA 2 POTENCIA DE ARRANQUE MONTADA 3 TIPO DE XDUCER 4 POTENCIA MAX 5 INVERSION ROTOR</p>	<p>ENGLISH</p> <p>SETTINGS</p> <p>6 EDS PRO 7 REACH CALIB 8 SET REACH IN 9 SET REACH OUT 10 D1 / PROP 11 D2 / PROP 12 D3 / PROP 13 SLEW 2 14 RESET TO DEFAULT</p> <p>VALVES</p> <p>1 LIFT UP 2 LIFT DOWN 3 REACH IN 4 REACH OUT 5 ANLGE CW 6 ANGLE CCW 7 TELE IN 8 TELE OUT 9 SLEW IN 10 SLEW OUT 11 DIV 1 IN 12 DIV 1 OUT 13 DIV 2 IN 14 DIV 2 OUT 15 SLEW 2 IN 16 SLEW 2 OUT</p> <p>JOYSTICK SETUP</p> <p>1 NORMAL 2 SWAP 3 THUMBWHEELS 4 ACTIVE FLOAT 5 SLEW / TELE SWAP 6 AUTO RESET 7 EDS FLOAT 8 LIFT FLOAT 9 HEAD FLOAT 10 DIVERTER 1 11 DIVERTER 2 12 DIVERTER 3</p> <p>TEST / CALIBRATE</p> <p>1 JOYSTICK 2 THUMBWHEEL 3 BUTTON 4 PTO SPEED 5 RCV PRESSURE 6 LIFT PRESSURE 7 REACH POSITION 8 CUTTER TOTAL 9 OVER SPEED 10 OVER POWER 11 ARM REST POWER 12 ACB POWER 13 FILTER TIME 14 FILTER OVER</p> <p>EDS (SETTINGS) PID</p> <p>1 ENABLE 2 DISABLE 3 FLOAT PRESSURE 4 SOFT 5 MED 6 HARD 7 REACH POSITION 8 OIL PRESSURE</p> <p>MISC</p> <p>1 ACB DISCONNECT 2 JS DISCONNECT 3 JS FAULT 4 ON 5 OFF 6 UPDATING ARM REST 7 UPDATING ACB 8 FAULT 9 PASSWORD 10 THUMB</p>	<p>SPANISH</p> <p>SETTINGS</p> <p>6 EDS PRO 7 CALIBRACION DE ALCANCE 8 ALCANCE MINIMO 9 ALCANCE MAXIMO 10 D1 PROPORCIONAL 11 D2 PROPORCIONAL 12 D3 PROPORCIONAL 13 GIRO 2 14 OPCION POR DEFECTO</p> <p>VALVES</p> <p>1 LEVANTAR 2 BAJAR 3 ALCANCE MINIMO 4 ALCANCE MAXIMO 5 ANGULO SENTIDO DE LAS AGUJAS DEL RELOJ 6 ANGULO SENTIDO CONTRARIO 7 ENTRADA TELESCOPICO 8 SALIDA TELESCOPICO 9 ENTRADA GIRO 10 SALIDA GIRO 11 ENTRADA DIV 1 12 SALIDA DIV 1 13 ENTRADA DIV 2 14 SALIDA DIV 2 15 ENTRADA GIRO 2 16 SALIDA GIRO 2</p> <p>JOYSTICK SETUP</p> <p>1 MANDO NORMAL 2 MANDO INVERSO 3 MANDO PULGAR 4 FLOTANTE ACTIVA 5 INVERSION GIRO/TELESCOPICO 6 REINICIALIZACION AUTOMATICO 7 FLOTANTE EDS 8 ELEVACION FLOTANTE 9 CABEZA FLOTANTE 10 DEVIANTE 1 11 DEVIANTE 2 12 DEVIANTE 3</p> <p>TEST / CALIBRATE</p> <p>1 JOYSTICK 2 MANDO PULGAR 3 BOTON 4 VELOCIDAD POTENCIA DE ARRANQUE 5 PRESION RCV 6 INVERSION ELEVACION 7 POSICION ALCANCE 8 HORAS TOTALES 9 SOBRE VELOCIDAD 10 SOBRE POTENCIA 11 POTENCIA APOYABRAZO 12 POTENCIA ACB 13 TIEMPO FILTRANTE 14 FUERA DEL TIEMPO FILTRANTE</p> <p>EDS (SETTINGS) PID</p> <p>1 ENCENDER 2 DESCONECTAR 3 PRESION FLOTANTE 4 BLANDO 5 MEDIANO 6 DURO 7 POSICION ELEVACION 8 PRESION ACIETE</p> <p>MISC</p> <p>1 ACB DESONECTA 2 JS DESONECTA 3 ERROR JS 4 COMENZAR 5 APAGAR 6 ACTUALIZANDO APOYABRAZO 7 ACTUALIZANDO ACB 8 ERROR 9 CLAVE DE ACCESO 10 PULGAR</p>
---	---	--	---



McConnel Limited, Temeside Works, Ludlow, Shropshire SY8 1JL. England.
Telephone: 01584 873131. Facsimile: 01584 876463. www.mcconnel.com