

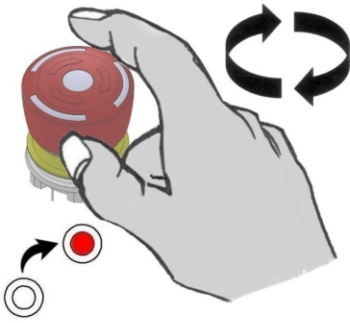

MINI MOTION STEUERELEMENTE  
Bedienungsanleitung  
VERSI Maschinen

# MINI MOTION STEUERELEMENTE

Power EIN



Power AUS / NOT-HALT

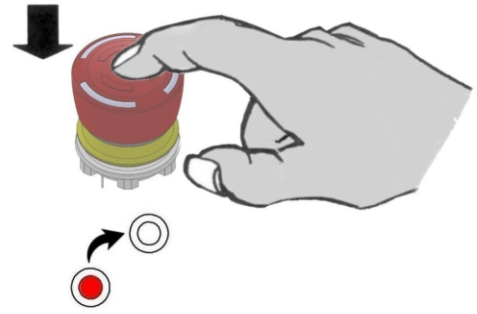

Standard-Steuerelement:  
 X-Achse: Heben Betrieb  
 Y-Achse: Auslage Betrieb  
 Z-Achse: Winkel Betrieb  
 B1+Z-Achse: Schwenk Betrieb  
 B2+Y-Achse: 5th Funktion

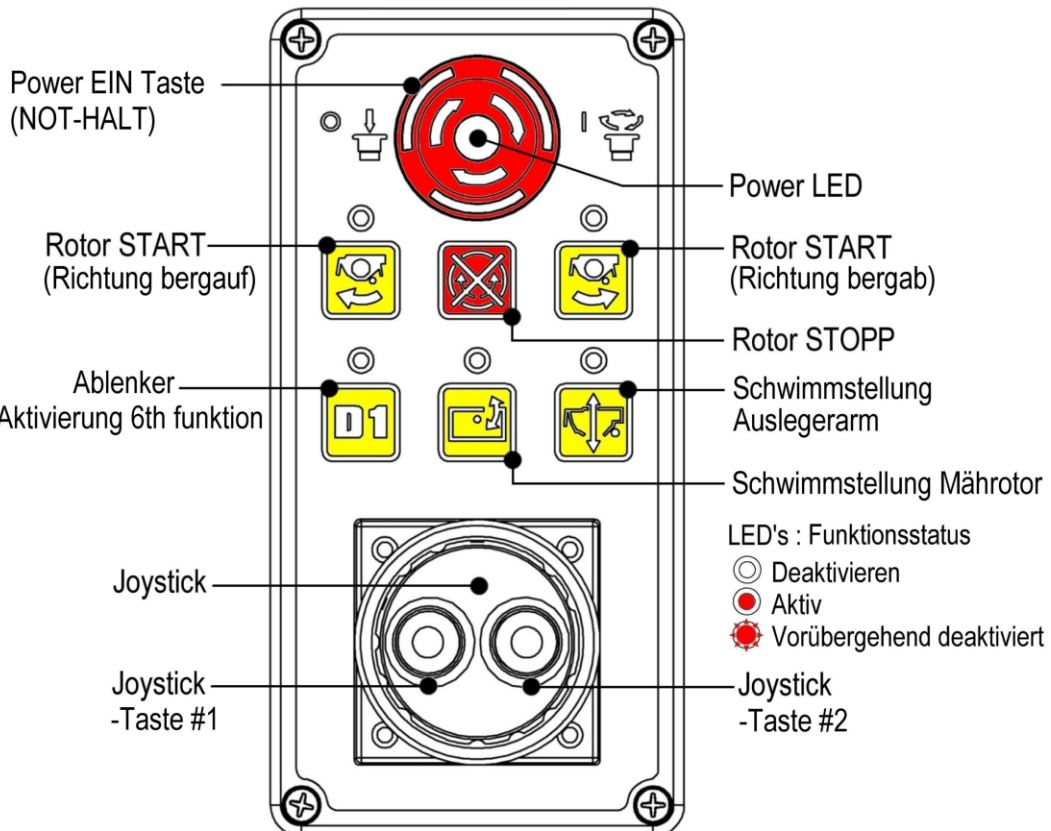
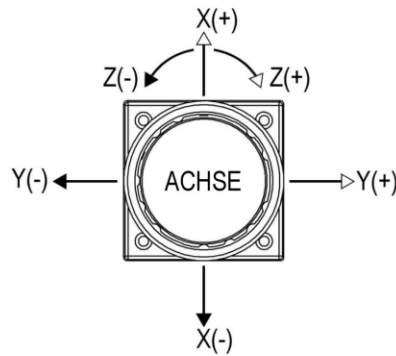

# Arm Bedienung Bedienelemente

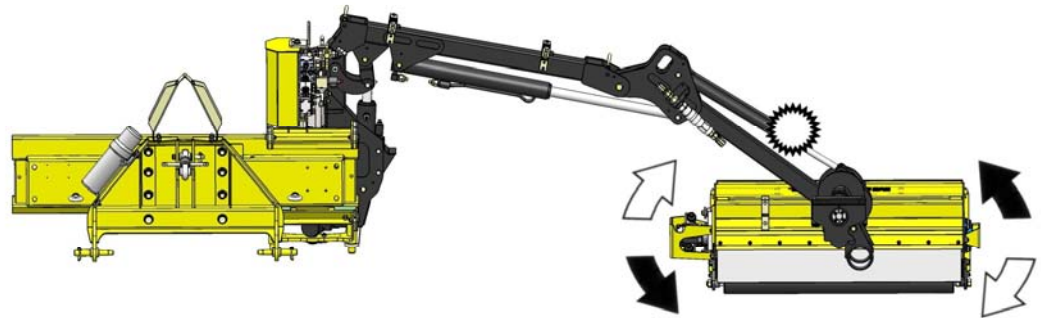
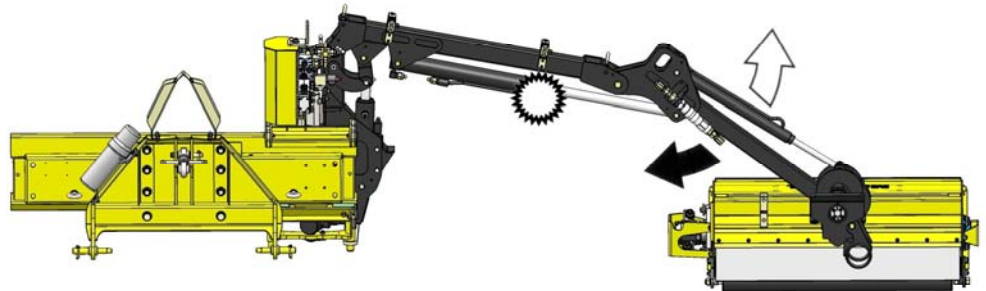
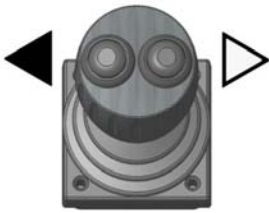
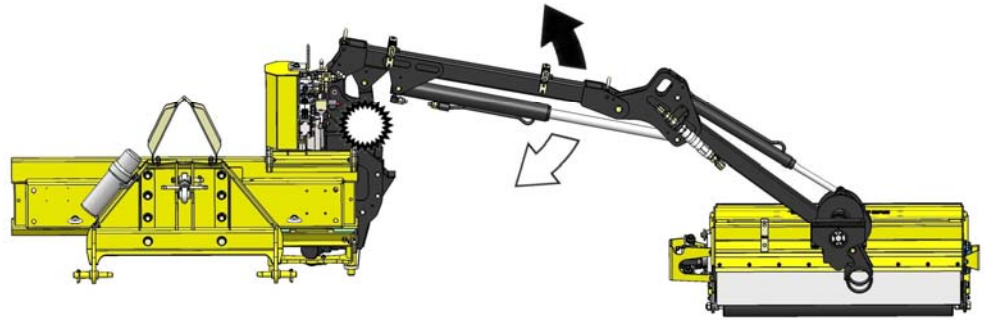



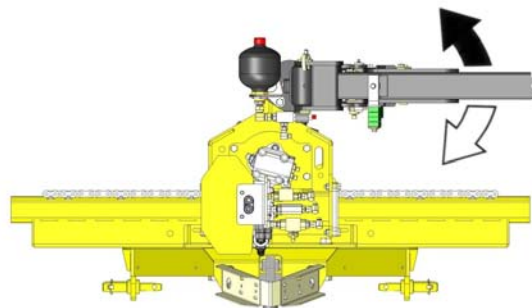



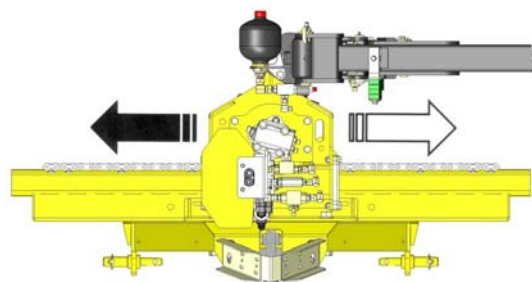
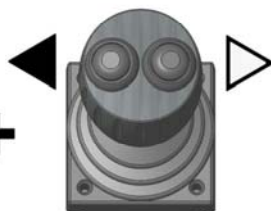

+



+



## Keypad Control Buttons

Button	Function	Control Operation
	Angle Float ON/OFF	Pressing the button will switch Angle Float function ON/OFF.
	Lift Float ON/ OFF	Pressing the button will switch Lift Float function ON/OFF.
	Rotor START (Uphill Direction).	Press to START rotor in uphill direction. <i>8 second delay for direction change.</i>
	Rotor START (Downhill Direction).	Press to start rotor in downhill direction. <i>8 second delay for direction change.</i>
	Rotor STOP.	Press to stop rotor. <i>Press first before direction change.</i>
	Diverter: 6 <sup>th</sup> Service Activation	Press to switch 6 <sup>th</sup> Service ON/OFF.
	Function status - OFF.	LED Light for specific control OFF.
	Function status - ON.	LED Light for specific control ON.
	Function status - Temporarily deactivated.	LED Light for specific control FLASHING.

# SCHWIMMSTELLUNG

## Freie Schleppenaufhängung EIN / AUS

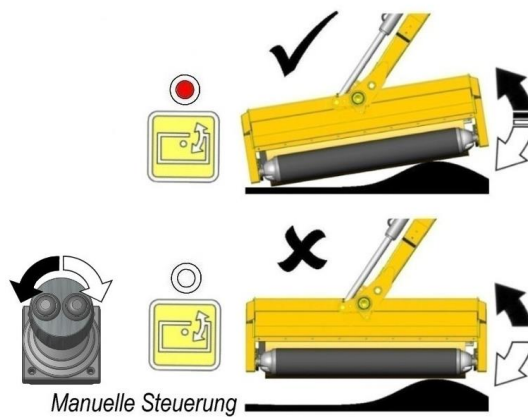
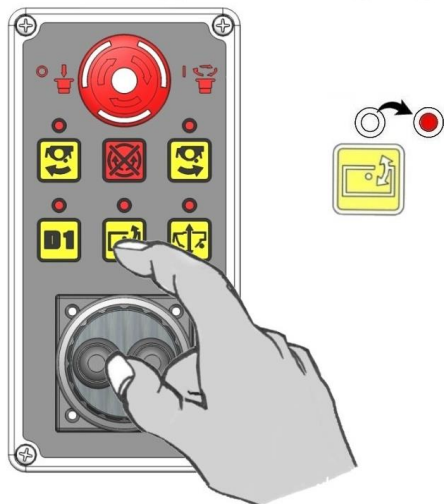

## Schleppe Heben EIN / AUS

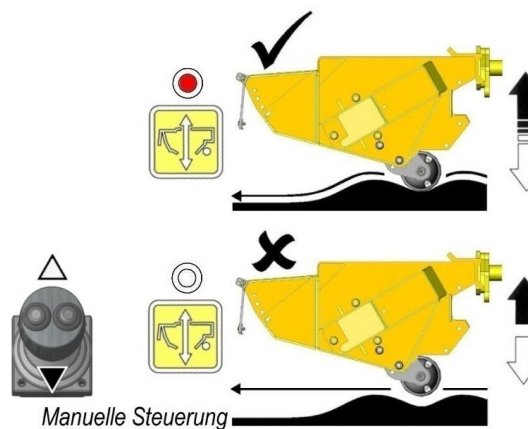
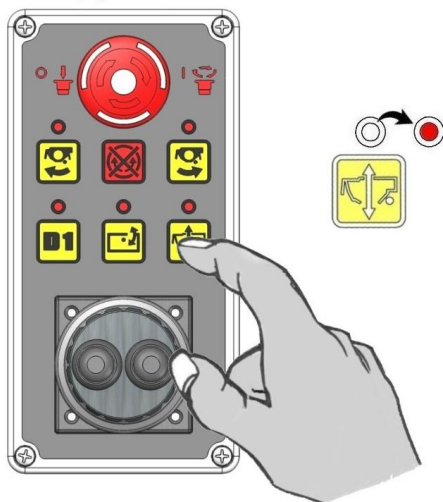

# ROTORBETRIEB

## Rotor Start - Richtung bergauf

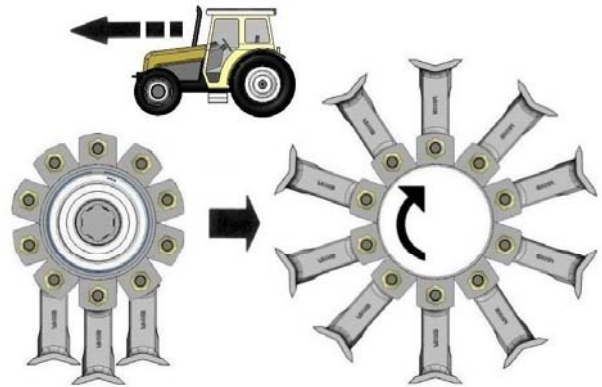
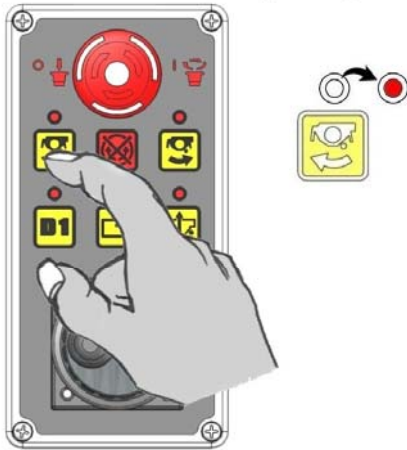

## Rotor Start - Richtung bergab

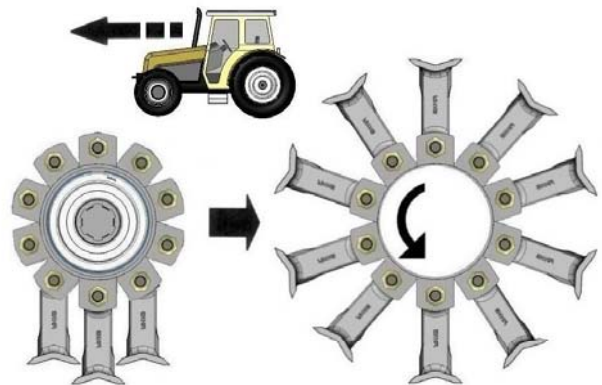
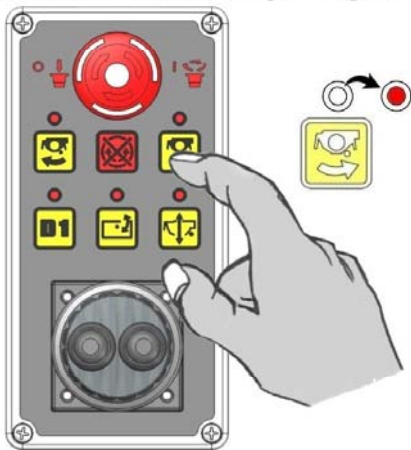

## Rotor Stop (bergauf oder bergab)

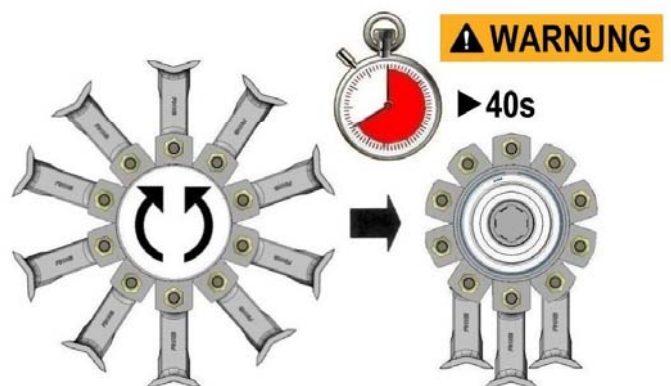
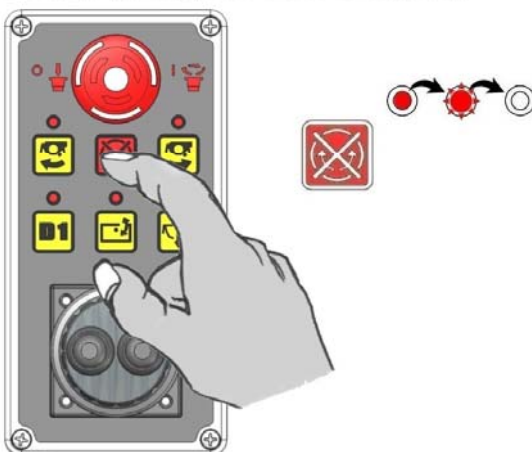

### **⚠️ WARNUNG**



ACHTUNG: Wenn der Rotor ausgeschaltet ist dauert es ungefähr 40 Sekunden Leerlauf, bevor der Rotor wirklich zum Stillstand kommt- verlassen Sie die Traktorkabine nicht oder versuchen Sie nicht dem Schlegelkopf näher zu kommen, bis der Rotor vollkommen stillsteht-





McConnel Limited, Temeside Works, Ludlow, Shropshire SY8 1JL. England.  
Telephone: 01584 873131. Facsimile: 01584 876463. [www.mcconnel.com](http://www.mcconnel.com)