

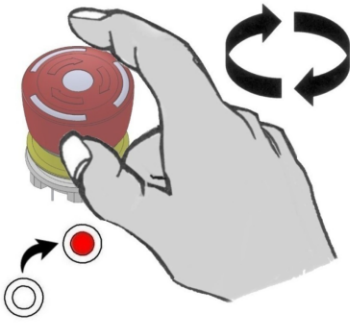

MINI MOTION STEUERELEMENTE
Bedienungsanleitung

MINI MOTION STEUERELEMENTE

Power EIN



Power AUS / NOT-HALT

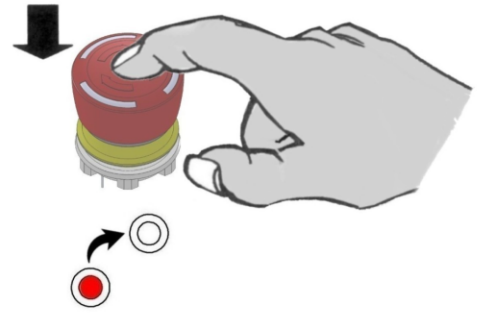

Standard-Steuerelement:
 X-Achse: Heben Betrieb
 Y-Achse: Auslage Betrieb
 Z-Achse: Winkel Betrieb
 B1+Z-Achse: Schwenk Betrieb
 B2+Y-Achse: 5th Funktion

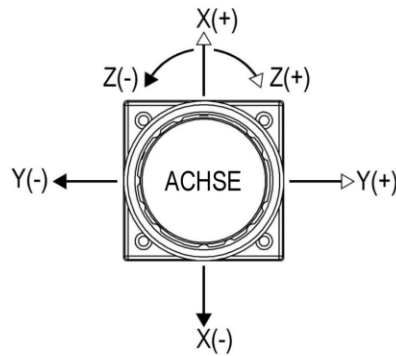
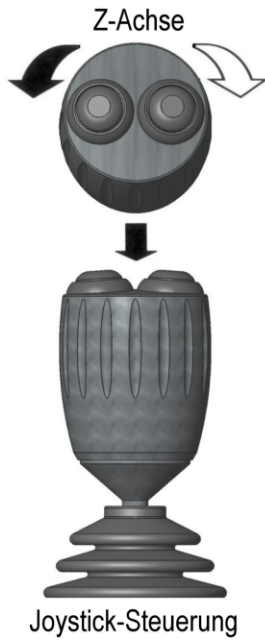

Power EIN Taste (NOT-HALT)

Rotor START (Richtung bergauf)

Ablenker Aktivierung 6th funktion

Joystick

Joystick -Taste #1

Power LED

Rotor START (Richtung bergab)

Rotor STOPP

Schwimmstellung Auslegerarm

Schwimmstellung Mährotor

LED's : Funktionsstatus

○ Deaktivieren

● Aktiv

⊗ Vorübergehend deaktiviert



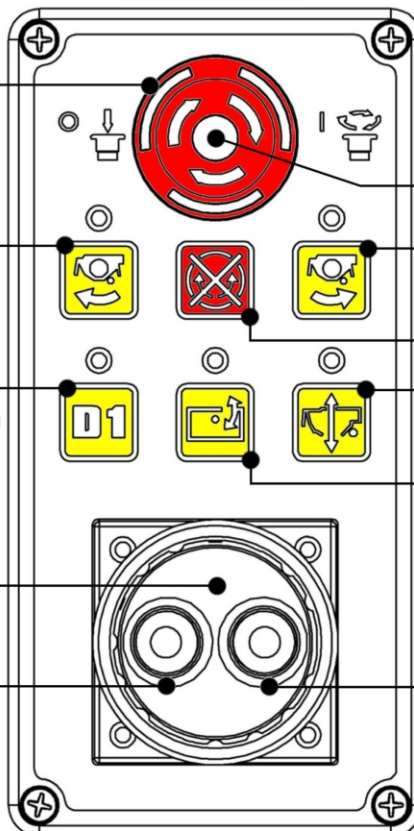



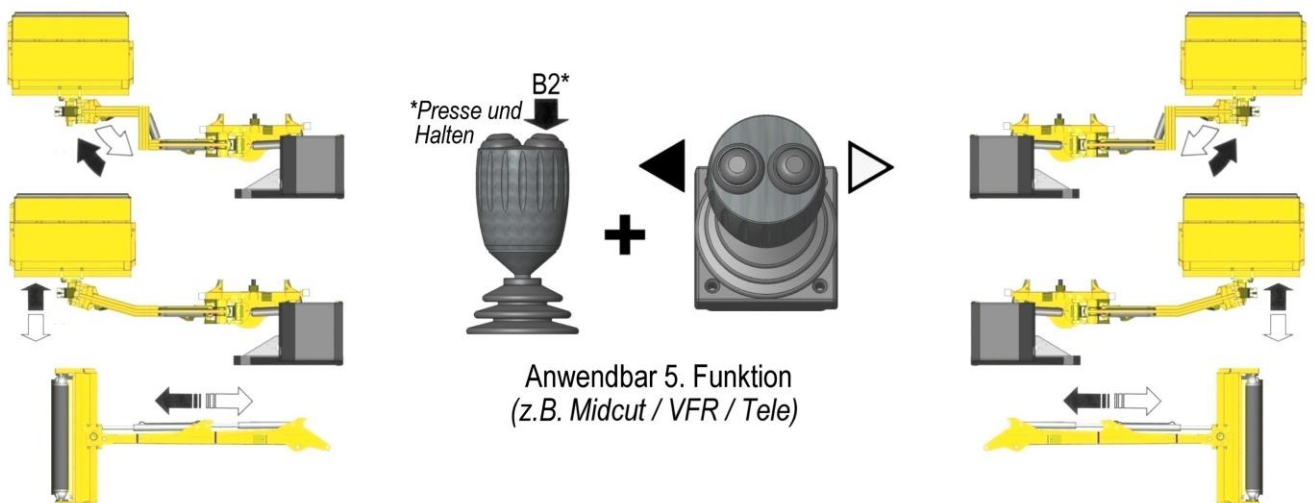
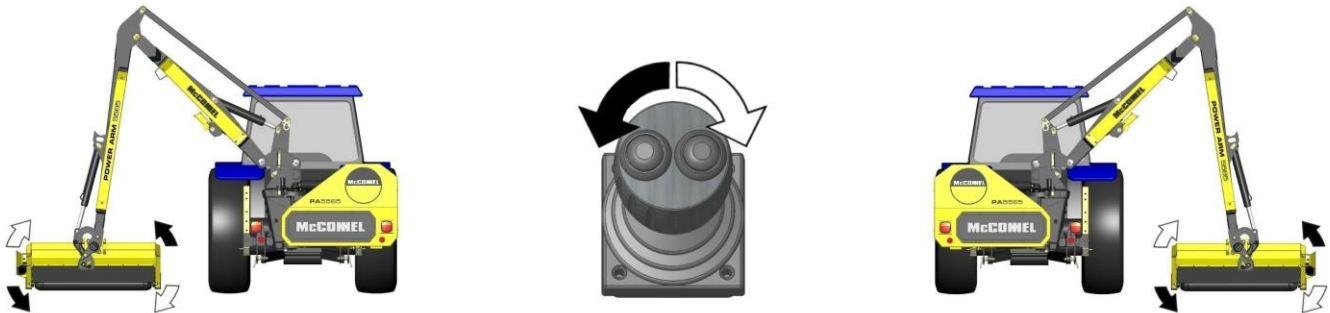
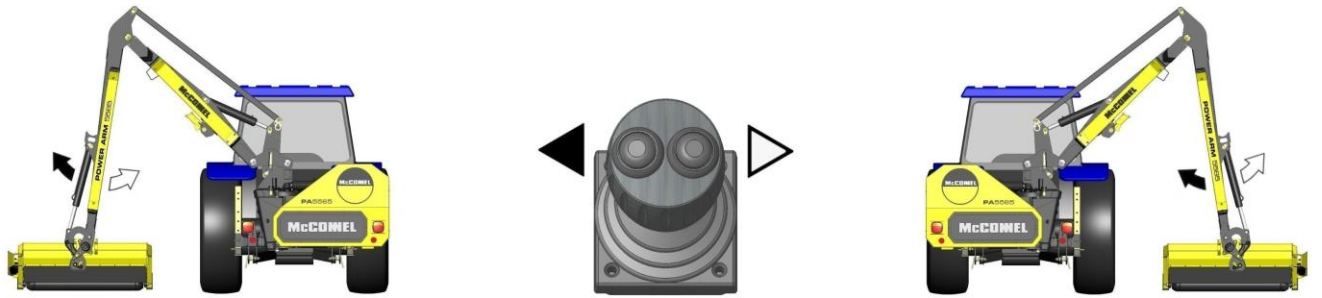

Joystick -Taste #2



Arm Bedienung Bedienelemente



Keypad Control Buttons

| Button | Function | Control Operation |
|---|--|--|
|  | Angle Float ON/OFF | Pressing the button will switch Angle Float function ON/OFF. |
|  | Lift Float ON/ OFF | Pressing the button will switch Lift Float function ON/OFF. |
|  | Rotor START (Uphill Direction). | Press to START rotor in uphill direction. <i>8 second delay for direction change.</i> |
|  | Rotor START (Downhill Direction). | Press to start rotor in downhill direction. <i>8 second delay for direction change.</i> |
|  | Rotor STOP. | Press to stop rotor. <i>Press first before direction change.</i> |
|  | Diverter: 6 th Service Activation | Press to switch 6 th Service ON/OFF. |
|  | Function status - OFF. | LED Light for specific control OFF. |
|  | Function status - ON. | LED Light for specific control ON. |
|  | Function status - Temporarily deactivated. | LED Light for specific control FLASHING. |

SCHWIMMSTELLUNG

Freie Schleppenaufhängung EIN / AUS

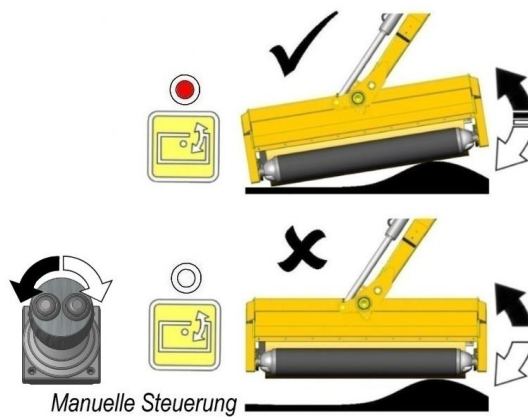
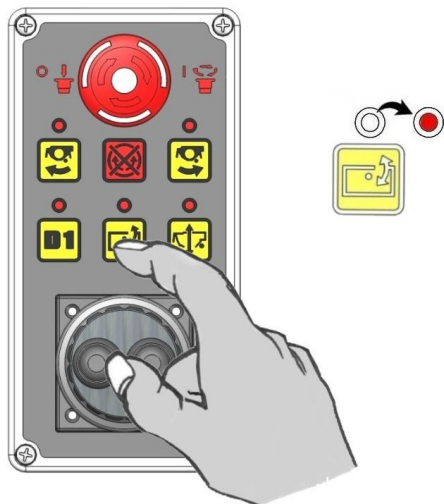

Schleppe Heben EIN / AUS

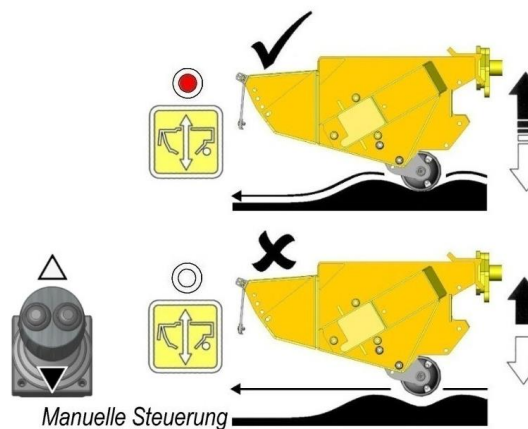
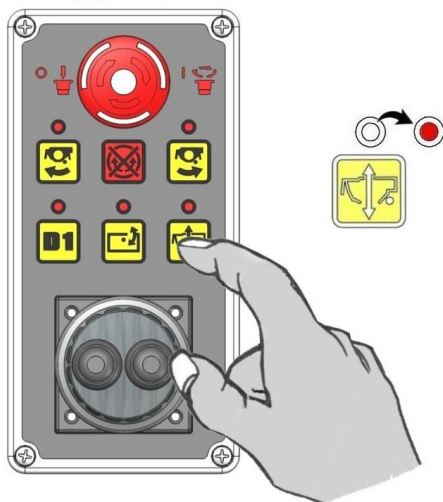

ROTORBETRIEB

Rotor Start - Richtung bergauf

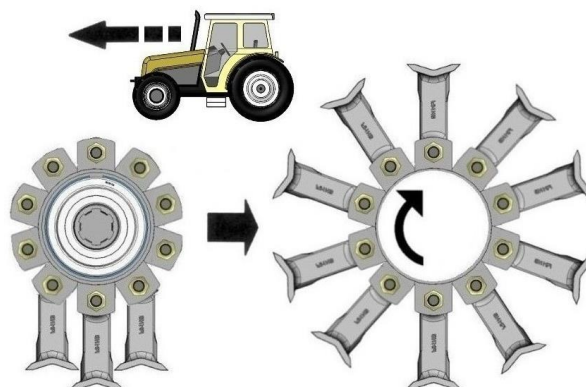
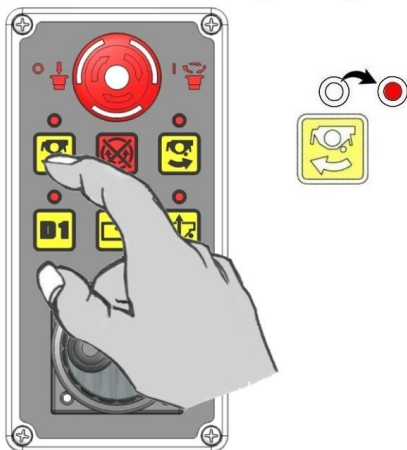

Rotor Start - Richtung bergab

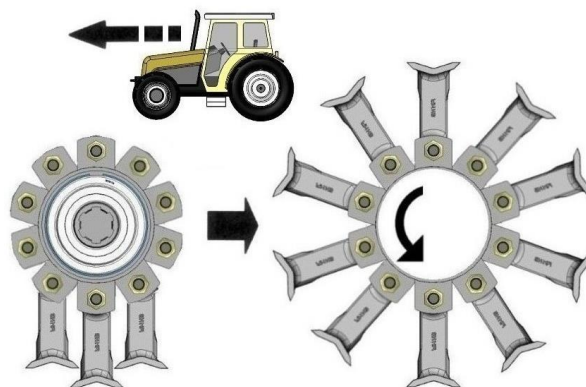
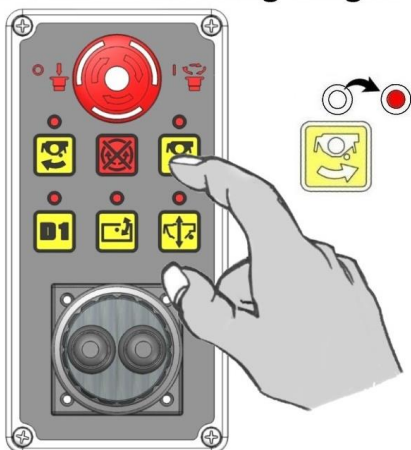

Rotor Stop (bergauf oder bergab)

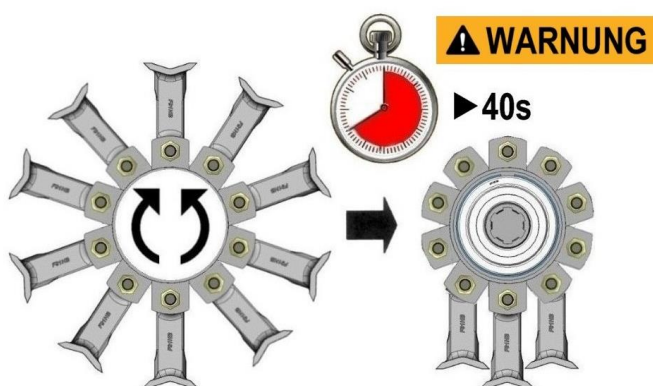
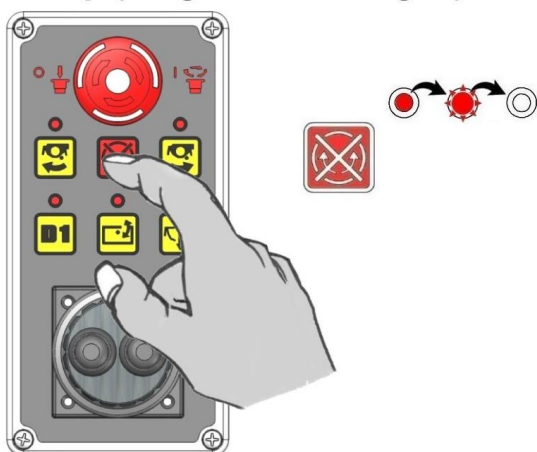

⚠️ WARNUNG



ACHTUNG: Wenn der Rotor ausgeschaltet ist dauert es ungefähr 40 Sekunden Leerlauf, bevor der Rotor wirklich zum Stillstand kommt- verlassen Sie die Traktorkabine nicht oder versuchen Sie nicht dem Schlegelkopf näher zu kommen, bis der Rotor vollkommen stillsteht-



McConnel Limited, Temeside Works, Ludlow, Shropshire SY8 1JL. England.
Telephone: 01584 873131. Facsimile: 01584 876463. www.mcconnel.com