

## Operation & Spares manual

For

# 1-2 metre Multicut flailhead Piston belt drive

with tri-mount rotor and metric bolts

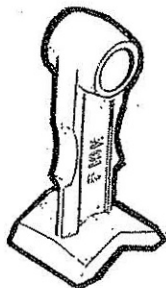

**McCONEL**

# IMPORTANT

## VERIFICATION OF WARRANTY REGISTRATION

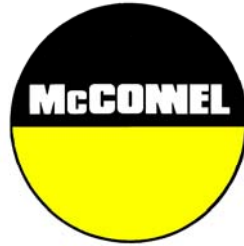

### DEALER WARRANTY INFORMATION & REGISTRATION VERIFICATION

It is imperative that the selling dealer registers this machine with McConnel Limited before delivery to the end user – failure to do so may affect the validity of the machine warranty.

To register machines go to the McConnel Limited web site at [www.mcconnel.com](http://www.mcconnel.com), log onto 'Dealer Inside' and select the 'Machine Registration button' which can be found in the Service Section of the site. Confirm to the customer that the machine has been registered in the section below.

Should you experience any problems registering a machine in this manner please contact the McConnel Service Department on 01584 875848.

#### Registration Verification

Dealer Name: .....
Dealer Address: .....
Customer Name: .....
Date of Warranty Registration: ...../...../..... Dealer Signature: .....

#### NOTE TO CUSTOMER / OWNER

*Please ensure that the above section above has been completed and signed by the selling dealer to verify that your machine has been registered with McConnel Limited.*

**IMPORTANT:** During the initial 'bedding in' period of a new machine it is the customer's responsibility to regularly inspect all nuts, bolts and hose connections for tightness and re-tighten if required. New hydraulic connections occasionally weep small amounts of oil as the seals and joints settle in – where this occurs it can be cured by re-tightening the connection – *refer to torque settings chart below*. The tasks stated above should be performed on an hourly basis during the first day of work and at least daily thereafter as part of the machines general maintenance procedure.

#### TORQUE SETTINGS FOR HYDRAULIC FITTINGS

HYDRAULIC HOSE ENDS		
BSP	Setting	Metric
1/4"	18 Nm	19 mm
3/8"	31 Nm	22 mm
1/2"	49 Nm	27 mm
5/8"	60 Nm	30 mm
3/4"	80 Nm	32 mm
1"	125 Nm	41 mm
1.1/4"	190 Nm	50 mm
1.1/2"	250 Nm	55 mm
2"	420 Nm	70 mm

PORT ADAPTORS WITH BONDED SEALS		
BSP	Setting	Metric
1/4"	34 Nm	19 mm
3/8"	47 Nm	22 mm
1/2"	102 Nm	27 mm
5/8"	122 Nm	30 mm
3/4"	149 Nm	32 mm
1"	203 Nm	41 mm
1.1/4"	305 Nm	50 mm
1.1/2"	305 Nm	55 mm
2"	400 Nm	70 mm



# WARRANTY POLICY

## WARRANTY REGISTRATION

All machines must be registered, by the selling dealer with McConnel Ltd, before delivery to the end user. On receipt of the goods it is the buyer's responsibility to check that the Verification of Warranty Registration in the Operator's Manual has been completed by the selling dealer.

### 1. LIMITED WARRANTIES

- 1.01. *All mounted machines supplied by McConnel Ltd are warranted to be free from defects in material and workmanship from the date of sale to the original purchaser for a period of 12 months, unless a different period is specified.  
All Self Propelled Machines supplied by McConnel Ltd are warranted to be free from defects in material and workmanship from the date of sale to the original purchaser for a period of 12 months or 1500 hours. Engine warranty will be specific to the Manufacturer of that unit.*
- 1.02. *All spare parts supplied by McConnel Ltd and purchased by the end user are warranted to be free from defects in material and workmanship from the date of sale to the original purchaser for a period of 6 months. All parts warranty claims must be supported by a copy of the failed part invoice to the end user. We cannot consider claims for which sales invoices are not available.*
- 1.03. *The warranty offered by McConnel Ltd is limited to the making good by repair or replacement for the purchaser any part or parts found, upon examination at its factory, to be defective under normal use and service due to defects in material or workmanship. Returned parts must be complete and unexamined. Pack the component(s) carefully so that any transit damage is avoided. All ports on hydraulic items should be drained of oil and securely plugged to prevent seepage and foreign body ingress. Certain other components, electrical items for example, may require particular care when packing to avoid damage in transit.*
- 1.04. *This warranty does not extend to any product from which McConnel Ltd's serial number plate has been removed or altered.*
- 1.05. *The warranty policy is valid for machines registered in line with the terms and conditions detailed and on the basis that the machines do not extend a period of 24 months or greater since their original purchase date, that is the original invoice date from McConnel Limited.  
Machines that are held in stock for more than 24 months cannot be registered for warranty.*
- 1.06. *This warranty does not apply to any part of the goods, which has been subjected to improper or abnormal use, negligence, alteration, modification, fitment of non-genuine parts, accident damage, or damage resulting from contact with overhead power lines, damage caused by foreign objects (e.g. stones, iron, material other than vegetation), failure due to lack of maintenance, use of incorrect oil or lubricants, contamination of the oil, or which has served its normal life. This warranty does not apply to any expendable items such as blades, belts, clutch linings, filter elements, flails, flap kits, skids, soil engaging parts, shields, guards, wear pads, pneumatic tyres or tracks.*
- 1.07. *Temporary repairs and consequential loss - i.e. oil, downtime and associated parts are specifically excluded from the warranty.*
- 1.08. *Warranty on hoses is limited to 12 months and does not include hoses which have suffered external damage. Only complete hoses may be returned under warranty, any which have been cut or repaired will be rejected.*
- 1.09. *Machines must be repaired immediately a problem arises. Continued use of the machine after a problem has occurred can result in further component failures, for which McConnel Ltd cannot be held liable, and may have safety implications.*
- 1.10. *If in exceptional circumstances a non McConnel Ltd part is used to effect a repair, warranty reimbursement will be at no more than McConnel Ltd's standard dealer cost for the genuine part.*

- 1.11. *Except as provided herein, no employee, agent, dealer or other person is authorised to give any warranties of any nature on behalf of McConnell Ltd.*
- 1.12. *For machine warranty periods in excess of 12 months the following additional exclusions shall apply:*
  - 1.12.1. *Hoses, exposed pipes and hydraulic tank breathers.*
  - 1.12.2. *Filters.*
  - 1.12.3. *Rubber mountings.*
  - 1.12.4. *External electric wiring.*
  - 1.12.5. *Bearings and seals*
  - 1.12.6. *External Cables, Linkages*
  - 1.12.7. *Loose/Corroded Connections, Light Units, LED's*
  - 1.12.8. *Comfort items such as Operator Seat, Ventilation, Audio Equipment*
- 1.13. *All service work, particularly filter changes, must be carried out in accordance with the manufacturer's service schedule. Failure to comply will invalidate the warranty. In the event of a claim, proof of the service work being carried out may be required.*
- 1.14. *Repeat or additional repairs resulting from incorrect diagnosis or poor quality previous repair work are excluded from warranty.*

***NB Warranty cover will be invalid if any non-genuine parts have been fitted or used. Use of non-genuine parts may seriously affect the machine's performance and safety. McConnell Ltd cannot be held responsible for any failures or safety implications that arise due to the use of non-genuine parts.***

## **2. REMEDIES AND PROCEDURES**

- 2.01. *The warranty is not effective unless the Selling Dealer registers the machine, via the McConnell web site and confirms the registration to the purchaser by completing the confirmation form in the operator's manual.*
- 2.02. *Any fault must be reported to an authorised McConnell Ltd dealer as soon as it occurs. Continued use of a machine, after a fault has occurred, can result in further component failure for which McConnell Ltd cannot be held liable.*
- 2.03. *Repairs should be undertaken within two days of the failure. Claims submitted for repairs undertaken more than 2 weeks after a failure has occurred, or 2 days after the parts were supplied will be rejected, unless the delay has been authorised by McConnell Ltd. Please note that failure by the customer to release the machine for repair will not be accepted as a reason for delay in repair or submitting warranty claims.*
- 2.04. *All claims must be submitted, by an authorised McConnell Ltd Service Dealer, within 30 days of the date of repair.*
- 2.05. *Following examination of the claim and parts, McConnell Ltd will pay, at their discretion, for any valid claim the invoiced cost of any parts supplied by McConnell Ltd and appropriate labour and mileage allowances if applicable.*
- 2.06. *The submission of a claim is not a guarantee of payment.*
- 2.07. *Any decision reached by McConnell Ltd. is final.*

## **3. LIMITATION OF LIABILITY**

- 3.01. *McConnell Ltd disclaims any express (except as set forth herein) and implied warranties with respect to the goods including, but not limited to, merchantability and fitness for a particular purpose.*
- 3.02. *McConnell Ltd makes no warranty as to the design, capability, capacity or suitability for use of the goods.*
- 3.03. *Except as provided herein, McConnell Ltd shall have no liability or responsibility to the purchaser or any other person or entity with respect to any liability, loss, or damage caused or alleged to be caused directly or indirectly by the goods including, but not limited to, any indirect, special, consequential, or incidental damages resulting from the use or operation of the goods or any breach of this warranty. Notwithstanding the above limitations and warranties, the manufacturer's liability hereunder for damages incurred by the purchaser or others shall not exceed the price of the goods.*
- 3.04. *No action arising out of any claimed breach of this warranty or transactions under this warranty may be brought more than one (1) year after the cause of the action has occurred.*

#### **4. MISCELLANEOUS**

- 4.01. McConnel Ltd may waive compliance with any of the terms of this limited warranty, but no waiver of any terms shall be deemed to be a waiver of any other term.*
- 4.02. If any provision of this limited warranty shall violate any applicable law and is held to be unenforceable, then the invalidity of such provision shall not invalidate any other provisions herein.*
- 4.03. Applicable law may provide rights and benefits to the purchaser in addition to those provided herein.*

---

*McConnel Limited*



# DECLARATION OF CONFORMITY

*Conforming to EU Machinery Directive 2006/42/EC*

We,

**McCONNEL LIMITED**, Temeside Works, Ludlow, Shropshire SY8 1JL, UK

*Hereby declare that:*

The Product; *Hydraulic Arm Mounted Flailhead*

Product Code; *BD12, BD16, F110, F112, F115, F012, F016*

Serial No. & Date ..... Type .....

Manufactured in; *United Kingdom*

Complies with the required provisions of the Machinery Directive 2006/42/EC  
The machinery directive is supported by the following harmonized standards;

- BS EN ISO 12100 (2010) Safety of machinery – General principles for design – Risk assessment and risk reduction.
- BS EN 349 (1993) + A1 (2008) Safety of machinery - Minimum distances to avoid the entrapment with human body parts.
- BS EN ISO 14120 (2015) Safety of machinery - Guards general requirements for the design and construction of fixed and movable guards.
- BS EN 4413 (2010) Hydraulic fluid power. Safety requirements for systems and their components.

McCONNEL LIMITED operates an ISO 9001:2008 quality management system, certificate number: FM25970.

This system is continually assessed by the;

British Standards Institution (BSI), Beech House, Milton Keynes, MK14 6ES, UK  
BSI is accredited by UK Accreditation Service, accreditation number: UKAS 003.  
The EC declaration only applies if the machine stated above is used in accordance with the operating instructions.

Signed ..... *Responsible Person*  
*CHRISTIAN DAVIES on behalf of McCONNEL LIMITED*

Status: *General Manager*

Date: *January 2018*

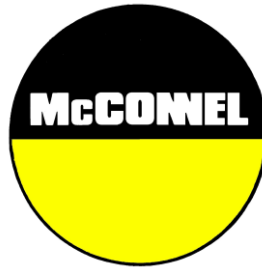

*For Safety and Performance...*

**ALWAYS READ THE BOOK FIRST**

**McCONEL LIMITED**

**Temeside Works  
Ludlow  
Shropshire  
England**

**Telephone: +44 (0)1584 873131  
www.mcconel.com**

---

**- NOISE STATEMENT -**

The equivalent daily personal noise exposure from this machine measured at the operators' ear is within the range 78 – 85 dB, these figures apply to a normal distribution of use where the noise fluctuates between zero and maximum. The figures assume that the machine is fitted to a tractor with a 'quiet' cab with the windows closed in a generally open environment. We recommend that the windows are kept closed. With the cab rear window open the equivalent daily personal noise exposure will increase to a figure within the range 82 – 88 dB. At an equivalent daily noise exposure level of 85 – 90 dB ear protection is recommended and must always be used if any window is left open.



Operating, servicing and maintaining this equipment can expose you to chemicals including gasoline, diesel fuel, lubricants, petroleum products, engine exhaust, carbon monoxide, and phthalates, which are known to the State of California to cause cancer and birth defects or other reproductive harm. To minimize exposure, avoid breathing exhaust, do not idle the engine except as necessary, service your vehicle in a well-ventilated area and wear gloves or wash your hands frequently when servicing your vehicle. Battery posts, terminals and related accessories contain lead and lead compounds, chemicals known to the state of California to cause cancer, birth defects or other reproductive harm. For more information go to [www.P65Warnings.ca.gov](http://www.P65Warnings.ca.gov). This website, operated by California's Office of Environmental Health Hazard Assessment, provides information about these chemicals and how individuals may be exposed to them.





## GENERAL INFORMATION

---

Always read this manual before fitting or operating the machine – whenever any doubt exists contact your dealer or the McConnel Service Department for advice and assistance.

### Use only McConnel Genuine Service Parts on McConnel Equipment and Machines

**DEFINITIONS** – *The following definitions apply throughout this manual:*

#### **WARNING**

An operating procedure, technique etc., which –  
can result in personal injury or loss of life if not observed carefully.

#### **CAUTION**

An operating procedure, technique etc., which –  
can result in damage to either machine or equipment if not observed carefully.

#### **NOTE**

An operating procedure, technique etc., which –  
is considered essential to emphasis.

#### **LEFT AND RIGHT HAND**

This term is applicable to the machine when attached to the tractor and is viewed  
from the rear – this also applies to tractor references.

## MACHINE & DEALER INFORMATION

*Record the Serial Number of your machine on this page and always quote this number when ordering parts. Whenever information concerning the machine is requested remember also to state the make and model of tractor to which the machine is fitted.*

Machine Serial Number:	Installation Date:
Machine Model details:	
Dealer Name:	
Dealer Address:	
Dealer Telephone No:	
Dealer Email Address:	

Check:- All bolts are tight and that the torque figures are correct for the specific locations shown below.

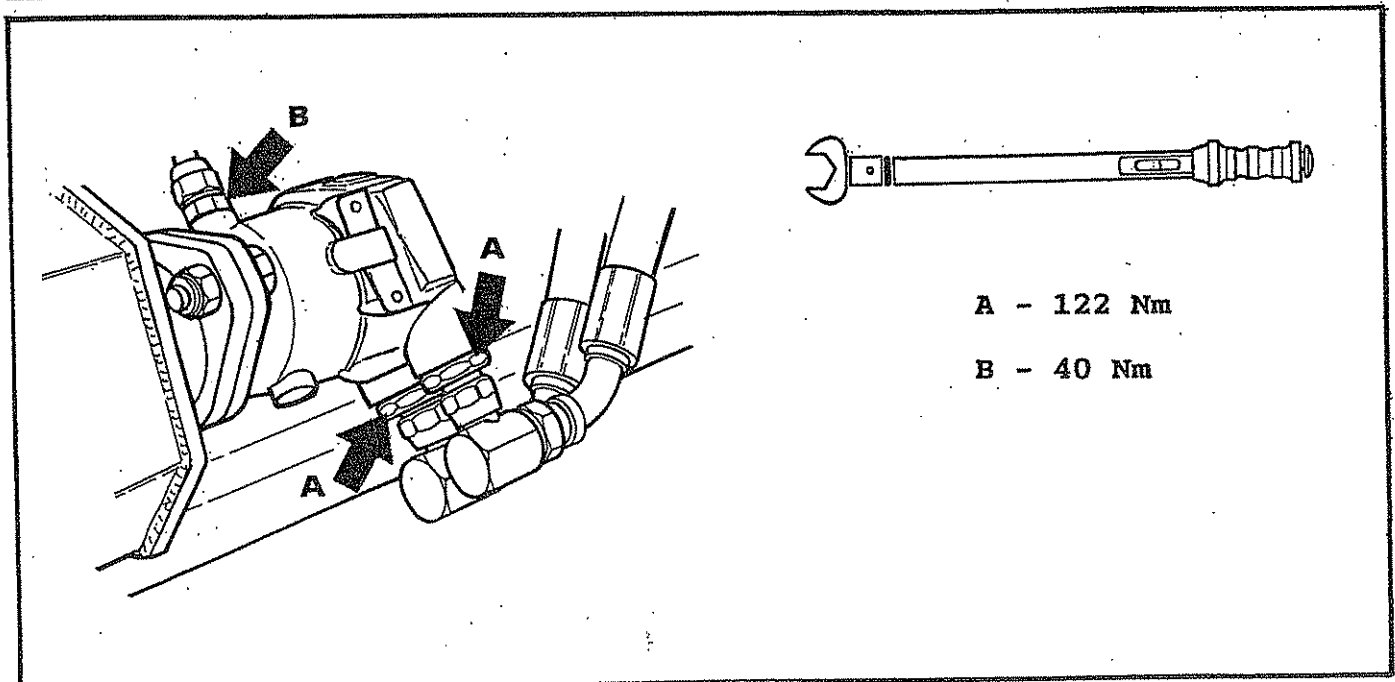
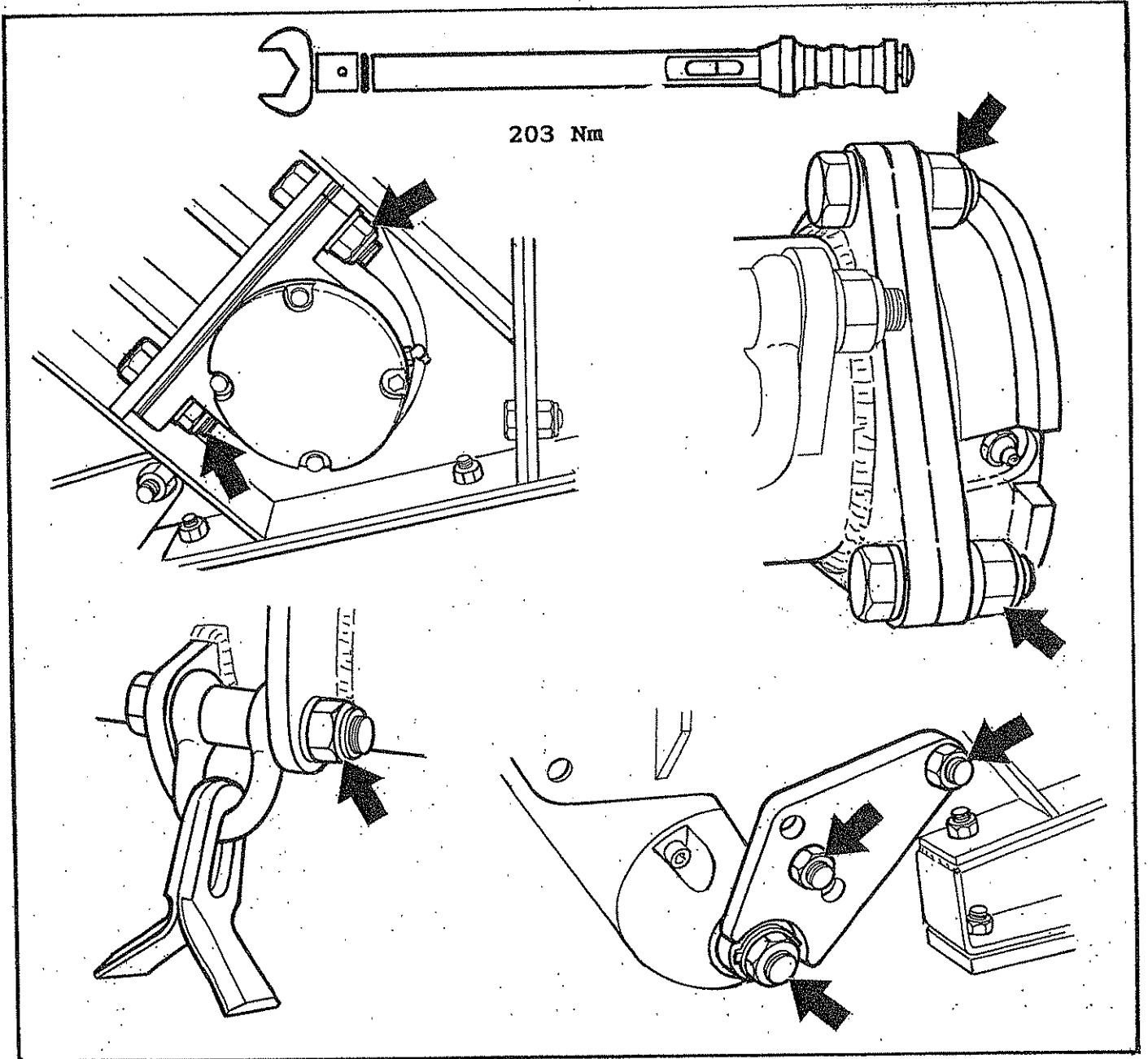

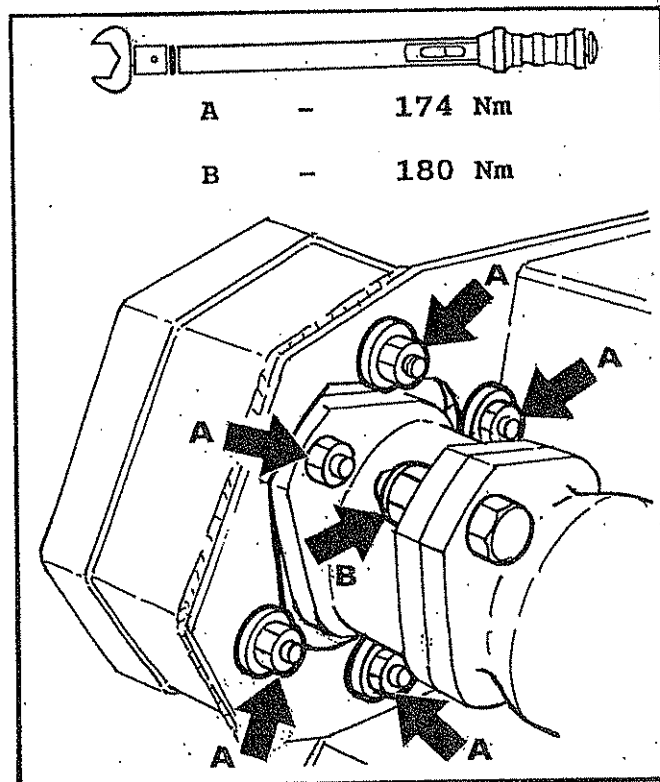
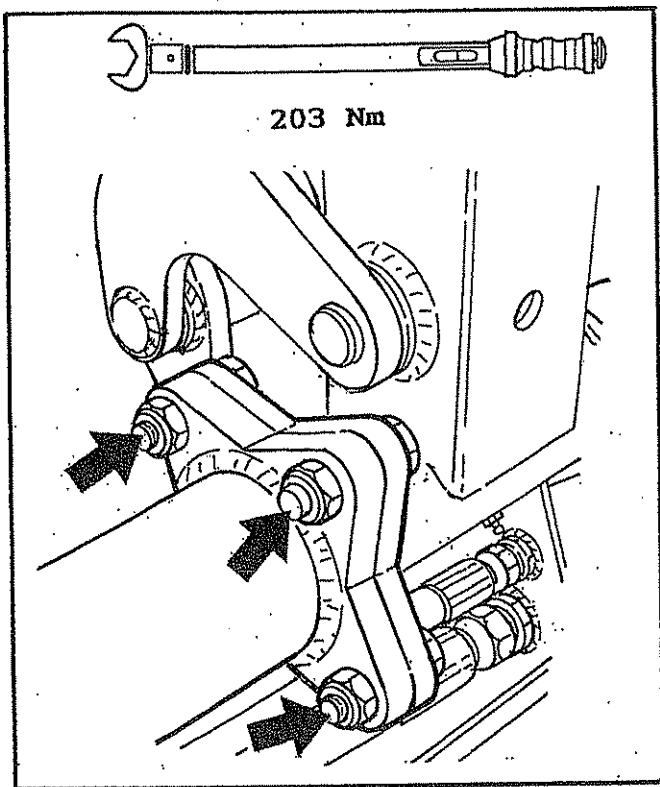

Check:- Belt tension.

This is correct when: with comfortable finger pressure exerted centrally between the pulleys the tooth tips of the belt can be deflected downward to the level of the thick red line on the sticker.

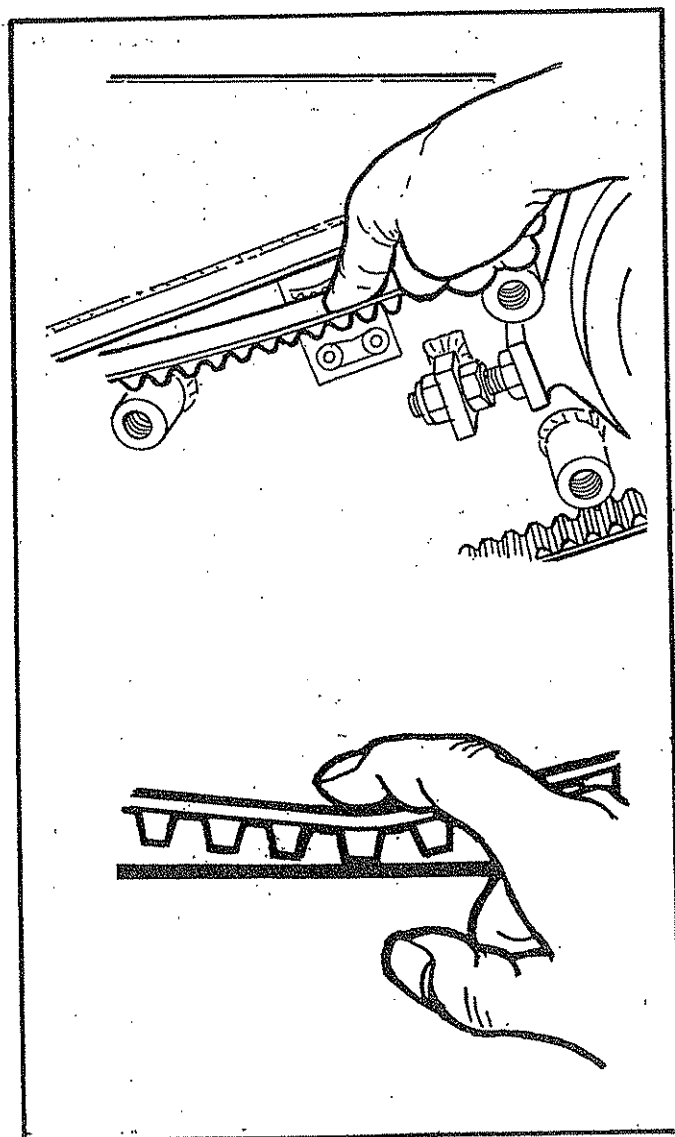

Check:- Pulley alignment

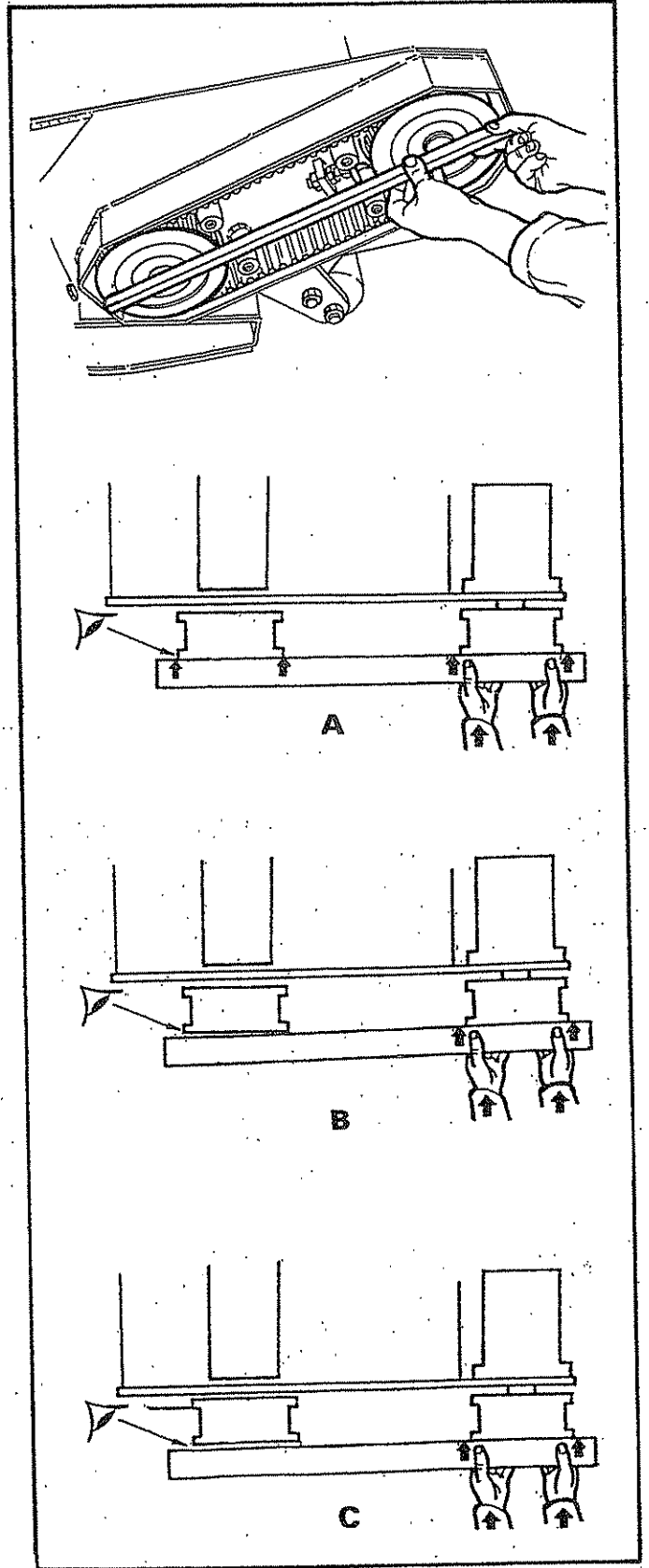

Diagram A - Correct

Diagram B - Incorrect - Angular misalignment. To correct see page

Diagram C - Incorrect - Parallel misalignment. To correct see page

# OPERATION

## MATERIAL THICKNESS CUTTING LIMITATIONS

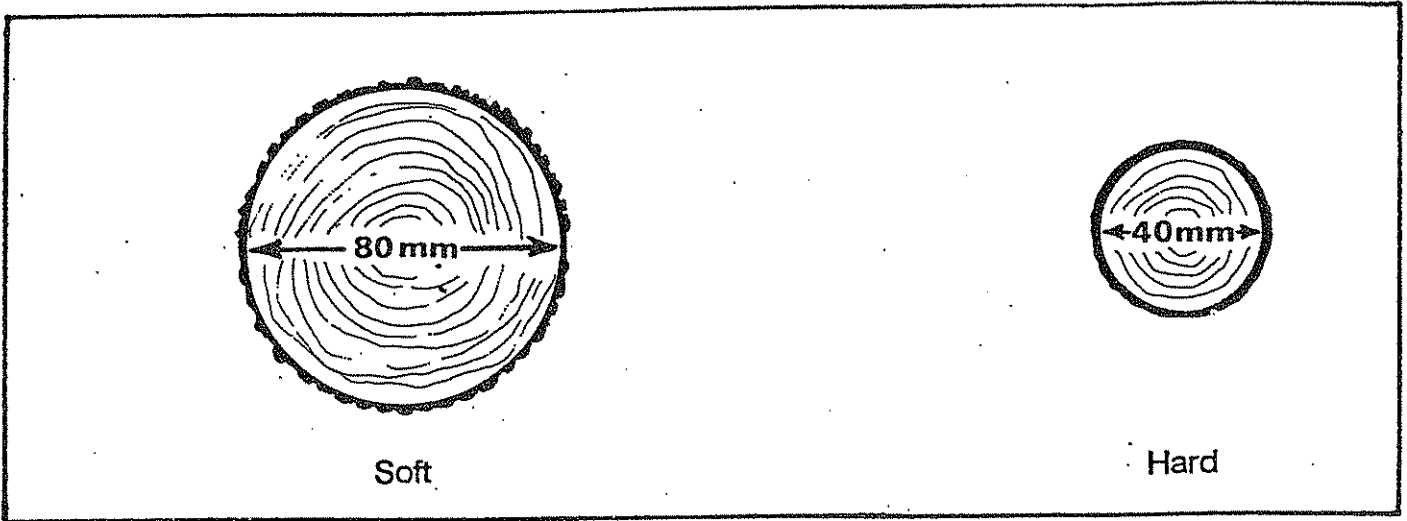

## FLAIL SELECTION

Four types of flail are available to provide the optimum cutting characteristics for the type of work being carried out.

Designed specifically for general mowing activities

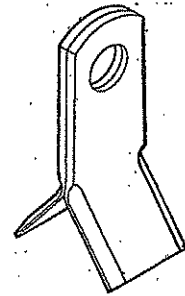

Designed for general purpose work they are suitable for both mowing and the cutting of hedges with up to two years growth



Designed specifically for heavy duty hedge cutting this flail is capable of dealing with material up to 75/80mm dia. These flails also provide a good mowing finish but will require considerably more power when used for this purpose.

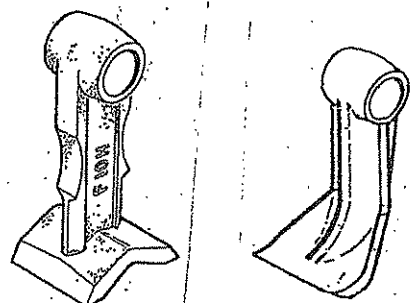

## ROLLER POSITIONS

A combination of three holes in the roller bracket and two holes in the flail head give a total of six roller height positions.

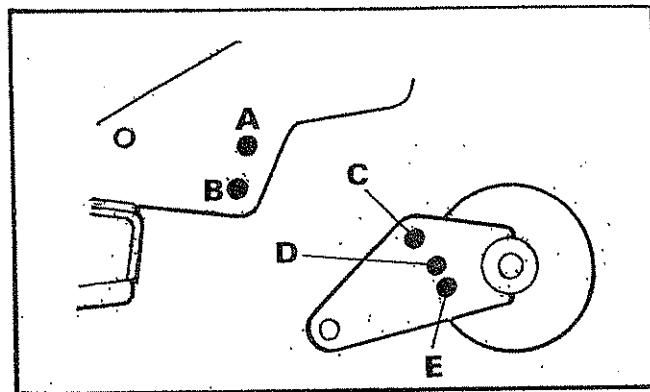

### Adjusting roller

Loosen only the roller bracket pivot bolts 'A'

Tank the weight off the roller and remove the bracket locating bolts 'B' from both ends.

Lift roller and replace the bracket locating bolts and nuts in the position required.

Finally tighten all nuts and bolts to 203Nm.

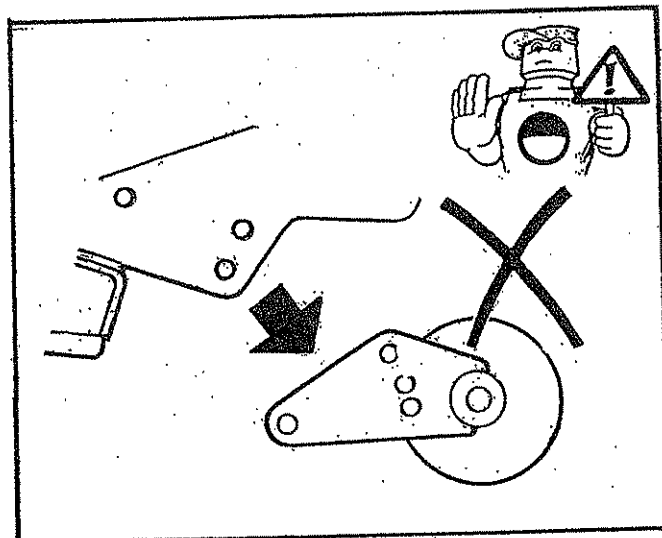
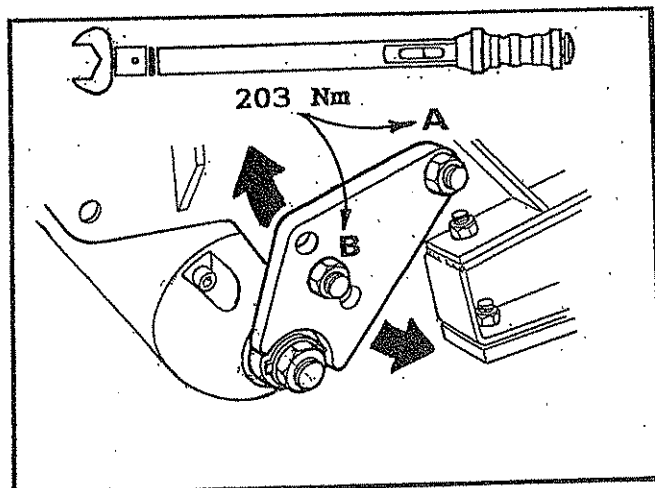

### WARNING

Never operate the machine without the roller being in place and in its correct position.

Position 1 -  
Roller position for hedge cutting.

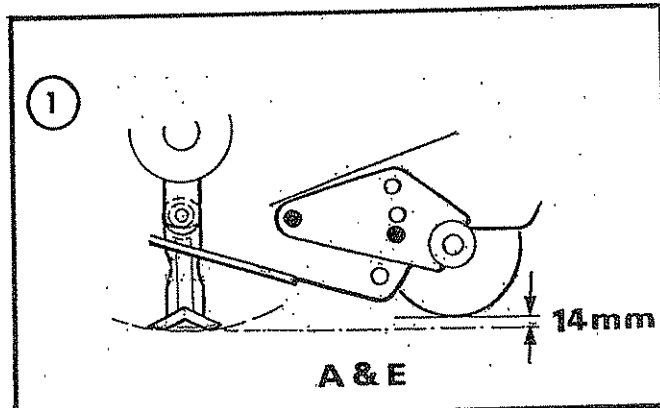

Positions 2,3,4,5, and 6 - provide a selection of roller heights for mowing operations. The length of the finish required and the condition of the ground surface will determine the setting selected.

Note: Dimensions shown in relation to the rotor tips are approximate and may vary slightly depending upon the flail fitted.

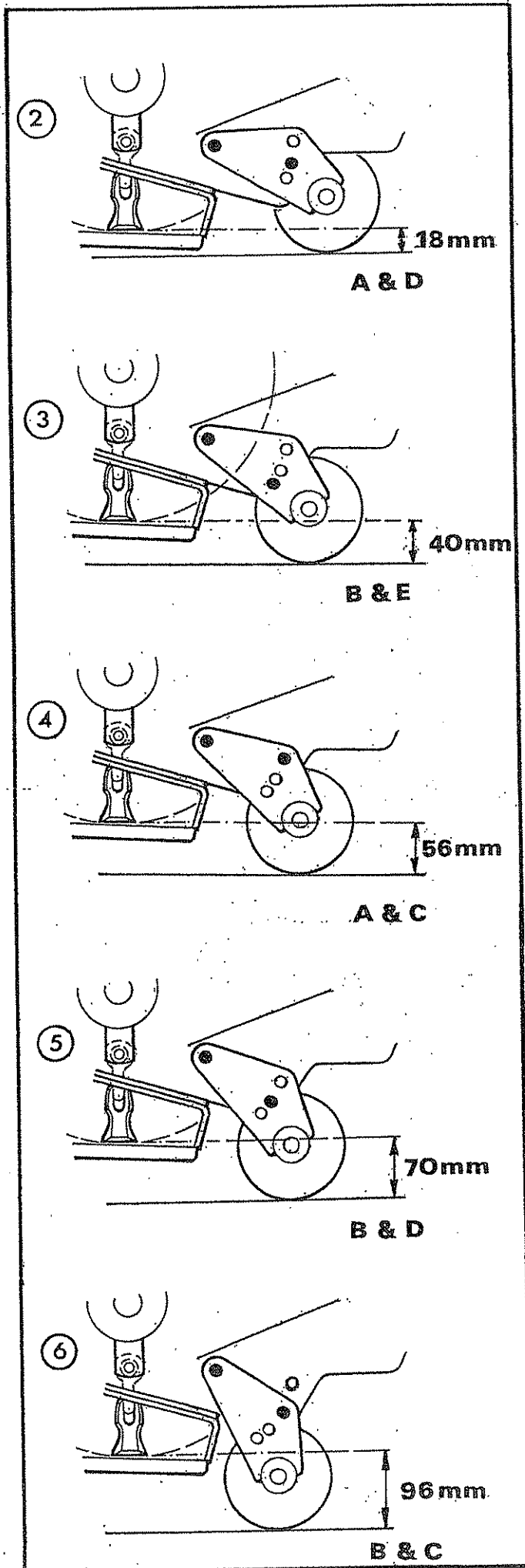



**HEDGE CUTTING - Average working conditions with hedge or universal head.**

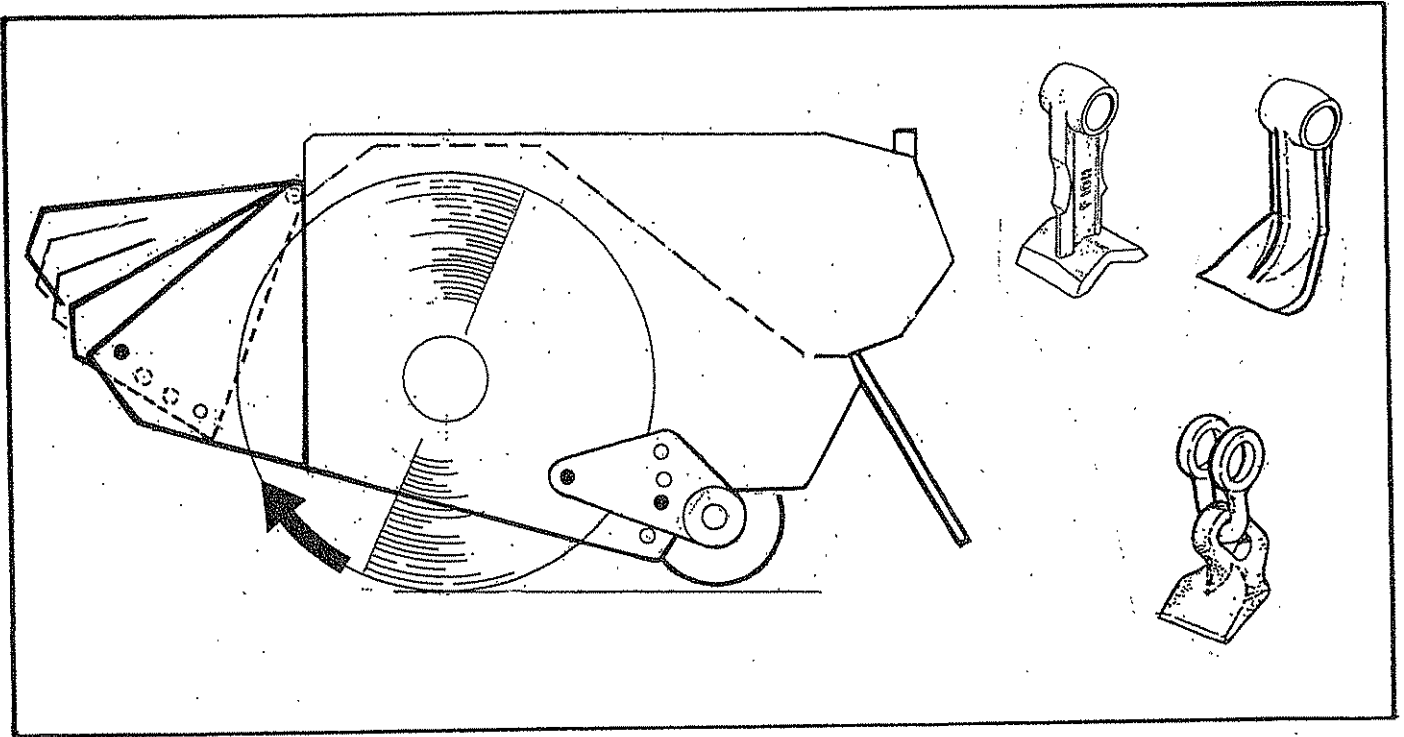

For the best finish the rotor should cut with an upwards rotation.

The roller should be set slightly above the rotor i.e. in position 1.

On universal heads the front rubber flaps and skids if fitted, may be removed to aid the entry of the material to be cut into the flail head.

The front hood has four adjustment positions for height. The lowest position which allows the material to be cut to enter the flail head should always be used.

**WARNING**

Raising the front hood increases the possibility of debris escaping. Never operate the machine with the front hood set any higher than is absolutely necessary.

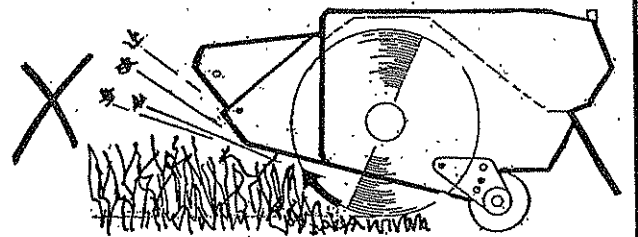

**WARNING**

Do not remove any guarding under any circumstance during operation.

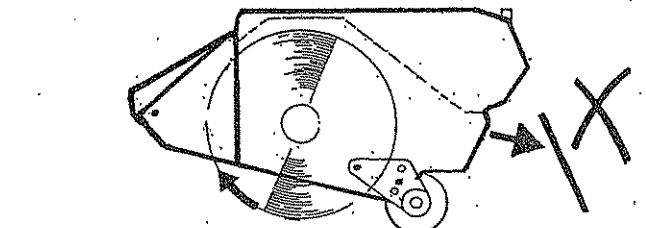
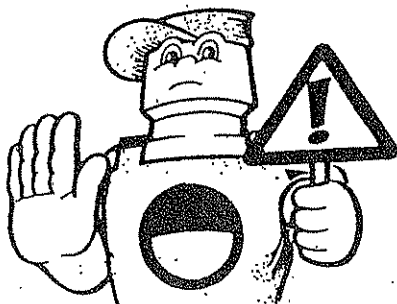
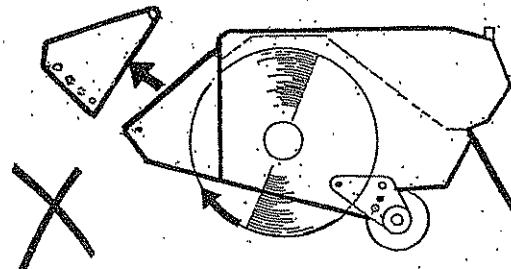

HEDGE CUTTING - Heavy duty working conditions with hedge head.

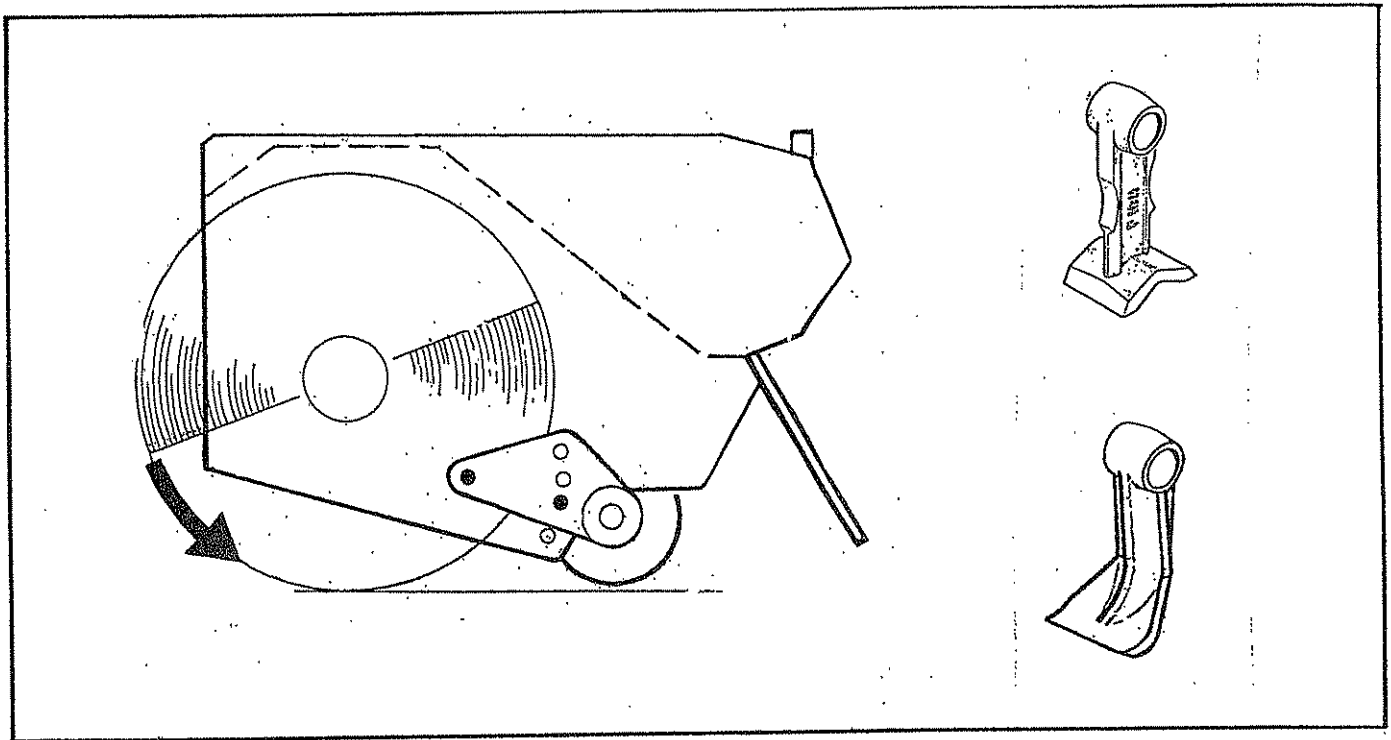

Where the size of the material to be cut makes it necessary for the front hood and carrier plates to be removed to allow the rotor to cut, the rotor must always cut with a downwards rotation.

This will result in a poorer finish and require more power than when cutting upwards.

The roller should be set slightly above the rotor i.e. in position 1.

**WARNING**

Do not remove any guarding under any circumstance during operation.

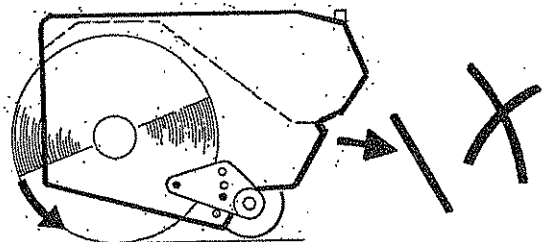
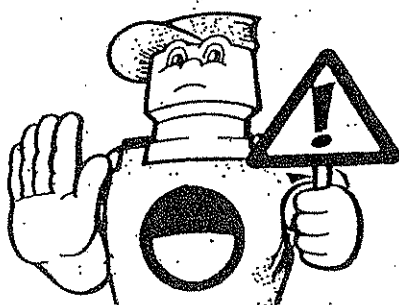

# FLAILHEAD ARRANGEMENT

MOWING - with grass or universal head

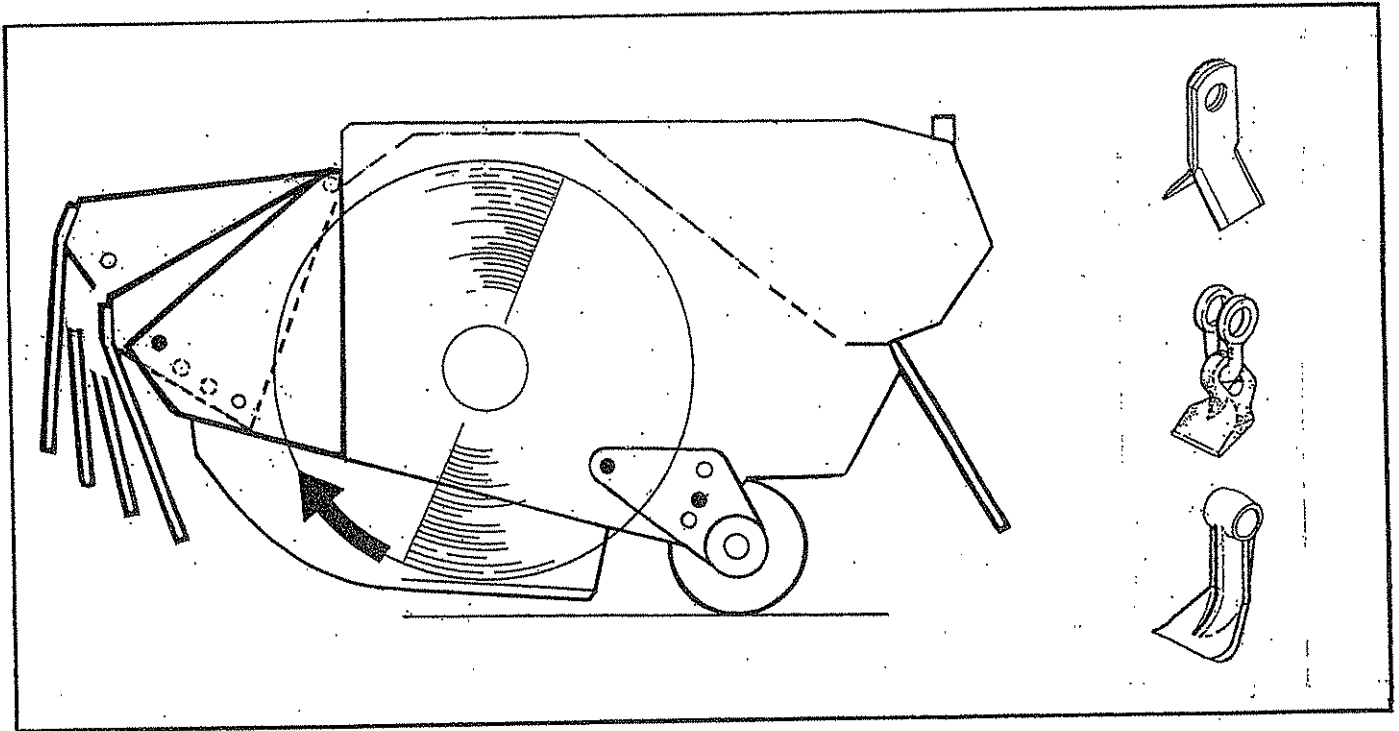

When mowing the rotor must always cut with an upwards rotation.

When mowing the roller must always be set below the level of the skid or the rotor if skids are not fitted i.e. in positions 2 - 6.

The front hood has four adjustment positions for height. The lowest possible position which allows the material to be cut to enter the head should always be used.

## WARNING

Raising the front hood increases the possibility of debris escaping. Never operate the machine with the front hood set any higher than is absolutely necessary.

## WARNING

Do not remove any guarding under any circumstance during operation.

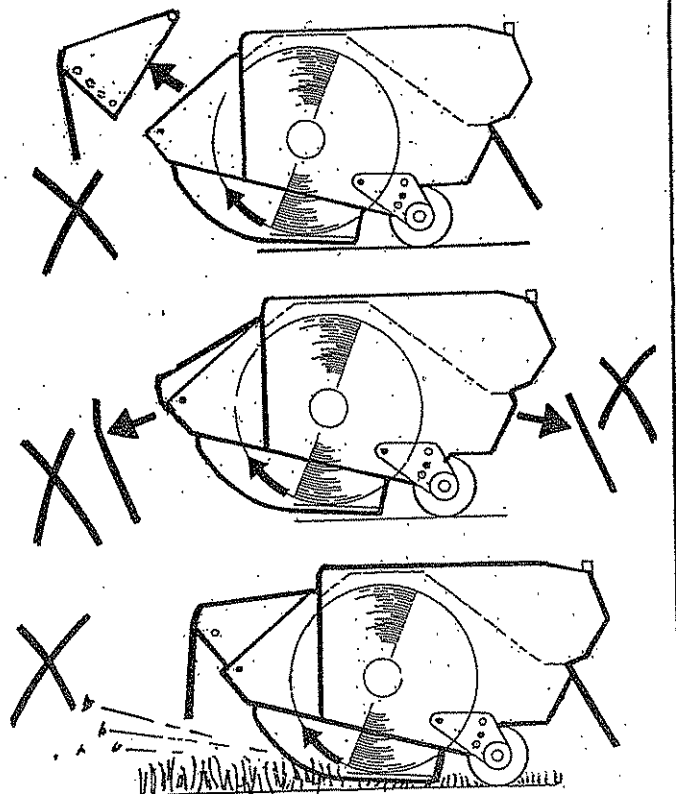
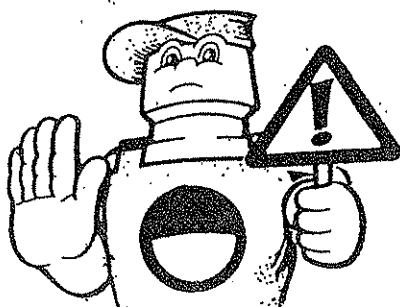

## FLAILHEAD

Frequently inspect the rotor assembly for damaged or missing flails. Bolts and nuts securing the flails to the rotor should be regularly checked and kept tight. The correct torque setting for these locknuts is 203 Nm (150 lbf/ft.). Use only the correct flail bolt and locking nut. Check the flail pivot bushes for possible damage or wear. They do not require oil.

Do not attempt to run the rotor with flails missing. Im-balance will cause severe vibration and can rapidly damage the rotor shaft bearings. As an emergency measure if a flail is broken off or lost, remove another on the opposite side of the rotor to retain balance. Always replace flails in opposite pairs and never match up a new flail with a re-sharpened one which will of course be lighter.

Blunt flails absorb a lot of power and leave an untidy finish to the work. They should be sharpened on a grindstone or with a portable grinder periodically.

Wear protective gear when sharpening flails.

Ensure that the bearing housings and hydraulic mounting nuts and bolts are kept tight. They should be checked during servicing.

## LUBRICATION

Grease daily all points shown.

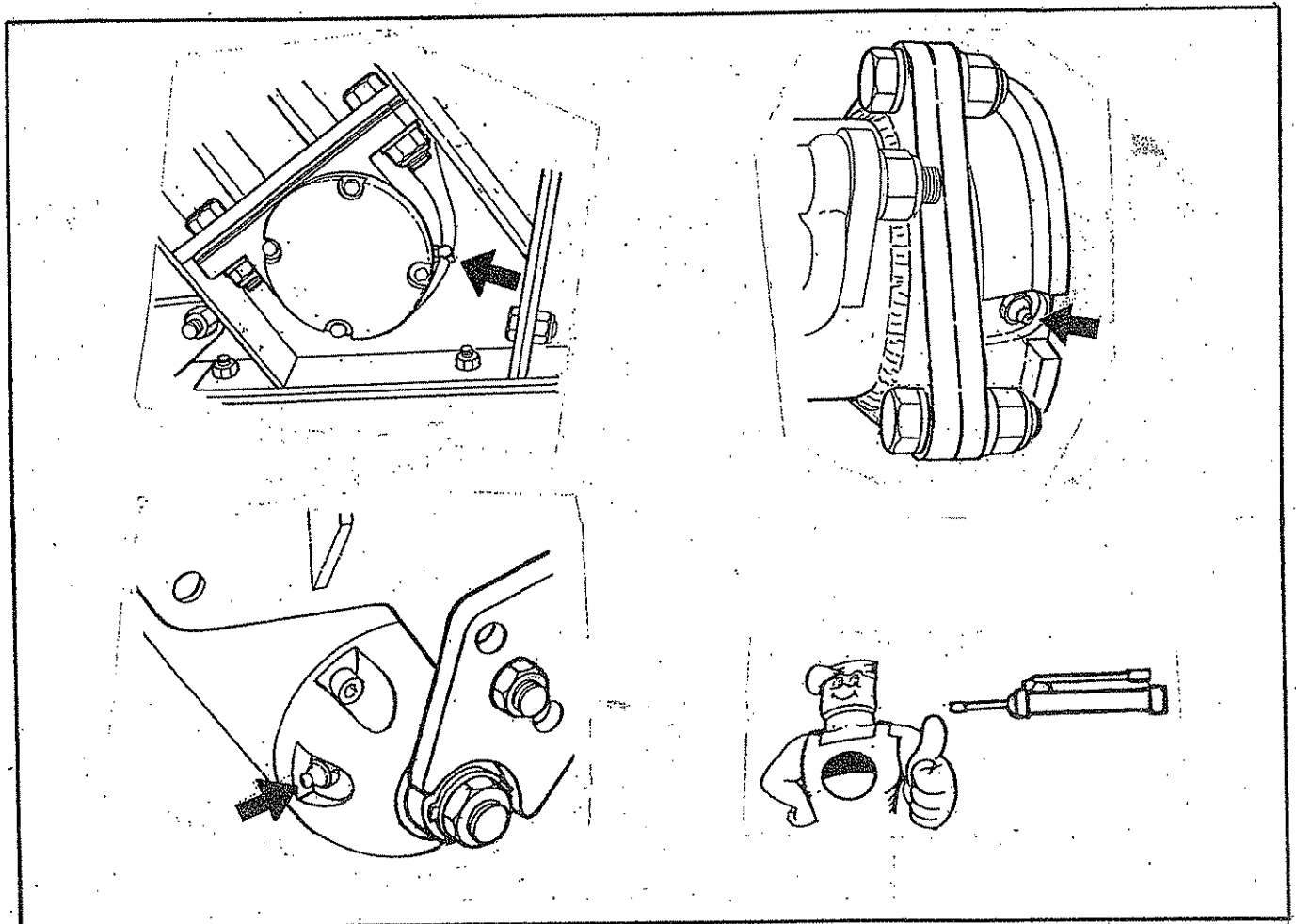

FOR NOTES



## McConnel Generic Parts Manual

*Generic parts manuals should be used as a general guide to the components used on the machine; to ensure accurate parts information for a specific machine please refer to the 'Interactive Parts Database' on our website which identifies the exact components used on the machine when it was manufactured based on the machine's unique serial number.*

*Direct access can be gained using the web address or QR code below.*  
<http://www.mcconnel.com/support/product-support/interactive-parts-database/>

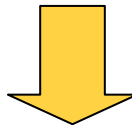

*Design improvements may have altered some of the parts listed in this manual; latest parts will always be supplied if they are interchangeable with earlier ones.*

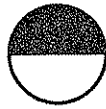

WEGMANN

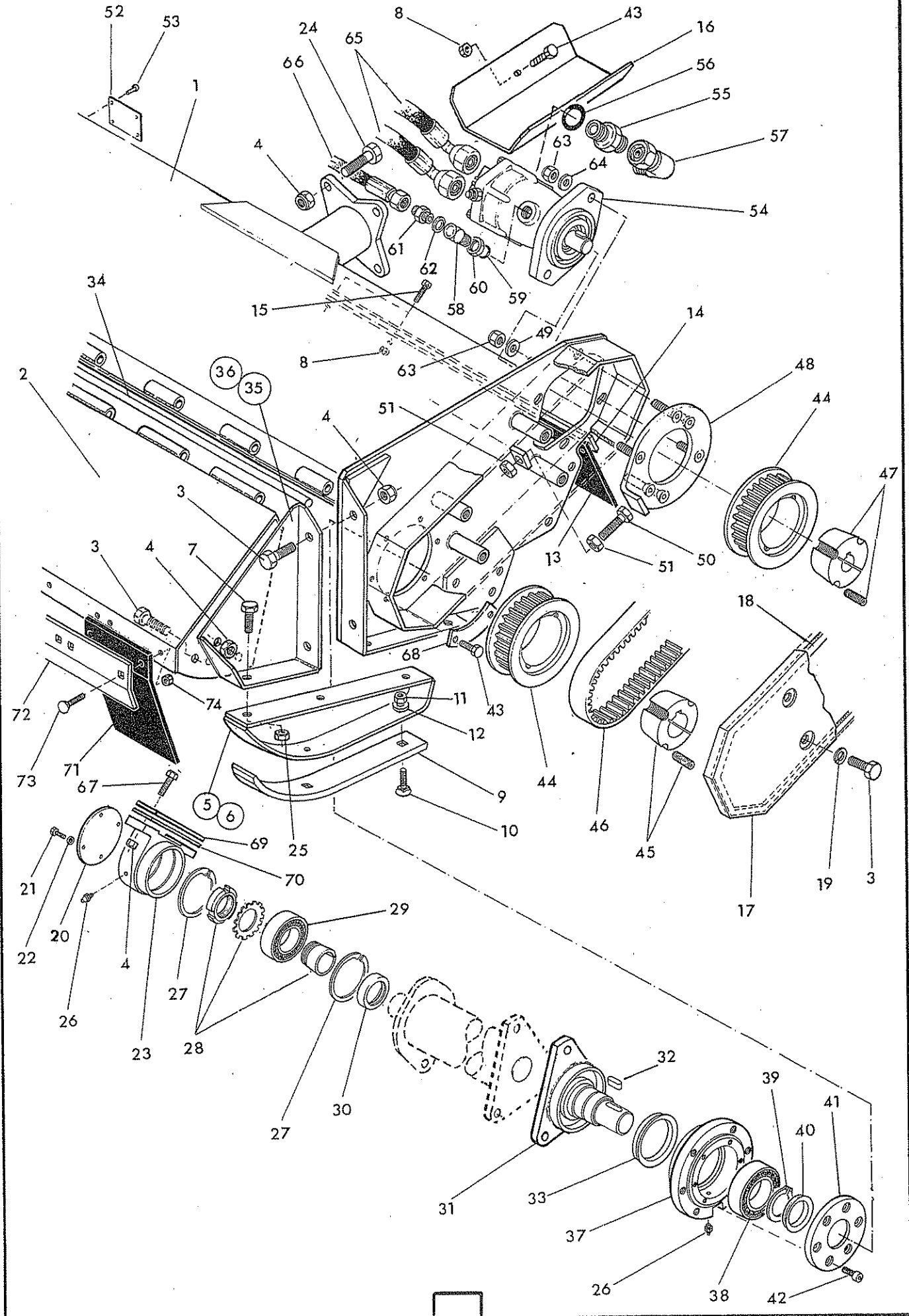

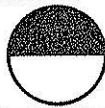

Ref.	Part No.	Qty.	Description
<b>FLAIL HEAD CASING</b>			
1	72 90 352	1	Hood L.Hand
	72 90 333	1	Hood R.Hand
2	72 90 386	1	Front hood
3	12.714.35	10	Special bolt M16 x1.5p x 35 long
4	91 00 028	16	Special self locking nut M16 x 1.5p
5	72 90 389	1	Skid R.Hand – not illustrated
6	72 90 360	1	Skid L.Hand
7	03 11 085	6	Setscrew 1/2"UNF 1 1/4" long
8	91 43 005	17	Self locking nut M10
9	72 90 391	2	Wear skid
10	60 12 034	6	Tine bolt 7/16" UNC
11	01 42 004	6	Self locking nut 7/16" UNC
12	01 00 104	6	Plain washer 7/16" dia
13	72 90 348	1	Rear flap
14	72 90 347	1	Clamp strip
15	93 13 065	9	Setscrew M10 x 30
16	71 98 333	1	Hose tray
17	72 90 343	1	Belt cover
18	72 90 052	1	Seal strip
19	01 00 206	4	Spring washer 5/8" dia
20	72 90 042	1	Bearing cover – free end
21	93 13 033	4	Setscrew M6 x 16
22	91 00 203	4	Spring washer dia 6
23	72 90 322	1	Bearing housing
24	92 00 031	4	Special bolt M16 x 1.5p x 60 long
25	01 40 005	6	Self lockig nut 1/2"UNF
26	09 01 121	2	Greaser 1/8" BSP straight
27	72 90 056	2	Internal circlip dia 110
28	06 00 097	1	Adaptor sleeve assembly
29	06 00 096	1	Bearing – free end
30	72 90 013	1	Bearing adaptor
31	43472.01	1	Drive hub
32	72 90 017	1	Key
33	72 90 048	1	Seal
34	72 90 061	1	Hood pivot rod
35	72 90 388	1	Hood bracket L.Hand
36	72 90 387	1	Hood bracket R.Hand – not illustrated
37	72 90 321	1	Bearing housing – drive end
38	06 00 095	1	Bearing – drive end
39	04 01 255	1	External circlip dia 55
40	72 90 049	1	Seal
41	72 90 023	1	Bearing retainer
42	93 43 034	6	Capscrew M8 x 16
43	93 13 045	8	Setscrew M10 x 20
44	72 90 047	2	Drive sprocket
45	72 90 016	1	Taper lock drive bush dia 40



CASING - Continued

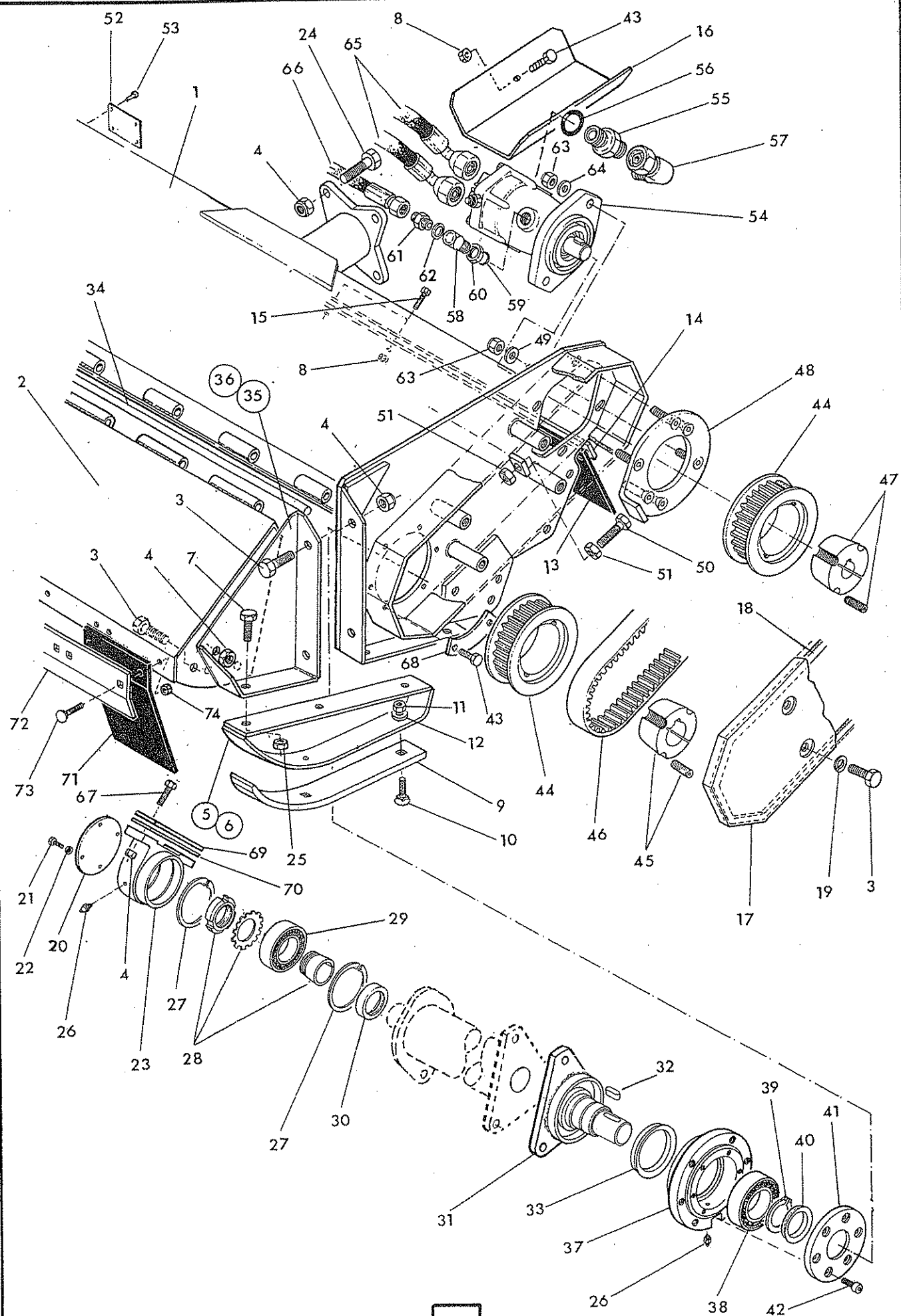
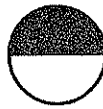

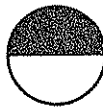

Ref.	Part No.	Qty.	Description
<b>FLAIL HEAD CASING :-continued</b>			
46	72 90 046	1	Belt
47	72 90 045	1	Taper lock drive bush 1 1/8" dia
48	43458.01	1	Motor mounting plate L.Hand
	43458.02	1	Motor mounting plate R.Hand – not illustrated
49	72 90 051	4	Special washer
50	93 13 177	1	Belt adjuster screw M16 x 55
51	91 13 007	2	Hexagon nut M16
52	13 35 246	1	Serial No. plate
53	70 03 230	4	Pop rivet 1/8" dia
54	83 01 295	1	Hydraulic motor
55	85 81 375	2	Adaptor 1 5/16" J.I.C. – M36
56	86 00 916	2	O ring
57	85 81 376	2	Swivel elbow M36 MF
58	42739.01	1	Adaptor elbow 3/4" J.I.C. M – 3/8" BSP F
59	86 00 908	1	O ring
60	01 51 007	1	Thin hexagon nut 3/4" UNF
61	85 81 406	1	Adaptor 3/8" BSP – M26 MM including seal
62	86 50 403	1	Seal
63	91 43 006	6	Self locking nut M12
64	91 13 006	2	Plain washer dia 12
65	43054.14	2	Hose M36 x 700 long
66	42726.18	1	Hose M26 x 900 long
67	92 00 023	2	Special bolt M16 x 1.5p x 65
68	72 90 073	3	Tab washer dia 10
69	72 90 425	as reqd	Shim 3.0mm
70	72 90 424	as reqd	Shim 2.0mm
	<b>72 90 375</b>		<b>FRONT FLAP KIT</b>
71	72 90 053	8	Flap
72	71 90 304	1	Flap clamp strip
73	92 93 054	16	Cup square bolt M8 x 25
74	91 43 004	16	Self locking nut M8.

ROTOR & FLAILS

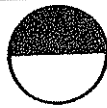

McCOMB

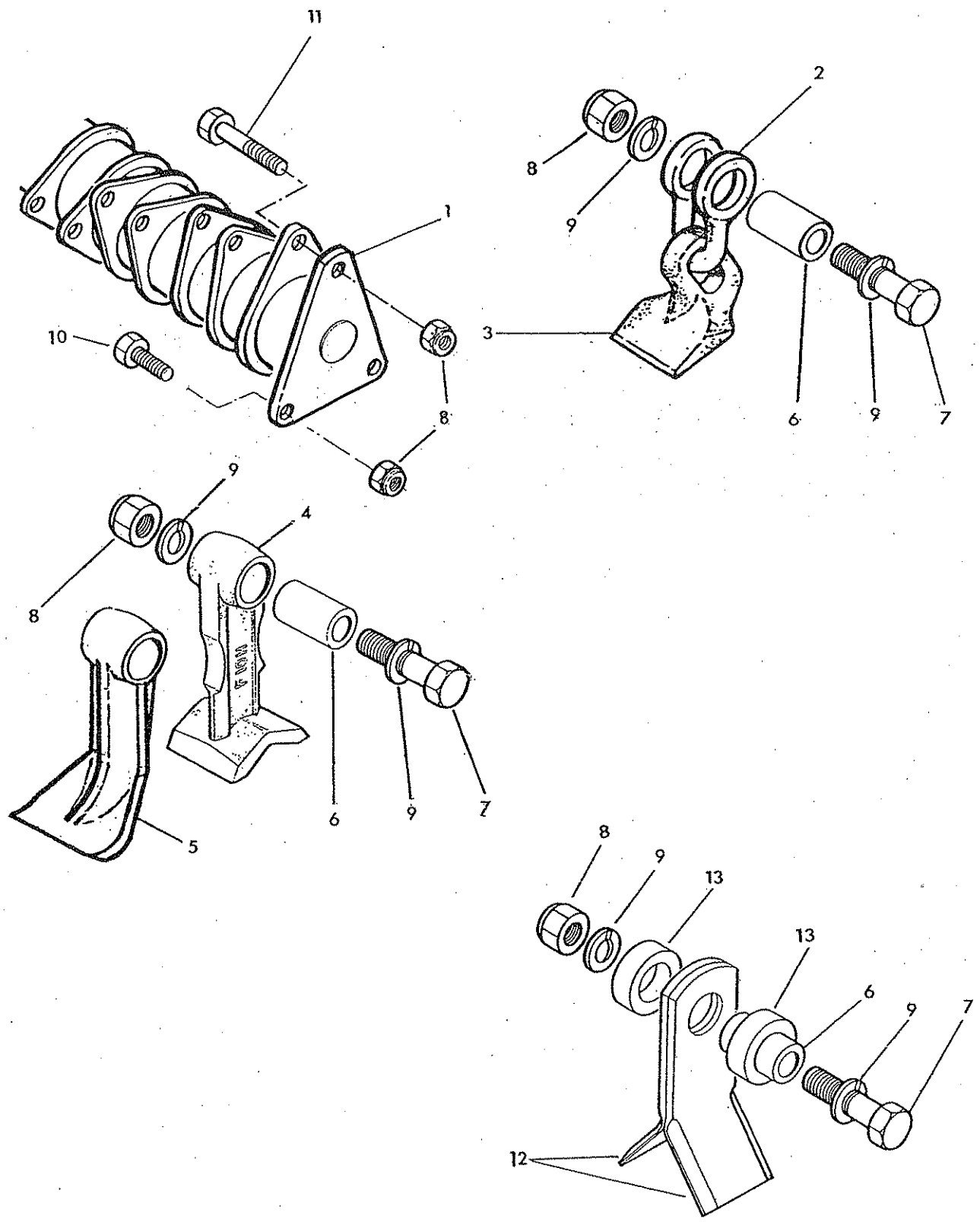

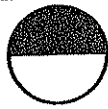

Ref	Part No.	Qty.	Description
<b>ROTOR AND FLAILS</b>			
1	43391.01	1	Rotor
2	71 90 106	24	Shackle
3	71 90 462	24	Flail
4	73 14 366	24	Flail F10H - cast
	41391.01	24	Flail F10H - forged
5	73 90 276	24	Flail - alternative single edged
6	73 14 223	24	Pivot bush
7	73 90 025	23	Special bolt M16 x 1.5p x 83 long
8	91 00 028	26	Special self locking nut M16 x 1.5p
9	01 00 206	48	Spring washer 5/8" dia
10	92 00 028	2	Special bolt M16 x 1.5p x 45 long
11	73 90 026	1	Special bolt M16 x 1.5p x 95 long
12	71 90 315	48	Flail
13	71 90 010	48	Spacer

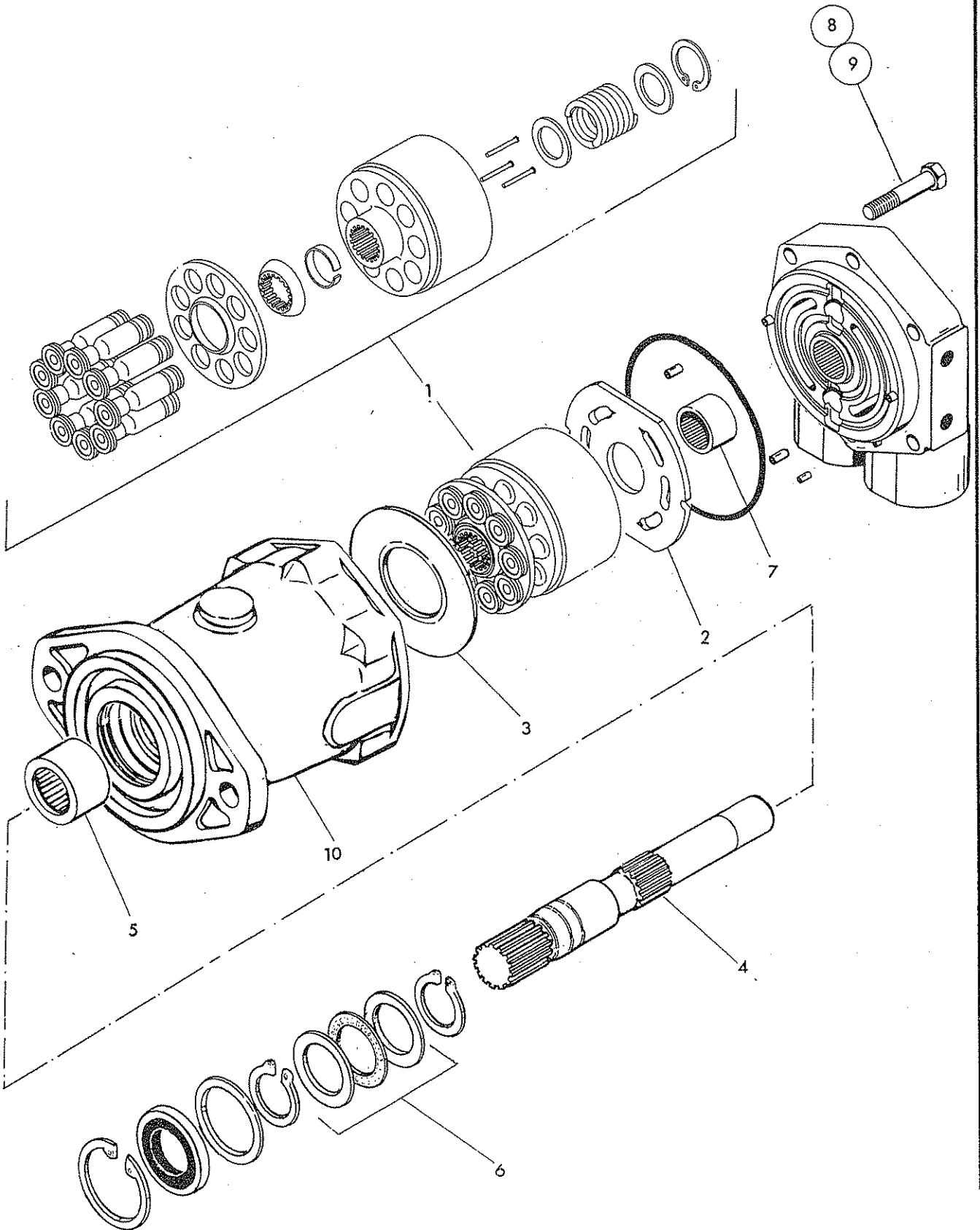
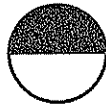

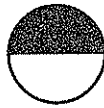

Ref	Part No.	Qty.	Description
	<b>83 01 290</b>		<b>MOTOR ASSEMBLY</b>
1	83 01 035	1	Rotating kit assembly
2	83 01 036	1	Valve plate
3	83 01 037	1	Cam plate
4	83 01 046	1	Shaft
5	83 01 038	1	Needle bearing
6	83 01 039	1	Thrust bearing
7	83 01 040	1	Needle bearing
8	02 12 142	3	Bolt 5/16" UNC x 1 3/4" long
9	02 12 202	3	Bolt 5/16" UNC x 2 1/2" long
10	83 01 048	1	Housing
	<b>86 99 238</b>		<b>SEAL KIT</b>

**SERVICE NOTE**

To safeguard warranty rights during the warranty period the motor **must not** be dismantled prior to examination by McConnel engineers.

Subsequently, when servicing, always be aware that piston motors are manufactured to very fine tolerances and any **service work must** be carried out by **qualified** specialist technicians working in a **clean dust free environment**.

If in **any doubt** contact McConnel service department for advice.

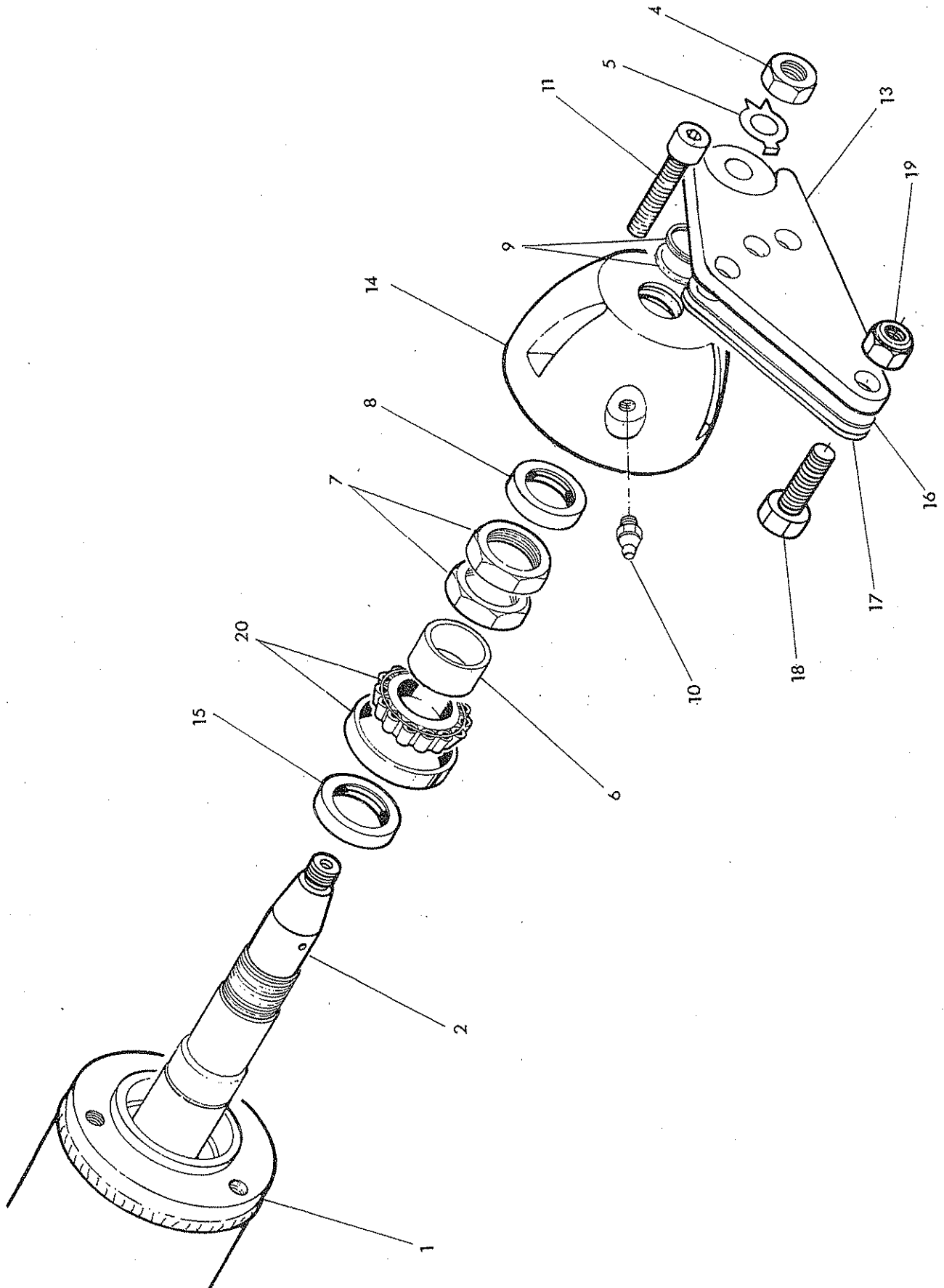
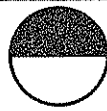

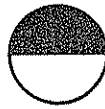

Ref.	Part No.	Qty.	Description
	<b>42241.26</b>		<b>ROLLER ASSEMBLY</b>
1	42241.01	1	Roller
	42242.14	1	Axle assembly including :-
2	42244.01	1	Axle
3	91 13 008	1	Plain nut M20 R.Hand – not illustrated
4	91 00 026	1	Plain nut M20 L.Hand
5	71 90 023	2	Tab washer
6	42245.01	2	Spacer
7	42244.01	4	Locknut
8	86 29 125	2	Seal
9	04 12 120	4	Spirolox ring
10	09 01 121	2	Greaser 1/8" BSP straight
11	93 43 075	6	Capscrew M10 x 35
12	42246.02	1	Roller bracket R.Hand – not illustrated
13	42246.01	1	Roller bracket L.Hand
14	42243.01	2	End cap
15	86 29 213	2	Seal
16	42257.01	as reqd.	Shim
17	42257.02	as reqd.	Shim
18	91 13 107	4	Setscrew M16 x 50
19	91 43 007	4	Self locking nut M16
20	06 00 105	2	Taper roller bearing



1.2m Multicut Head



# ROLLER ASSEMBLY

Module:  
21394.25

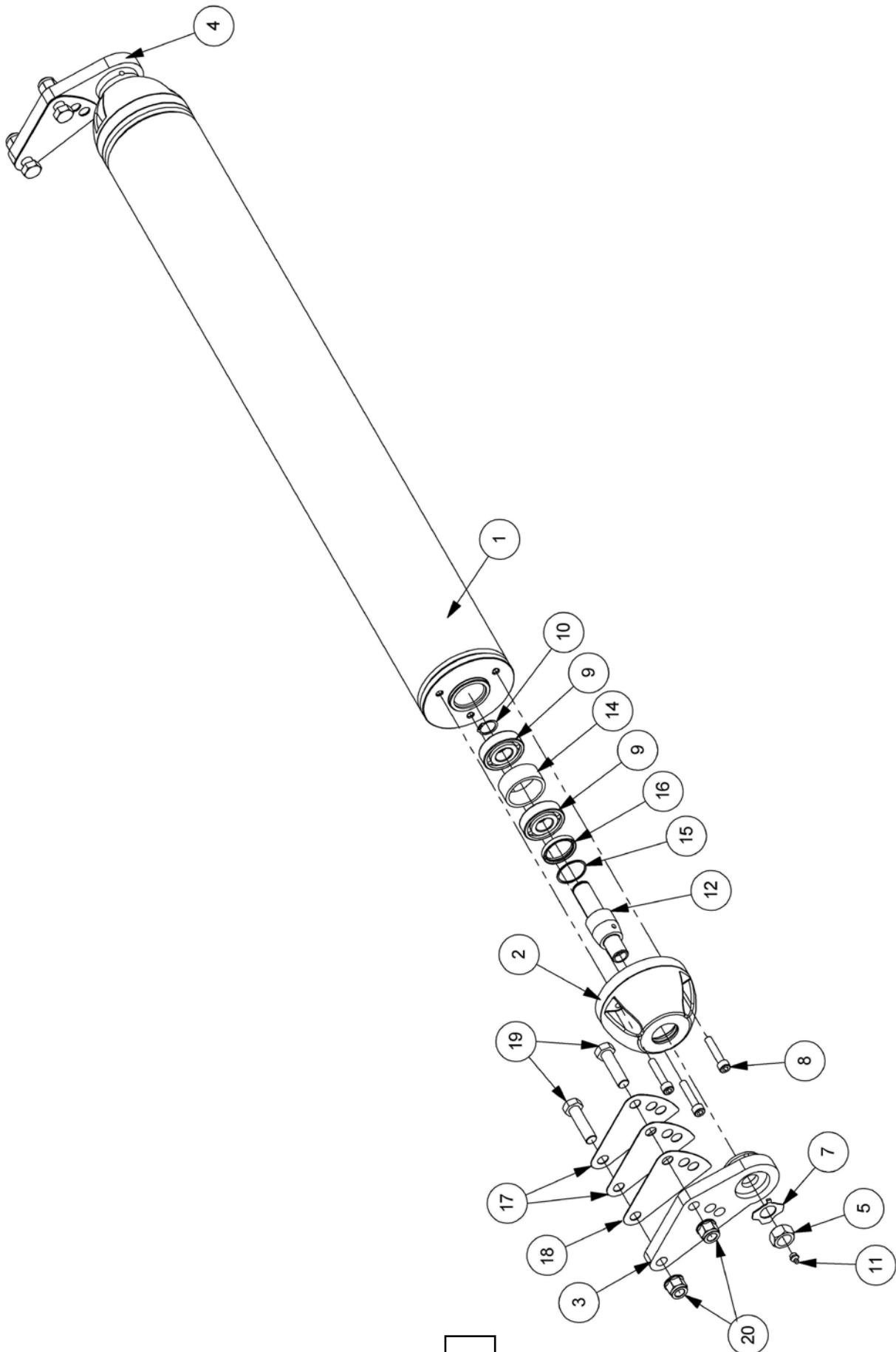

**ROLLER ASSEMBLY**

REF.	QTY.	PART No.	DESCRIPTION
		<b>21394.25</b>	<b>ROLLER ASSEMBLY</b>
1	1	21394.01	ROLLER
2	2	21394.32	ROLLER END CAP
3	1	21395.01	ROLLER BRACKET - L/H
4	1	21395.02	ROLLER BRACKET - R/H
5	1	9100035	NUT
6	1	9100036	NUT
7	2	21395.03	TAB WASHER
8	6	9343105	CAPSCREW
9	4	0600107	BEARING
10	2	0401225	CIRCLIP - EXTERNAL
11	2	0901121	GREASE NIPPLE
12	1	21394.33	ROLLER STUB AXLE - L/H THREAD
13	1	21394.34	ROLLER STUB AXLE - R/H THREAD
14	2	7190082	BEARING SPACER
15	2	0402240	SPIROLOX EXTERNAL RING
16	2	8629239	ROTARY SHAFT SEAL
17	4	42257.01	ROLLER SHIM - 1.2mm
18	2	42257.02	ROLLER SHIM - 2.0mm
19	4	9200031	BOLT
20	4	9100024	SELF-LOCKING FLANGE NUT
		<b>21394.05</b>	<b>ROLLER END KIT</b>



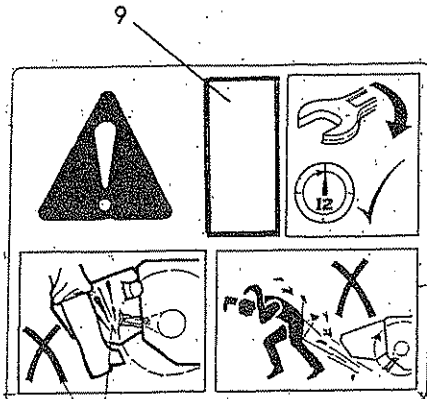
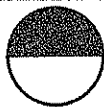

### FLAIL PARTS INFORMATION

McCormel Flail Mowers use dynamically balanced and mated system components for Cutter Shafts (Rotors), Knives (Flails), Knife Hangers (Shackles), Bolts, Bushes, Rollers, Drivetrain Components, Bearings Belts and Belt Pulleys. McCormel parts are made and tested to meet close-tolerance specifications of balance, quality and consistency that assure long, trouble-free service. "Will-Fit" parts do not ordinarily meet McCormel Standards and could reduce Mower performance, void warranties, and present an increase in the safety hazard potential.

**DON'T GAMBLE!**  
USE GENUINE McCORMEL SERVICE PARTS  
See your McCormel dealer.

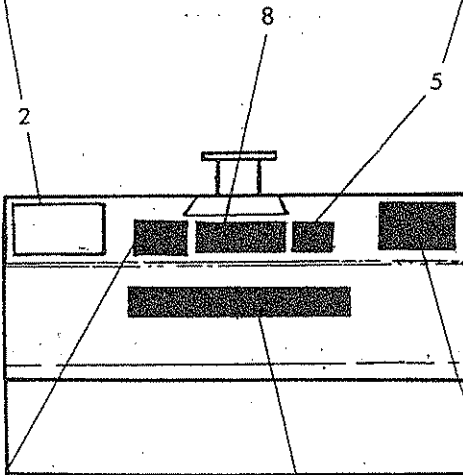
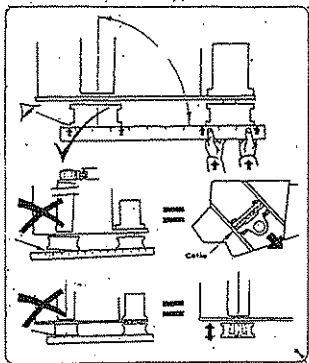
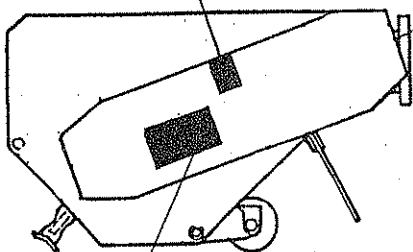
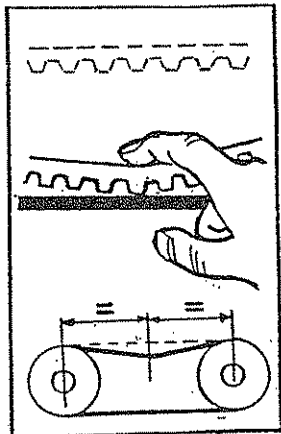

# McCORMEL

**! DANGER**

CUTTING BLADES

THROWN OBJECTS



FLAIL



ROTARY



FLAIL

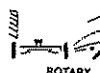

ROTARY

**KEEP AWAY - ROTATING BLADES**

SERIOUS INJURY OR DEATH CAN RESULT  
FROM THROWN OBJECTS OR BLADE CONTACT.

- ✘ STOP MOWING IF PERSONS ARE NOT CLEAR OF THROWN OBJECTS
- ✘ DO NOT STAND ON OR NEAR MACHINE WHEN IN OPERATION
- ✘ DO NOT OPERATE WITH DEFLECTORS OR GUARDS REMOVED

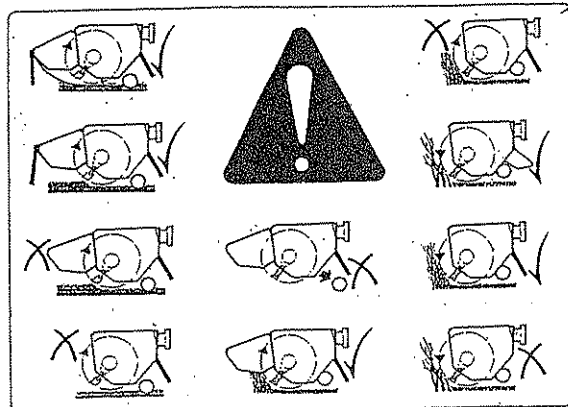

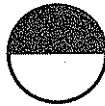

Ref.	Part No.	Qty.	Description
<b>STICKERS</b>			
1	12 90 255	1	McConnel
2	12 90 462	1	Flail head instructions
3	12 90 341	1	Flail head guarding
4	0075 6485	1	Rotating blade warning
5	12 90 392	1	Use McConnell spares
6	12 90 478	1	Belt pulley alignment
7	12 90 065	1	Belt tension
8	71 14 481	1	Bolt instructions
9	12 90 086	1	800 R.p.m. overlay





McConnel Limited, Temeside Works, Ludlow, Shropshire SY8 1JL. England.  
Telephone: 01584 873131. Facsimile: 01584 876463. [www.mcconnel.com](http://www.mcconnel.com)